

| CURRENT OWNER | | TOPO | UTILITIES | STRT / ROAD | LOCATION | CURRENT ASSESSMENT | | | | 801 FY2024 BARNSTABLE, MA VISION |
|--|--|---------|----------------|--|----------|--------------------|------|----------|----------|--|
| LITHWIN, ROYA & WENDY M 242 WINDING COVE ROAD MARSTONS MIL MA 02648 | | 1 Level | 2 Public Water | 1 Paved | | Description | Code | Assessed | Assessed | |
| | | | 4 Gas | | | RESIDNTL | 1010 | 365,500 | 365,500 | |
| | | | 6 Septic | | | RES LAND | 1010 | 221,200 | 221,200 | |
| SUPPLEMENTAL DATA | | | | | | Total | | 586,700 | 586,700 | |
| Alt Prcl ID Split Zonin BID Parcel ResExpt Q YES: #DL 1 LOT 29 #DL 2 GIS ID F_951991_2696940 | | | | Plan Ref. 272/29-30 (F3) Land Ct# #SR Life Estate PP STATU Assoc Pid# | | | | | | |

| RECORD OF OWNERSHIP | | BK-VOL/PAGE | SALE DATE | Q/U | V/I | SALE PRIC | VC | PREVIOUS ASSESSMENTS (HISTORY) | | | | | | | | | |
|-------------------------|-------|-------------|------------|-----|-----|-----------|----|--------------------------------|------|----------|------|---------|----------|-------|------|----------|--|
| LITHWIN, ROYA & WENDY M | 23978 | 0161 | 08-20-2009 | Q | I | 333,000 | 00 | Year | Code | Assessed | Year | Code | Assessed | Year | Code | Assessed | |
| ELLSWORTH, CAMILLA C | 8071 | 0130 | 06-17-1992 | U | I | 170,000 | D | 2023 | 1010 | 324,600 | 2022 | 1010 | 273,100 | 2021 | 1010 | 228,500 | |
| ROEMER, HELENA | 4324 | 0221 | 11-20-1984 | Q | V | 35,000 | U | | 1010 | 201,100 | | 1010 | 138,300 | | 1010 | 140,400 | |
| WELLINGTON, ROGER U | 4065 | 0184 | 04-12-1984 | U | V | 26,000 | R | | | | | | | | | | |
| SHAHROOZI, MOSTAFA | 3746 | 0277 | 05-20-1983 | U | | 0 | | | | | | | | | | | |
| Total | | | | | | | | 525,700 | | Total | | 411,400 | | Total | | 376,500 | |

| EXEMPTIONS | | | | OTHER ASSESSMENTS | | | | This signature acknowledges a visit by a Data Collector or Assessor | | | | | | | | |
|------------|------|-----------------------|--------|-------------------|-------------|--------|--------|---|--|--|--|--|--|--|--|--|
| Year | Code | Description | Amount | Code | Description | Number | Amount | Comm Int | | | | | | | | |
| 2020 | 5C | RESIDENTIAL EXEMPTION | 0.00 | | | | | | | | | | | | | |
| Total | | | 0.00 | | | | | | | | | | | | | |

| ASSESSING NEIGHBORHOOD | | | | APPRAISED VALUE SUMMARY | | | |
|------------------------|-----------|---|---------|-------------------------|-------------------------------|---------|--|
| Nbhd | Nbhd Name | B | Tracing | Batch | | | |
| 0108 | | | | MARSTM | Appraised Bldg. Value (Card) | 323,600 | |
| | | | | | Appraised Xf (B) Value (Bldg) | 34,300 | |
| | | | | | Appraised Ob (B) Value (Bldg) | 7,600 | |
| | | | | | Appraised Land Value (Bldg) | 221,200 | |
| | | | | | Special Land Value | 0 | |
| | | | | | Total Appraised Parcel Value | 586,700 | |
| | | | | | Valuation Method | C | |
| | | | | | Total Appraised Parcel Value | 586,700 | |

| NOTES | | | | | | | | VISIT / CHANGE HISTORY | | | | | | | |
|-------|--|--|--|--|--|--|--|------------------------|----|------|----|----|----------------------------|--|--|
| | | | | | | | | Date | Id | Type | Is | Cd | Purpost/Result | | |
| | | | | | | | | 06-01-2020 | DM | | | FR | Field Review | | |
| | | | | | | | | 05-22-2020 | PK | 03 | | 16 | In Office Review | | |
| | | | | | | | | 12-21-2015 | SR | 01 | | 02 | Bldg Permit Completed | | |
| | | | | | | | | 01-09-2014 | NF | 03 | | 16 | In Office Review | | |
| | | | | | | | | 12-22-2009 | TR | 03 | | 16 | In Office Review | | |
| | | | | | | | | 10-05-2005 | PT | 02 | | 01 | Meas/Est | | |
| | | | | | | | | 05-08-1999 | FS | 01 | | 00 | Meas/Listed-Interior Acces | | |

| BUILDING PERMIT RECORD | | | | | | | | LAND LINE VALUATION SECTION | | | | | | | | |
|------------------------|------------|------|--------------|--------|------------|--------|------------|-----------------------------|------------|----|------|----|----|----------------------------|--|--|
| Permit Id | Issue Date | Type | Description | Amount | Insp Date | % Comp | Date Comp | Comments | Date | Id | Type | Is | Cd | Purpost/Result | | |
| 201503041 | 06-16-2015 | AD | Addition | 15,000 | 06-30-2015 | 100 | 06-30-2015 | 8X10 CLOSET WALK-IN FIRS | 06-01-2020 | DM | | | FR | Field Review | | |
| 201406298 | 09-23-2014 | IN | Insulation | 1,500 | 06-30-2015 | 100 | 06-30-2015 | IN - WEATHERIZATION & INS | 05-22-2020 | PK | 03 | | 16 | In Office Review | | |
| 201401933 | 04-07-2014 | IN | Insulation | 1,500 | 06-30-2014 | 100 | 06-30-2014 | IN ATTIC | 12-21-2015 | SR | 01 | | 02 | Bldg Permit Completed | | |
| 201309037 | 12-16-2013 | IN | Insulation | 1,009 | 06-30-2014 | 100 | 06-30-2014 | INSULATE-WEATHERIZE | 01-09-2014 | NF | 03 | | 16 | In Office Review | | |
| 200904742 | 10-02-2009 | OB | Out Building | 0 | 10-09-2015 | 100 | 06-30-2016 | 10 X 12 SHED | 12-22-2009 | TR | 03 | | 16 | In Office Review | | |
| B27398 | 01-02-1985 | DW | Dwelling | 60,000 | 01-15-1986 | 100 | 12-31-1986 | MM | 10-05-2005 | PT | 02 | | 01 | Meas/Est | | |
| B27398A | 01-01-1985 | DW | Dwelling | 60,000 | 01-15-1986 | 100 | 12-31-1986 | MM 11/2 S | 05-08-1999 | FS | 01 | | 00 | Meas/Listed-Interior Acces | | |

| B | Use Code | Description | Zone | LA | Land Units | Unit Price | Size Adj | AC Disc | Site Index | Cond. | Nbhd. | Nbhd. Adj | Notes | Location Adjustmen | Adj Unit P | Land Value | |
|-----------------------|----------|----------------|------|----|------------|------------|------------------------|---------|------------|-------|-------|-----------|------------------|--------------------|------------|------------|---------|
| 1 | 1010 | Single Fam M-0 | RF | 3 | 0.510 | AC | 176,344.00 | 1.75655 | 1.0000 | 5 | 1.00 | 0107 | 1.400 | | 1.0000 | 433,665.1 | 221,200 |
| Total Card Land Units | | | | | 0.51 | AC | Parcel Total Land Area | | | | | 0.51 | Total Land Value | | | 221,200 | |

| CONSTRUCTION DETAIL | | | CONSTRUCTION DETAIL (CONTINUED) | | |
|---------------------|-----|----------------|---------------------------------|----|-------------|
| Element | Cd | Description | Element | Cd | Description |
| Style | 04 | Cape Cod | | | |
| Model | 01 | Residential | | | |
| Grade: | C | Average | | | |
| Stories | 1.5 | 1 1/2 Stories | | | |
| Exterior Wall 1 | 14 | Wood Shingle | | | |
| Exterior Wall 2 | 11 | Clapboard | | | |
| Roof Structure | 03 | Gable/Hip | | | |
| Roof Cover | 03 | Asph/F Gls/Cmp | | | |
| Interior Wall 1 | 05 | Drywall | | | |
| Interior Wall 2 | | | | | |
| Interior Floor 1 | 14 | Carpet | | | |
| Interior Floor 2 | 09 | Pine/Soft Wood | | | |
| Heat Fuel | 03 | Gas | | | |
| Heat Type | 04 | Hot Air | | | |
| AC Type | 03 | Central | | | |
| Bedrooms | 02 | 2 Bedrooms | | | |
| Full Baths | 2 | | | | |
| Half Baths | 0 | | | | |
| Extra Fixtures | | | | | |
| Total Rooms | 5 | | | | |
| Bath Style | | | | | |
| Kitchen Style | | | | | |
| Occupancy | | | | | |
| Usrflid 105 | | | | | |
| Accessory Apt | | | | | |
| Foundation Alt | 01 | Poured Conc. | | | |
| Rms Prts | | | | | |
| Bath Split | 20 | 2 Full-0 Half | | | |

| CONDO DATA | | | |
|-------------|------|-------------|----------|
| Parcel Id | | C | Owne 0.0 |
| Adjust Type | Code | Description | Factor% |
| Condo Flr | | | |
| Condo Unit | | | |

| COST / MARKET VALUATION | |
|--------------------------|---------|
| Building Value New | 385,248 |
| Year Built | 1985 |
| Effective Year Built | 1998 |
| Depreciation Code | A |
| Remodel Rating | |
| Year Remodeled | |
| Depreciation % | 16 |
| Functional Obsol | 0 |
| External Obsol | 0 |
| Trend Factor | 1 |
| Condition | |
| Condition % | |
| Percent Good | 84 |
| RCNLD | 323,600 |
| Dep % Ovr | |
| Dep Ovr Comment | |
| Misc Imp Ovr | |
| Misc Imp Ovr Comment | |
| Cost to Cure Ovr | |
| Cost to Cure Ovr Comment | |

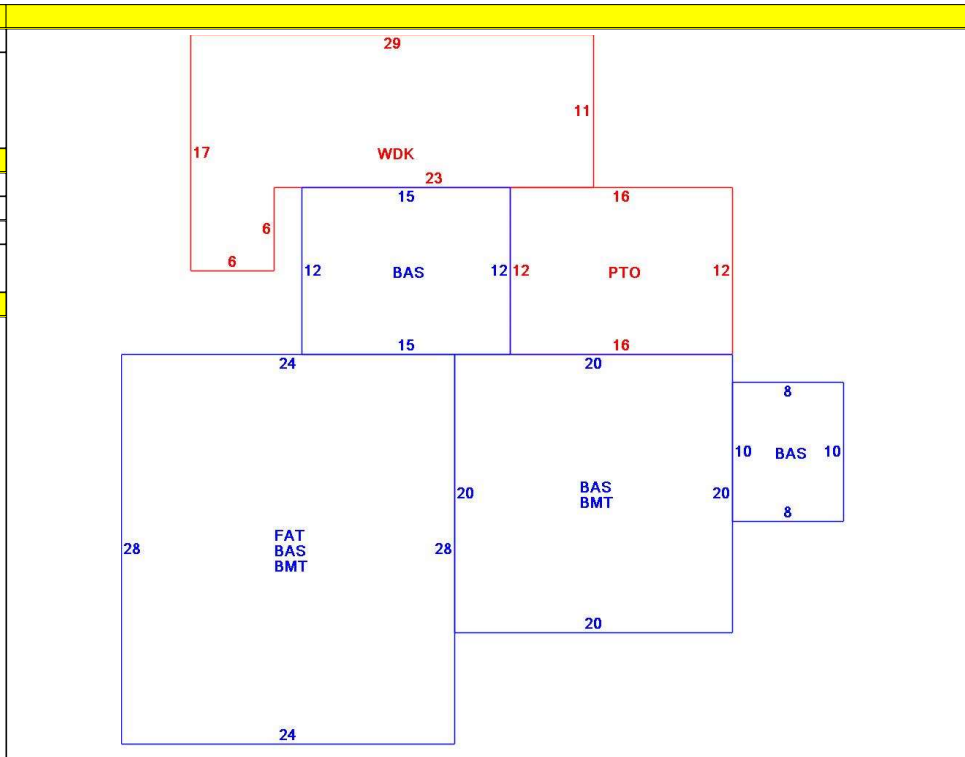

| OB - OUTBUILDING & YARD ITEMS(L) / XF - BUILDING EXTRA FEATURES(B) | | | | | | | | | | |
|--|-----------------|-----|-------|------------|--------|----------|------|-------|------------|-------------|
| Code | Description | L/B | Units | Unit Price | Yr Blt | Cond. Cd | % Gd | Grade | Grade Adj. | Appr. Value |
| FPL2 | Fireplace 1.5 s | B | 1 | 6000.00 | 2000 | | 84 | | 0.00 | 5,000 |
| FPO | Ext FP Openin | B | 1 | 2000.00 | 2000 | | 84 | | 0.00 | 1,700 |
| WDC | Wood Decking | L | 355 | 20.00 | 1999 | | 60 | | 0.00 | 4,200 |
| PAT2 | Patio-Good | L | 192 | 9.94 | 1999 | | 80 | | 0.00 | 1,700 |
| BMT | Basement-Unfi | B | 1,072 | 26.01 | 2000 | | 84 | | 0.00 | 23,400 |
| SHED | Shed | L | 120 | 18.00 | 2009 | | 80 | | 0.00 | 1,700 |
| FPLG | Gas Fireplace- | B | 2 | 2500.00 | 2000 | | 84 | | 0.00 | 4,200 |

| BUILDING SUB-AREA SUMMARY SECTION | | | | | | |
|-----------------------------------|-----------------|-------------|------------|----------|-----------|----------------|
| Code | Description | Living Area | Floor Area | Eff Area | Unit Cost | Undeprec Value |
| BAS | First Floor | 1,332 | 1,332 | 1,332 | 268.84 | 358,095 |
| BMT | Basement Area | 0 | 1,072 | 0 | 0.00 | 0 |
| FAT | Attic, Finished | 101 | 672 | 101 | 40.41 | 27,153 |
| PTO | Patio | 0 | 192 | 0 | 0.00 | 0 |
| WDK | Wood Deck | 0 | 355 | 0 | 0.00 | 0 |
| Ttl Gross Liv / Lease Area | | 1,433 | 3,623 | 1,433 | | 385,248 |

