

| CURRENT OWNER  |                  |            |  | TOPO                     | UTILITIES   | STRT / ROAD | LOCATION  | CURRENT ASSESSMENT |           |           |           |                                 |           |
|--|------------------|------------|--|--------------------------|-------------|-------------|-----------|--------------------|-----------|-----------|-----------|---------------------------------|-----------|
| 125 NORTH BAY ROAD LLC<br>C/O K WALLACE, RINET CO LLC<br>PO BOX 5307 |                  |            |  |                          |             |             |           | Description        | Code      | Assessed  | Assessed  | 801<br>FY2024<br>BARNSTABLE, MA |           |
|  |                  |            |  |                          |             |             |           | RESIDNTL           | 1010      | 2,585,000 | 2,585,000 |                                 |           |
| SARASOTA FL 34277  |                  |            |  | <b>SUPPLEMENTAL DATA</b> |             |             |           | RES LAND           | 1010      | 1,734,000 | 1,734,000 | <b>VISION</b>                   |           |
|  |                  |            |  | Alt Prcl ID              | Split Zonin | BID Parcel  | ResExpt Q | #DL 1              | LOT 204   | Plan Ref. | Land Ct#  |                                 | 15354-128 |
| GIS ID   | F_953853_2690609 | Assoc Pid# |  |                          |             |             |           |                    |           |           |           |                                 |           |
| Total  |                  |            |  |                          |             |             |           |                    | 4,319,000 | 4,319,000 |           |                                 |           |

| RECORD OF OWNERSHIP         |         | BK-VOL/PAGE | SALE DATE  | Q/U | V/I | SALE PRIC | VC | PREVIOUS ASSESSMENTS (HISTORY) |      |           |      |      |           |      |      |           |           |       |           |       |           |
|-----------------------------|---------|-------------|------------|-----|-----|-----------|----|--------------------------------|------|-----------|------|------|-----------|------|------|-----------|-----------|-------|-----------|-------|-----------|
| 125 NORTH BAY ROAD LLC      | C204213 | 0           | 08-19-2014 | U   | I   | 1         | 1F | Year                           | Code | Assessed  | Year | Code | Assessed  | Year | Code | Assessed  |           |       |           |       |           |
| THERRIEN, ROBERT J & MARY E | C139371 | 0           | 12-15-1995 | Q   | I   | 400,000   | U  | 2023                           | 1010 | 2,330,000 | 2022 | 1010 | 1,972,900 | 2021 | 1010 | 1,684,500 |           |       |           |       |           |
| JOHNSON, RICHARD P & MARTHA | C119556 | 0           | 01-15-1990 | U   | V   | 550,000   | N  |                                | 1010 | 1,366,900 |      | 1010 | 1,030,000 |      | 1010 | 1,060,300 |           |       |           |       |           |
| CAVANAGH, CARROLL J         | C118023 | 0           | 07-15-1989 | Q   | V   | 1         | U  |                                |      |           |      |      |           |      | 1010 | 32,100    |           |       |           |       |           |
| MELLON, PAUL                | C109139 | 0           | 12-15-1986 | U   | V   | 1         | B  | Total                          |      |           |      |      |           |      |      |           | 3,696,900 | Total | 3,002,900 | Total | 2,776,900 |

| EXEMPTIONS |      |             |        | OTHER ASSESSMENTS |             |        |        | This signature acknowledges a visit by a Data Collector or Assessor |  |  |  |  |  |  |  |  |  |  |
|------------|------|-------------|--------|-------------------|-------------|--------|--------|---|--|--|--|--|--|--|--|--|--|--|
| Year       | Code | Description | Amount | Code              | Description | Number | Amount | Comm Int  |  |  |  |  |  |  |  |  |  |  |
|            |      |             |        |                   |             |        |        |   |  |  |  |  |  |  |  |  |  |  |
| Total      |      |             | 0.00   |                   |             |        |        |   |  |  |  |  |  |  |  |  |  |  |

| ASSESSING NEIGHBORHOOD |           |   |         | APPRAISED VALUE SUMMARY       |           |  |  |  |  |
|------------------------|-----------|---|---------|-------------------------------|-----------|--|--|--|--|
| Nbhd                   | Nbhd Name | B | Tracing | Batch                         |           |  |  |  |  |
| 0117                   |           |   | OSTVIL  |                               |           |  |  |  |  |
| NOTES                  |           |   |         | Appraised Bldg. Value (Card)  | 2,218,500 |  |  |  |  |
|                        |           |   |         | Appraised Xf (B) Value (Bldg) | 334,400   |  |  |  |  |
|                        |           |   |         | Appraised Ob (B) Value (Bldg) | 32,100    |  |  |  |  |
|                        |           |   |         | Appraised Land Value (Bldg)   | 1,734,000 |  |  |  |  |
|                        |           |   |         | Special Land Value            | 0         |  |  |  |  |
|                        |           |   |         | Total Appraised Parcel Value  | 4,319,000 |  |  |  |  |
|                        |           |   |         | Valuation Method              | C         |  |  |  |  |
|                        |           |   |         | Total Appraised Parcel Value  | 4,319,000 |  |  |  |  |

| BUILDING PERMIT RECORD |            |      |             |         |            |        |            |           | VISIT / CHANGE HISTORY |    |      |    |    |                   |
|------------------------|------------|------|-------------|---------|------------|--------|------------|-----------|------------------------|----|------|----|----|-------------------|
| Permit Id              | Issue Date | Type | Description | Amount  | Insp Date  | % Comp | Date Comp  | Comments  | Date                   | Id | Type | Is | Cd | Purpost/Result    |
| 30432                  | 04-24-1998 | DW   | Dwelling    | 700,000 | 01-01-2000 | 100    | 12-31-2000 | OS 2 STOR | 06-12-2020             | WD |      |    | 25 | NO TRESPASSING    |
| 12531                  | 12-01-1995 | DW   | Dwelling    | 700,000 | 01-15-1996 | 100    | 12-31-1996 |           | 07-03-2017             | TR | 22   |    | 22 | Change of Address |
|                        |            |      |             |         |            |        |            |           | 05-24-2017             | JR | 03   |    | 17 | ATB Review        |
|                        |            |      |             |         |            |        |            |           | 08-11-2016             | SR | 02   |    | 03 | Cycl Insp Comp    |
|                        |            |      |             |         |            |        |            |           | 06-15-2016             | JR | 03   |    | 16 | In Office Review  |
|                        |            |      |             |         |            |        |            |           | 05-21-2015             | JR | 03   |    | 03 | Cycl Insp Comp    |
|                        |            |      |             |         |            |        |            |           | 07-11-2012             | NF | 03   |    | 16 | In Office Review  |

| LAND LINE VALUATION SECTION |          |                |      |    |            |               |                        |         |            |       |       |           |                  |                    |            |            |
|-----------------------------|----------|----------------|------|----|------------|---------------|------------------------|---------|------------|-------|-------|-----------|------------------|--------------------|------------|------------|
| B                           | Use Code | Description    | Zone | LA | Land Units | Unit Price    | Size Adj               | AC Disc | Site Index | Cond. | Nbhd. | Nbhd. Adj | Notes            | Location Adjustmen | Adj Unit P | Land Value |
| 1                           | 1010     | Single Fam M-0 | RF-1 | 3  | 1.000      | AC 176,344.00 | 1.00000                | 1.0000  | 5          | 1.00  | 0117  | 9.700     |                  | 1.0000             | 1,710,536  | 1,710,500  |
| 1                           | 1010     | Single Fam M-0 | RF-1 | 3  | 0.170      | AC 14,250.00  | 1.00000                | 1.0000  | 0          | 1.00  | 0117  | 9.700     |                  | 1.0000             | 138,225    | 23,500     |
| Total Card Land Units       |          |                |      |    | 1.17       | AC            | Parcel Total Land Area |         |            |       |       | 1.17      | Total Land Value |                    |            | 1,734,000  |

| CONSTRUCTION DETAIL |      |               | CONSTRUCTION DETAIL (CONTINUED)      |    |             |
|---------------------|------|---------------|--------------------------------------|----|-------------|
| Element             | Cd   | Description   | Element                              | Cd | Description |
| Style               | 04   | Cape Cod      |                                      |    |             |
| Model               | 01   | Residential   |                                      |    |             |
| Grade:              | A    | Luxury        |                                      |    |             |
| Stories             | 1.75 | 1 3/4 Stories |                                      |    |             |
| Exterior Wall 1     | 14   | Wood Shingle  |                                      |    |             |
| Exterior Wall 2     | 11   | Clapboard     |                                      |    |             |
| Roof Structure      | 03   | Gable/Hip     |                                      |    |             |
| Roof Cover          | 10   | Wood Shingle  |                                      |    |             |
| Interior Wall 1     | 03   | Plastered     |                                      |    |             |
| Interior Wall 2     |      |               |                                      |    |             |
| Interior Floor 1    | 12   | Hardwood      |                                      |    |             |
| Interior Floor 2    | 14   | Carpet        |                                      |    |             |
| Heat Fuel           | 02   | Oil           |                                      |    |             |
| Heat Type           | 04   | Hot Air       |                                      |    |             |
| AC Type             | 03   | Central       |                                      |    |             |
| Bedrooms            | 05   | 5 Bedrooms    |                                      |    |             |
| Full Baths          | 4    |               |                                      |    |             |
| Half Baths          | 1    |               |                                      |    |             |
| Extra Fixtures      |      |               |                                      |    |             |
| Total Rooms         | 13   | 13 Rooms      |                                      |    |             |
| Bath Style          | 02   | Average       |                                      |    |             |
| Kitchen Style       |      |               |                                      |    |             |
| Occupancy           |      |               |                                      |    |             |
| Usrflid 105         |      |               |                                      |    |             |
| Accessory Apt       |      |               |                                      |    |             |
| Foundation Alt      | 01   | Poured Conc.  |                                      |    |             |
| Rms Prts            |      |               |                                      |    |             |
| Bath Split          | 41   | 4 Full-1 Half |                                      |    |             |
|                     |      |               | <b>CONDO DATA</b>                    |    |             |
|                     |      |               | Parcel Id                            | C  | Owne 0.0    |
|                     |      |               | Adjust Type Code Description Factor% |    |             |
|                     |      |               | Condo Flr                            |    |             |
|                     |      |               | Condo Unit                           |    |             |
|                     |      |               | <b>COST / MARKET VALUATION</b>       |    |             |
|                     |      |               | Building Value New                   |    | 2,492,747   |
|                     |      |               | Year Built                           |    | 1999        |
|                     |      |               | Effective Year Built                 |    | 2005        |
|                     |      |               | Depreciation Code                    |    | A           |
|                     |      |               | Remodel Rating                       |    |             |
|                     |      |               | Year Remodeled                       |    |             |
|                     |      |               | Depreciation %                       |    | 11          |
|                     |      |               | Functional Obsol                     |    | 0           |
|                     |      |               | External Obsol                       |    | 0           |
|                     |      |               | Trend Factor                         |    | 1           |
|                     |      |               | Condition                            |    |             |
|                     |      |               | Condition %                          |    |             |
|                     |      |               | Percent Good                         |    | 89          |
|                     |      |               | RCNLD                                |    | 2,218,500   |
|                     |      |               | Dep % Ovr                            |    |             |
|                     |      |               | Dep Ovr Comment                      |    |             |
|                     |      |               | Misc Imp Ovr                         |    |             |
|                     |      |               | Misc Imp Ovr Comment                 |    |             |
|                     |      |               | Cost to Cure Ovr                     |    |             |
|                     |      |               | Cost to Cure Ovr Comment             |    |             |

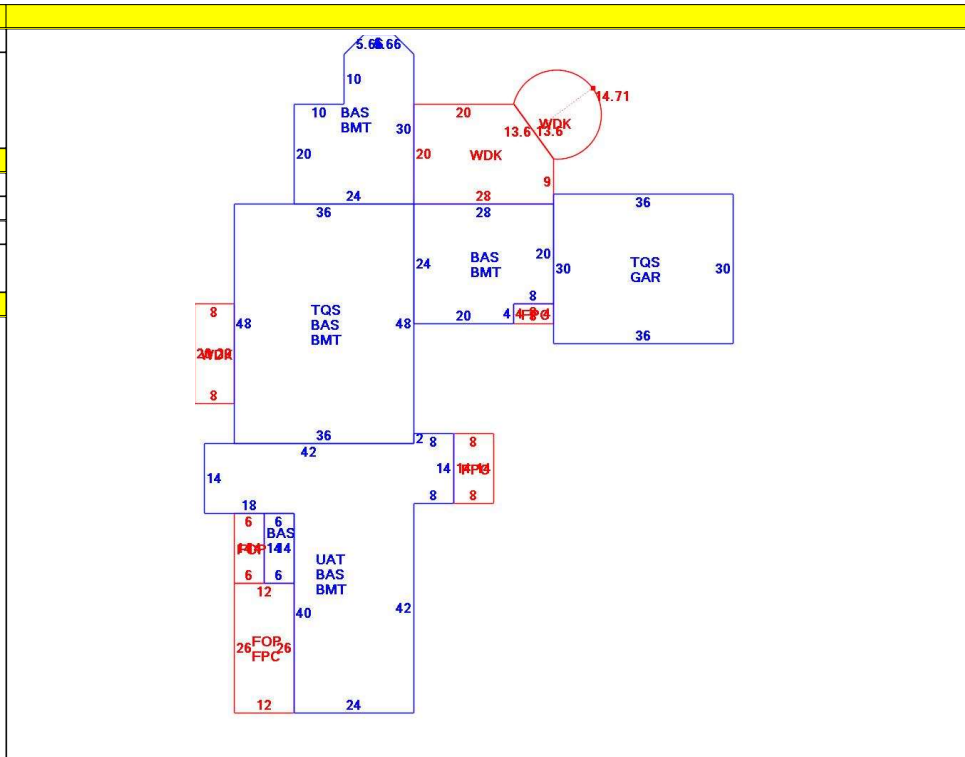

| OB - OUTBUILDING & YARD ITEMS(L) / XF - BUILDING EXTRA FEATURES(B) |                 |     |       |            |        |          |      |       |            |             |
|--|-----------------|-----|-------|------------|--------|----------|------|-------|------------|-------------|
| Code   | Description     | L/B | Units | Unit Price | Yr Blt | Cond. Cd | % Gd | Grade | Grade Adj. | Appr. Value |
| BFA3   | Bsmt Fin-Exc-   | B   | 3,300 | 63.36      | 2007   |          | 89   |       | 0.00       | 186,100     |
| GEN1   | Large Generat   | L   | 1     | 29300.00   | 2004   |          | 70   |       | 0.00       | 20,500      |
| WDC  | Wood Decking    | L   | 897   | 20.00      | 2005   |          | 72   |       | 0.00       | 11,600      |
| FOP  | Open Porch-ro   | B   | 396   | 55.00      | 2007   |          | 89   |       | 0.00       | 13,700      |
| GAR  | Attached Gara   | B   | 1,080 | 40.00      | 2007   |          | 89   |       | 0.00       | 29,400      |
| BMT  | Basement-Unfi   | B   | 4,688 | 26.01      | 2007   |          | 89   |       | 0.00       | 84,800      |
| FPL2   | Fireplace 1.5 s | B   | 1     | 6000.00    | 2007   |          | 89   |       | 0.00       | 5,300       |
| FOPC   | Open Prch-roo   | B   | 456   | 55.00      | 2007   |          | 89   |       | 0.00       | 15,100      |

| BUILDING SUB-AREA SUMMARY SECTION |                        |             |            |          |           |                |
|-----------------------------------|------------------------|-------------|------------|----------|-----------|----------------|
| Code                              | Description            | Living Area | Floor Area | Eff Area | Unit Cost | Undeprec Value |
| BAS                               | First Floor            | 4,772       | 4,772      | 4,772    | 368.59    | 1,758,892      |
| BMT                               | Basement Area          | 0           | 4,688      | 0        | 0.00      | 0              |
| FOP                               | Open Porch             | 0           | 396        | 0        | 0.00      | 0              |
| FPC                               | Open Porch Conc. Floor | 0           | 456        | 0        | 0.00      | 0              |
| GAR                               | Attached Garage        | 0           | 1,080      | 0        | 0.00      | 0              |
| TQS                               | Three Quarter Story    | 1,825       | 2,808      | 1,825    | 239.55    | 672,669        |
| UAT                               | Attic, Unfinished      | 0           | 1,660      | 166      | 36.86     | 61,185         |
| WDK                               | Wood Deck              | 0           | 897        | 0        | 0.00      | 0              |
| Ttl Gross Liv / Lease Area        |                        | 6,597       | 16,757     | 6,763    |           | 2,492,746      |

