

| CURRENT OWNER  |  | TOPO    | UTILITIES      | STRT / ROAD  | LOCATION        | CURRENT ASSESSMENT |      |          |          | 801<br>FY2024<br>BARNSTABLE, MA<br><br><b>VISION</b> |         |
|--|--|---------|----------------|--|-----------------|--------------------|------|----------|----------|--|---------|
| 130 MISTIC DRIVE LLC<br><br>10 JERICO ROAD<br><br>SCITUATE MA 02066                                      |  | 1 Level | 2 Public Water | 1 Paved  | 1 Lake/Pond Fro | Description        | Code | Assessed | Assessed |  |         |
|  |  |         | 4 Gas          |  |                 | RESIDENTL          | 1010 | 439,300  | 439,300  |  |         |
|  |  |         | 6 Septic       |  |                 | RES LAND           | 1010 | 546,500  | 546,500  |  |         |
| <b>SUPPLEMENTAL DATA</b>   |  |         |                |  |                 | Total              |      |          |          | 985,800  | 985,800 |
| Alt Prcl ID<br>Split Zonin<br>BID Parcel<br>ResExpt Q<br>#DL 1 LOT 8<br>#DL 2<br>GIS ID F_953362_2704077 |  |         |                | Plan Ref. 203/53<br>Land Ct#<br>#SR<br>Life Estate<br>PP STATU<br>Assoc Pid# |                 |                    |      |          |          |  |         |

| RECORD OF OWNERSHIP               |  | BK-VOL/PAGE | SALE DATE  | Q/U | V/I | SALE PRIC | VC | PREVIOUS ASSESSMENTS (HISTORY) |           |          |       |         |          |       |         |          |  |
|-----------------------------------|--|-------------|------------|-----|-----|-----------|----|--------------------------------|-----------|----------|-------|---------|----------|-------|---------|----------|--|
| 130 MISTIC DRIVE LLC              |  | 34540 118   | 10-04-2021 | Q   | I   | 1,095,000 | 00 | Year                           | Code      | Assessed | Year  | Code    | Assessed | Year  | Code    | Assessed |  |
| BELSKY, HAROLD & SANDLER, LAURA E |  | 28371 0062  | 09-09-2014 | U   | I   | 1         | 1A | 2023                           | 1010      | 378,400  | 2022  | 1010    | 295,300  | 2021  | 1010    | 238,600  |  |
| BELSKY, GERALD G TR               |  | 10481 0023  | 11-14-1996 | U   | I   | 100       | 1A |                                | 1010      | 644,500  |       | 1010    | 364,900  |       | 1010    | 389,100  |  |
| BELSKY, GERALD G & EVELYN D       |  | 3323 0224   | 07-15-1981 | U   |     | 0         |    | Total                          |           |          | Total |         |          | Total |         |          |  |
|                                   |  |             |            |     |     |           |    |                                | 1,022,900 |          |       | 660,200 |          |       | 634,100 |          |  |

| EXEMPTIONS |      |             |        | OTHER ASSESSMENTS |             |        |        | This signature acknowledges a visit by a Data Collector or Assessor |  |  |  |  |  |  |  |  |  |  |
|------------|------|-------------|--------|-------------------|-------------|--------|--------|---|--|--|--|--|--|--|--|--|--|--|
| Year       | Code | Description | Amount | Code              | Description | Number | Amount | Comm Int  |  |  |  |  |  |  |  |  |  |  |
|            |      |             | Total  |                   |             |        | 0.00   |   |  |  |  |  |  |  |  |  |  |  |

| ASSESSING NEIGHBORHOOD |           |   |         | APPRAISED VALUE SUMMARY       |  |  |  |  |  |         |
|------------------------|-----------|---|---------|-------------------------------|--|--|--|--|--|---------|
| Nbhd                   | Nbhd Name | B | Tracing | Batch                         |  |  |  |  |  |         |
| 0111                   |           |   | MARSTM  |                               |  |  |  |  |  |         |
| NOTES                  |           |   |         | Appraised Bldg. Value (Card)  |  |  |  |  |  | 388,900 |
|                        |           |   |         | Appraised Xf (B) Value (Bldg) |  |  |  |  |  | 40,400  |
|                        |           |   |         | Appraised Ob (B) Value (Bldg) |  |  |  |  |  | 10,000  |
|                        |           |   |         | Appraised Land Value (Bldg)   |  |  |  |  |  | 546,500 |
|                        |           |   |         | Special Land Value            |  |  |  |  |  | 0       |
|                        |           |   |         | Total Appraised Parcel Value  |  |  |  |  |  | 985,800 |
|                        |           |   |         | Valuation Method              |  |  |  |  |  | C       |
|                        |           |   |         | Total Appraised Parcel Value  |  |  |  |  |  | 985,800 |

| BUILDING PERMIT RECORD |            |      |                 |        |            |        |            |                                |  | VISIT / CHANGE HISTORY |    |      |    |    |                       |
|------------------------|------------|------|-----------------|--------|------------|--------|------------|--------------------------------|--|------------------------|----|------|----|----|-----------------------|
| Permit Id              | Issue Date | Type | Description     | Amount | Insp Date  | % Comp | Date Comp  | Comments                       |  | Date                   | Id | Type | Is | Cd | Purpost/Result        |
| SHED-22-3              | 01-24-2022 | 863  | Shed Registrati | 0      | 03-30-2023 | 100    | 06-30-2023 |                                |  | 03-30-2023             | SR | 02   |    | 02 | Bldg Permit Completed |
| 17-1914                | 06-30-2017 | 809  | Deck            | 6,500  | 07-21-2017 | 100    | 06-30-2017 | Deck 14x14 replace in existing |  | 06-13-2022             | SR | 01   |    | 13 | CALL BACK             |
| 201404773              | 07-24-2014 | OT   | Other           | 5,400  | 08-25-2014 | 100    | 06-30-2015 | OT REMOVE EXIST FRONT          |  | 05-12-2020             | LS |      |    | FR | Field Review          |
| B21679                 | 09-01-1979 | DW   | Dwelling        | 0      | 01-15-1981 | 100    | 06-30-1981 | MM 1 STOR                      |  | 07-28-2017             | SR | 01   |    | 02 | Bldg Permit Completed |
|                        |            |      |                 |        |            |        |            |                                |  | 07-27-2017             | KM | 02   |    | 03 | Cycl Insp Comp        |
|                        |            |      |                 |        |            |        |            |                                |  | 10-13-2015             | LH | 03   |    | 16 | In Office Review      |
|                        |            |      |                 |        |            |        |            |                                |  | 01-08-2015             | TP | 03   |    | 16 | In Office Review      |

| LAND LINE VALUATION SECTION |          |                |      |    |            |            |                        |         |            |       |       |           |                  |                    |            |            |
|-----------------------------|----------|----------------|------|----|------------|------------|------------------------|---------|------------|-------|-------|-----------|------------------|--------------------|------------|------------|
| B                           | Use Code | Description    | Zone | LA | Land Units | Unit Price | Size Adj               | AC Disc | Site Index | Cond. | Nbhd. | Nbhd. Adj | Notes            | Location Adjustmen | Adj Unit P | Land Value |
| 1                           | 1010     | Single Fam M-0 | RF   | 3  | 1.000 AC   | 176,344.00 | 1.00000                | 1.0000  | 5          | 1.00  | 0111  | 3.050     | HAMBLIN POND     | 1.0000             | 537,849.2  | 537,800    |
| 1                           | 1010     | Single Fam M-0 | RF   | 3  | 0.200 AC   | 14,250.00  | 1.00000                | 1.0000  | 0          | 1.00  | 0111  | 3.050     |                  | 1.0000             | 43,462.5   | 8,700      |
| Total Card Land Units       |          |                |      |    | 1.20       | AC         | Parcel Total Land Area |         |            |       |       | 1.20      | Total Land Value |                    |            | 546,500    |

| CONSTRUCTION DETAIL |    |                | CONSTRUCTION DETAIL (CONTINUED) |    |             |
|---------------------|----|----------------|---------------------------------|----|-------------|
| Element             | Cd | Description    | Element                         | Cd | Description |
| Style               | 01 | Ranch          |                                 |    |             |
| Model               | 01 | Residential    |                                 |    |             |
| Grade:              | C  | Average        |                                 |    |             |
| Stories             | 1  | 1 Story        |                                 |    |             |
| Exterior Wall 1     | 25 | Vinyl Siding   |                                 |    |             |
| Exterior Wall 2     |    |                |                                 |    |             |
| RooF Structure      | 03 | Gable/Hip      |                                 |    |             |
| RooF Cover          | 03 | Asph/F Gls/Cmp |                                 |    |             |
| Interior Wall 1     | 05 | Drywall        |                                 |    |             |
| Interior Wall 2     |    |                |                                 |    |             |
| Interior Floor 1    | 14 | Carpet         |                                 |    |             |
| Interior Floor 2    | 09 | Pine/Soft Wood |                                 |    |             |
| Heat Fuel           | 03 | Gas            |                                 |    |             |
| Heat Type           | 05 | Hot Water      |                                 |    |             |
| AC Type             | 03 | Central        |                                 |    |             |
| Bedrooms            | 03 | 3 Bedrooms     |                                 |    |             |
| Full Baths          | 2  |                |                                 |    |             |
| Half Baths          | 1  |                |                                 |    |             |
| Extra Fixtures      |    |                |                                 |    |             |
| Total Rooms         | 5  | 5 Rooms        |                                 |    |             |
| Bath Style          |    |                |                                 |    |             |
| Kitchen Style       |    |                |                                 |    |             |
| Occupancy           |    |                |                                 |    |             |
| Usrflid 105         |    |                |                                 |    |             |
| Accessory Apt       |    |                |                                 |    |             |
| Foundation Alt      | 01 | Poured Conc.   |                                 |    |             |
| Rms Prts            |    |                |                                 |    |             |
| Bath Split          | 21 | 2 Full-1 Half  |                                 |    |             |

| CONDO DATA               |      |             |         |
|--------------------------|------|-------------|---------|
| Parcel Id                | C    | Ownr        | 0.0     |
| Adjust Type              | Code | Description | Factor% |
| Condo Flr                |      |             |         |
| Condo Unit               |      |             |         |
| COST / MARKET VALUATION  |      |             |         |
| Building Value New       |      | 480,182     |         |
| Year Built               |      | 1979        |         |
| Effective Year Built     |      | 1995        |         |
| Depreciation Code        |      | A           |         |
| Remodel Rating           |      |             |         |
| Year Remodeled           |      |             |         |
| Depreciation %           |      | 19          |         |
| Functional Obsol         |      | 0           |         |
| External Obsol           |      | 0           |         |
| Trend Factor             |      | 1           |         |
| Condition                |      |             |         |
| Condition %              |      |             |         |
| Percent Good             |      | 81          |         |
| RCNLD                    |      | 388,900     |         |
| Dep % Ovr                |      |             |         |
| Dep Ovr Comment          |      |             |         |
| Misc Imp Ovr             |      |             |         |
| Misc Imp Ovr Comment     |      |             |         |
| Cost to Cure Ovr         |      |             |         |
| Cost to Cure Ovr Comment |      |             |         |

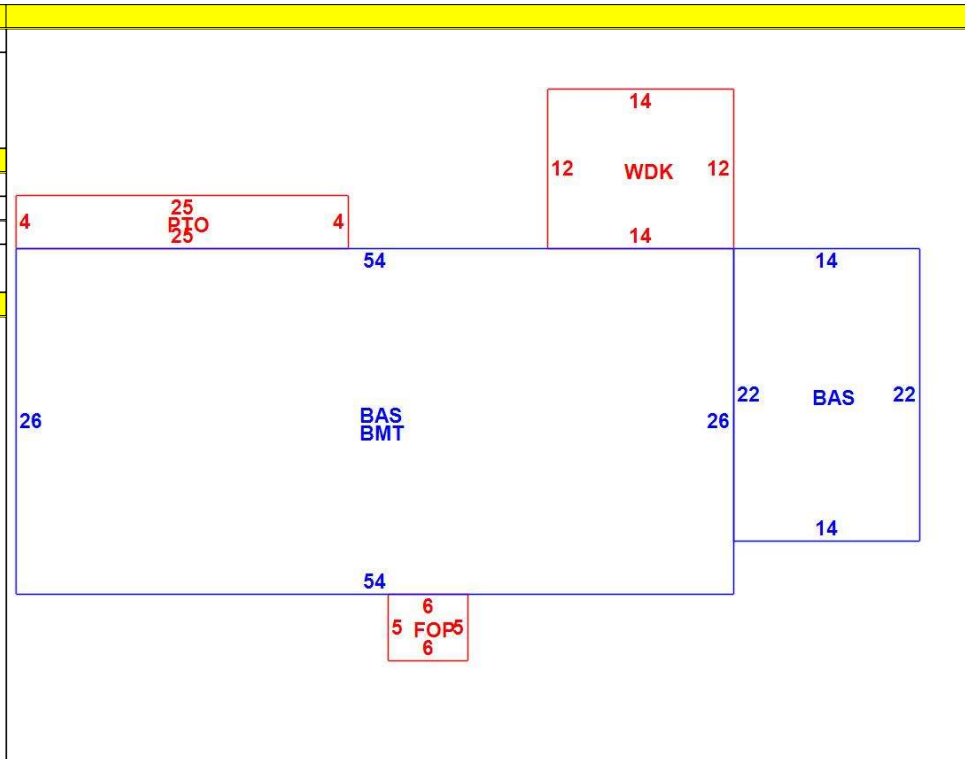

| OB - OUTBUILDING & YARD ITEMS(L) / XF - BUILDING EXTRA FEATURES(B) |                 |     |       |            |        |          |      |       |            |             |
|--|-----------------|-----|-------|------------|--------|----------|------|-------|------------|-------------|
| Code   | Description     | L/B | Units | Unit Price | Yr Blt | Cond. Cd | % Gd | Grade | Grade Adj. | Appr. Value |
| FPL1   | Fireplace 1 sto | B   | 1     | 5000.00    | 1997   |          | 81   |       | 0.00       | 4,100       |
| BFA  | Bsmt Fin-Avg    | B   | 500   | 17.36      | 1997   |          | 81   |       | 0.00       | 7,000       |
| WDC  | Deck comp w     | L   | 168   | 28.00      | 2017   |          | 96   |       | 0.00       | 5,800       |
| BMT  | Basement-Unfi   | B   | 1,404 | 26.01      | 1997   |          | 81   |       | 0.00       | 27,400      |
| FOP  | Open Porch-ro   | B   | 30    | 55.00      | 1997   |          | 81   |       | 0.00       | 1,900       |
| PAT1   | Patio- Average  | L   | 100   | 5.89       | 2000   |          | 81   |       | 0.00       | 600         |
| SHED   | Shed            | L   | 200   | 18.00      | 2023   |          | 100  |       | 0.00       | 3,600       |

| BUILDING SUB-AREA SUMMARY SECTION |               |             |            |          |           |                |
|-----------------------------------|---------------|-------------|------------|----------|-----------|----------------|
| Code                              | Description   | Living Area | Floor Area | Eff Area | Unit Cost | Undeprec Value |
| BAS                               | First Floor   | 1,712       | 1,712      | 1,712    | 280.48    | 480,182        |
| BMT                               | Basement Area | 0           | 1,404      | 0        | 0.00      | 0              |
| FOP                               | Open Porch    | 0           | 30         | 0        | 0.00      | 0              |
| PTO                               | Patio         | 0           | 100        | 0        | 0.00      | 0              |
| WDC                               | Wood Deck     | 0           | 168        | 0        | 0.00      | 0              |
| Ttl Gross Liv / Lease Area        |               | 1,712       | 3,414      | 1,712    |           | 480,182        |

