

| CURRENT OWNER | | TOPO | UTILITIES | STRT / ROAD | LOCATION | CURRENT ASSESSMENT | | | | 801 FY2024 BARNSTABLE, MA VISION | |
|--|--|-------------------------|----------------|-------------|------------------|--------------------|------|----------|----------|--|---------|
| GONCALVES, ELSON TR PHOENIX REALTY TRUST 534 MARSTONS LANE YARMOUTH PO MA 02675 | | 1 Level | 6 Septic | 1 Paved | | Description | Code | Assessed | Assessed | | |
| | | | 4 Gas | | | RESIDNTL | 1010 | 358,600 | 358,600 | | |
| | | | 2 Public Water | | | RES LAND | 1010 | 156,200 | 156,200 | | |
| SUPPLEMENTAL DATA | | | | | | Total | | | | 514,800 | 514,800 |
| | | Alt Prcl ID | Split Zonin | Plan Ref. | Land Ct# 29500-A | | | | | | |
| | | BID Parcel | ResExpt Q | #SR | Life Estate | | | | | | |
| | | #DL 1 LOT 1 | #DL 2 | PP STATU | Assoc Pid# | | | | | | |
| | | GIS ID F_955257_2701820 | | | | | | | | | |

| RECORD OF OWNERSHIP | | BK-VOL/PAGE | SALE DATE | Q/U | V/I | SALE PRIC | VC | PREVIOUS ASSESSMENTS (HISTORY) | | | | | | | | |
|-----------------------------|---------|-------------|------------|------|------------|-----------|------|--------------------------------|-------|---------|----------|---------|---------|------|------|---------|
| Year | Code | Assessed | Year | Code | Assessed V | Year | Code | Assessed | Year | Code | Assessed | | | | | |
| GONCALVES, ELSON TR | C222526 | 0 | 05-21-2020 | U | I | 10 | 1F | 2023 | 1010 | 309,500 | 2022 | 1010 | 268,000 | 2021 | 1010 | 214,800 |
| GONCALVES, ELSON | C216721 | 0 | 07-10-2018 | Q | I | 260,000 | 00 | | 1010 | 142,000 | | 1010 | 105,200 | | 1010 | 105,200 |
| TAYLOR, CATHERINE ESTATE OF | D134164 | 0 | 04-03-2017 | U | I | 0 | 1F | | | | | | | | 1010 | 6,600 |
| TAYLOR, CATHERINE | D102134 | 0 | 12-16-2004 | U | I | 0 | 1F | Total | | | | | | | | |
| TAYLOR, JAMES & CATHERINE | C73804 | 0 | 04-21-1978 | U | I | 0 | 0 | 451,500 | Total | 373,200 | Total | 326,600 | | | | |

| EXEMPTIONS | | | OTHER ASSESSMENTS | | | | This signature acknowledges a visit by a Data Collector or Assessor | | | | | | | | | |
|------------|------|-------------|-------------------|------|-------------|--------|---|----------|--|--|--|--|--|--|--|--|
| Year | Code | Description | Amount | Code | Description | Number | Amount | Comm Int | | | | | | | | |
| Total | | 0.00 | | | | | | | | | | | | | | |

| ASSESSING NEIGHBORHOOD | | | | | | APPRAISED VALUE SUMMARY | | | | |
|------------------------|-----------|---|---------|-------|--|-------------------------------|--|--|--|---------|
| Nbhd | Nbhd Name | B | Tracing | Batch | | | | | | |
| 0105 | | | MARSTM | | | | | | | |
| NOTES | | | | | | APPRAISED VALUE SUMMARY | | | | |
| | | | | | | Appraised Bldg. Value (Card) | | | | 309,100 |
| | | | | | | Appraised Xf (B) Value (Bldg) | | | | 42,900 |
| | | | | | | Appraised Ob (B) Value (Bldg) | | | | 6,600 |
| | | | | | | Appraised Land Value (Bldg) | | | | 156,200 |
| | | | | | | Special Land Value | | | | 0 |
| | | | | | | Total Appraised Parcel Value | | | | 514,800 |
| | | | | | | Valuation Method | | | | C |
| | | | | | | Total Appraised Parcel Value | | | | 514,800 |

| BUILDING PERMIT RECORD | | | | | | | | VISIT / CHANGE HISTORY | | | | | | | |
|------------------------|------------|------|-----------------|--------|------------|--------|------------|--------------------------|------------|----|------|----|----|------------------|--|
| Permit Id | Issue Date | Type | Description | Amount | Insp Date | % Comp | Date Comp | Comments | Date | Id | Type | Is | Cd | Purpost/Result | |
| 18-2034 | 06-26-2018 | 831 | Restre to Singl | 1,500 | | 100 | | RETURN TO A SINGLE FAMIL | 05-13-2020 | LS | | | FR | Field Review | |
| B26475 | 05-01-1984 | DW | Dwelling | 0 | 01-15-1986 | 100 | 12-31-1986 | MM 1 STOR | 04-23-2018 | KM | 02 | | 03 | Cycl Insp Comp | |
| | | | | | | | | | 03-30-2018 | LH | 03 | | 16 | In Office Review | |

| LAND LINE VALUATION SECTION | | | | | | | | | | | | | | | | | |
|-----------------------------|----------|----------------|------|----|------------|------------|------------------------|---------|------------|-------|-------|-----------|------------------|--------------------|------------|------------|---------|
| B | Use Code | Description | Zone | LA | Land Units | Unit Price | Size Adj | AC Disc | Site Index | Cond. | Nbhd. | Nbhd. Adj | Notes | Location Adjustmen | Adj Unit P | Land Value | |
| 1 | 1010 | Single Fam M-0 | RF | 3 | 0.470 | AC | 176,344.00 | 1.88432 | 1.0000 | 5 | 1.00 | 0105 | 1.000 | | 1.0000 | 332,285 | 156,200 |
| Total Card Land Units | | | | | 0.47 | AC | Parcel Total Land Area | | | | | 0.47 | Total Land Value | | | | 156,200 |

| CONSTRUCTION DETAIL | | | CONSTRUCTION DETAIL (CONTINUED) | | |
|---------------------|----|----------------|---------------------------------|----|-------------|
| Element | Cd | Description | Element | Cd | Description |
| Style | 01 | Ranch | | | |
| Model | 01 | Residential | | | |
| Grade: | C | Average | | | |
| Stories | 1 | 1 Story | | | |
| Exterior Wall 1 | 13 | T111 Siding | | | |
| Exterior Wall 2 | | | | | |
| RooF Structure | 03 | Gable/Hip | | | |
| RooF Cover | 03 | Asph/F Gls/Cmp | | | |
| Interior Wall 1 | 05 | Drywall | | | |
| Interior Wall 2 | | | | | |
| Interior Floor 1 | 14 | Carpet | | | |
| Interior Floor 2 | | | | | |
| Heat Fuel | 03 | Gas | | | |
| Heat Type | 05 | Hot Water | | | |
| AC Type | 01 | None | | | |
| Bedrooms | 03 | 3 Bedrooms | | | |
| Full Baths | 2 | | | | |
| Half Baths | 0 | | | | |
| Extra Fixtures | | | | | |
| Total Rooms | 5 | 5 Rooms | | | |
| Bath Style | | | | | |
| Kitchen Style | | | | | |
| Occupancy | | | | | |
| Usrflid 105 | | | | | |
| Accessory Apt | | | | | |
| Foundation Alt | 01 | Poured Conc. | | | |
| Rms Prts | | | | | |
| Bath Split | 20 | 2 Full-0 Half | | | |

| CONDO DATA | | | |
|-------------|------|-------------|----------|
| Parcel Id | | C | Owne 0.0 |
| | | B | S |
| Adjust Type | Code | Description | Factor% |
| Condo Flr | | | |
| Condo Unit | | | |

| COST / MARKET VALUATION | |
|--------------------------|---------|
| Building Value New | 368,006 |
| Year Built | 1984 |
| Effective Year Built | 1998 |
| Depreciation Code | A |
| Remodel Rating | |
| Year Remodeled | |
| Depreciation % | 16 |
| Functional Obsol | 0 |
| External Obsol | 0 |
| Trend Factor | 1 |
| Condition | |
| Condition % | |
| Percent Good | 84 |
| RCNLD | 309,100 |
| Dep % Ovr | |
| Dep Ovr Comment | |
| Misc Imp Ovr | |
| Misc Imp Ovr Comment | |
| Cost to Cure Ovr | |
| Cost to Cure Ovr Comment | |

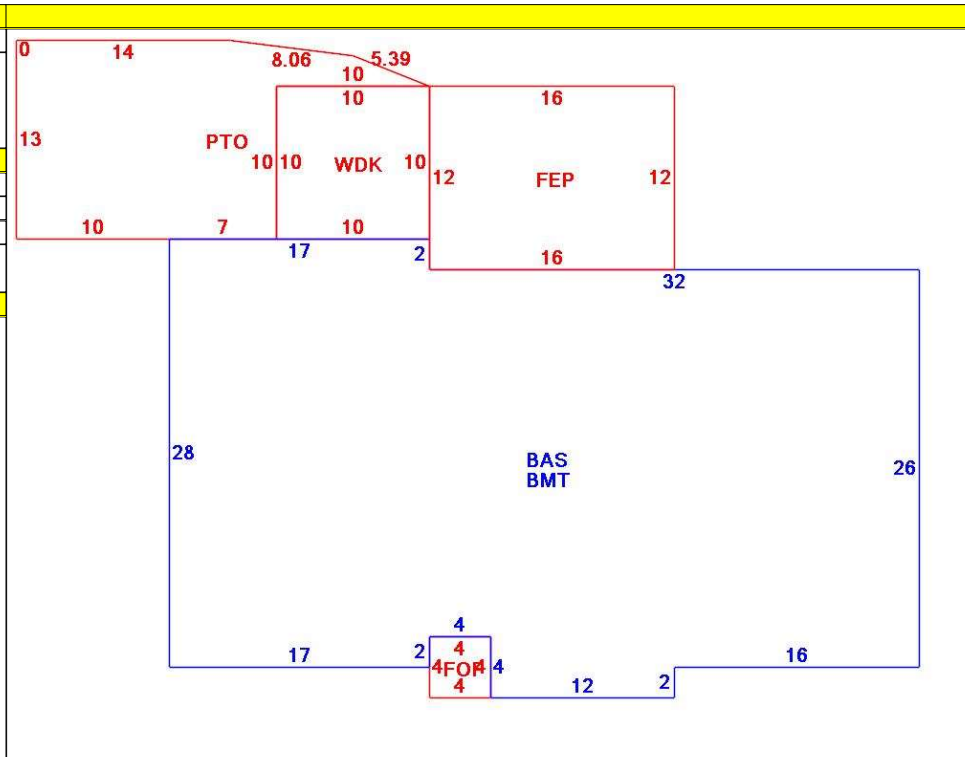

| OB - OUTBUILDING & YARD ITEMS(L) / XF - BUILDING EXTRA FEATURES(B) | | | | | | | | | | |
|--|-----------------|-----|-------|------------|--------|----------|------|-------|------------|-------------|
| Code | Description | L/B | Units | Unit Price | Yr Blt | Cond. Cd | % Gd | Grade | Grade Adj. | Appr. Value |
| FPL1 | Fireplace 1 sto | B | 1 | 5000.00 | 2000 | | 84 | | 0.00 | 4,200 |
| PAT1 | Patio- Average | L | 237 | 5.89 | 1999 | | 80 | | 0.00 | 1,200 |
| FOP | Open Porch-ro | B | 16 | 55.00 | 2000 | | 84 | | 0.00 | 1,300 |
| FEP | Enclosed porc | B | 192 | 70.00 | 2000 | | 84 | | 0.00 | 10,300 |
| BMT | Basement-Unfi | B | 1,324 | 26.01 | 2000 | | 84 | | 0.00 | 27,100 |
| WDC | Wood Decking | L | 100 | 20.00 | 2017 | | 96 | | 0.00 | 3,300 |
| SHED | Shed | L | 120 | 18.00 | 2017 | | 96 | | 0.00 | 2,100 |

| BUILDING SUB-AREA SUMMARY SECTION | | | | | | |
|-----------------------------------|----------------|-------------|------------|----------|-----------|----------------|
| Code | Description | Living Area | Floor Area | Eff Area | Unit Cost | Undeprec Value |
| BAS | First Floor | 1,324 | 1,324 | 1,324 | 277.95 | 368,006 |
| BMT | Basement Area | 0 | 1,324 | 0 | 0.00 | 0 |
| FEP | Enclosed Porch | 0 | 192 | 0 | 0.00 | 0 |
| FOP | Open Porch | 0 | 16 | 0 | 0.00 | 0 |
| PTO | Patio | 0 | 237 | 0 | 0.00 | 0 |
| WDK | Wood Deck | 0 | 100 | 0 | 0.00 | 0 |
| Ttl Gross Liv / Lease Area | | 1,324 | 3,193 | 1,324 | | 368,006 |

