

CURRENT OWNER		TOPO	UTILITIES	STRT / ROAD	LOCATION	CURRENT ASSESSMENT						801 FY2024 BARNSTABLE, MA							
WHEELER, DONALD EUGENE JR						Description	Code	Assessed	Assessed										
30 MAIN STREET APT M						RESIDNTL	1020	180,000	180,000										
HYANNIS MA 02601												VISION							
SUPPLEMENTAL DATA																			
Alt Prcl ID				Plan Ref. 352/68-71															
Split Zonin				Land Ct#															
BID Parcel				#SR															
ResExpt Q				Life Estate															
#DL 1 UNIT C1				PP STATU															
#DL 2 CONCORD																			
GIS ID F_957941_2700994				Assoc Pid#															
							Total	180,000	180,000										
RECORD OF OWNERSHIP				BK-VOL/PAGE	SALE DATE	Q/U	V/I	SALE PRICE	VC	PREVIOUS ASSESSMENTS (HISTORY)									
WHEELER, DONALD EUGENE JR				33313 0326	09-30-2020	Q	I	160,000	00	Year	Code	Assessed	Year	Code	Assessed V	Year	Code	Assessed	
ECKSTEIN, STANLEY & DOROTHY				14163 0090	08-23-2001	U	I	1	1A	2023	1020	151,400	2022	1020	142,000	2021	1020	97,800	
ECKSTEIN, DOROTHY				14117 0036	08-07-2001	Q	I	45,000	00								1020	1,100	
KRASKER, ABRAHAN				3543 0335	08-15-1982	Q	I	36,000	00	Total			Total			Total			
										151,400			142,000			98,900			
EXEMPTIONS				OTHER ASSESSMENTS				This signature acknowledges a visit by a Data Collector or Assessor											
Year	Code	Description	Amount	Code	Description	Number	Amount	Comm Int											
			Total					0.00											
ASSESSING NEIGHBORHOOD																			
Nbhd		Nbhd Name		B		Tracing		Batch											
0001								MARSTM											
NOTES																			
BUILDING PERMIT RECORD												VISIT / CHANGE HISTORY							
Permit Id	Issue Date	Type	Description	Amount	Insp Date	% Comp	Date Comp	Comments	Date	Id	Type	Is	Cd	Purpost/Result					
									05-12-2020	LS			FR	Field Review					
									05-13-2019	SR	02		03	Cycl Insp Comp					
									08-18-2014	TP	03		16	In Office Review					
									07-30-2013	TP	03		16	In Office Review					
									05-10-2006	PT	02		01	Meas/Est					
LAND LINE VALUATION SECTION																			
B	Use Code	Description	Zone	Dist	Land Type	Land Units	Unit Price	Size Adj	Site Index	Cond.	Nbhd.	Nbhd. Adj	Notes	Location Adjustmen	Adj Unit P	Land Value			
1	102U	Condominium M	RF	3		0 SF	0.00	1.00000	5	1.00	0001	1.000		0.0000	0	0			
Total Card Land Units						0 SF	Parcel Total Land Area						0.00	Total Land Value				0	

CONSTRUCTION DETAIL			CONSTRUCTION DETAIL (CONTINUED)		
Element	Cd	Description	Element	Cd	Description
Style	55	Condominium			
Model	05	Res Condo			
Bedrm Func	C	Average			
Stories	1	1 Story			
Occupancy	0				
Interior Wall 1	05	Drywall			
Interior Wall 2					
Interior Floor 1	14	Carpet			
Interior Floor 2					
Heat Fuel	03	Gas			
Heat Type	05	Hot Water			
AC Type	01	None			
Bedrooms	01	1 Bedroom			
Full Baths	1	1 Full			
Half Baths	0				
Extra Fixtures					
Total Rooms	3	3 Rooms			
Bath Style					
Kitchen Style					
Master Deed L	375				
Bath Split	10	1 Full-0 Half			
Foundation	01	Poured Conc.			
AC Type Alt					
Sewer Occupan					
CONDO DATA					
Parcel Id	104244	C 0290	Owne	1.8	
	OSTERVILLE PIN	B 1	S 1		
Adjust Type	Code	Description	Factor%		
Condo Flr	1FU	FIRST FLOOR	144		
Condo Unit	MKT0	MKT0	100		
COST / MARKET VALUATION					
Building Value New		220,834			
Year Built		1968			
Effective Year Built		1995			
Depreciation Code		A			
Remodel Rating					
Year Remodeled		19			
Depreciation %		0			
Functional Obsol		0			
External Obsol		0			
Trend Factor		1			
Condition					
Condition %		81			
Percent Good		178,900			
Cns Sect Rcnd					
Dep % Ovr					
Dep Ovr Comment					
Misc Imp Ovr					
Misc Imp Ovr Comment					
Cost to Cure Ovr					
Cost to Cure Ovr Comment					

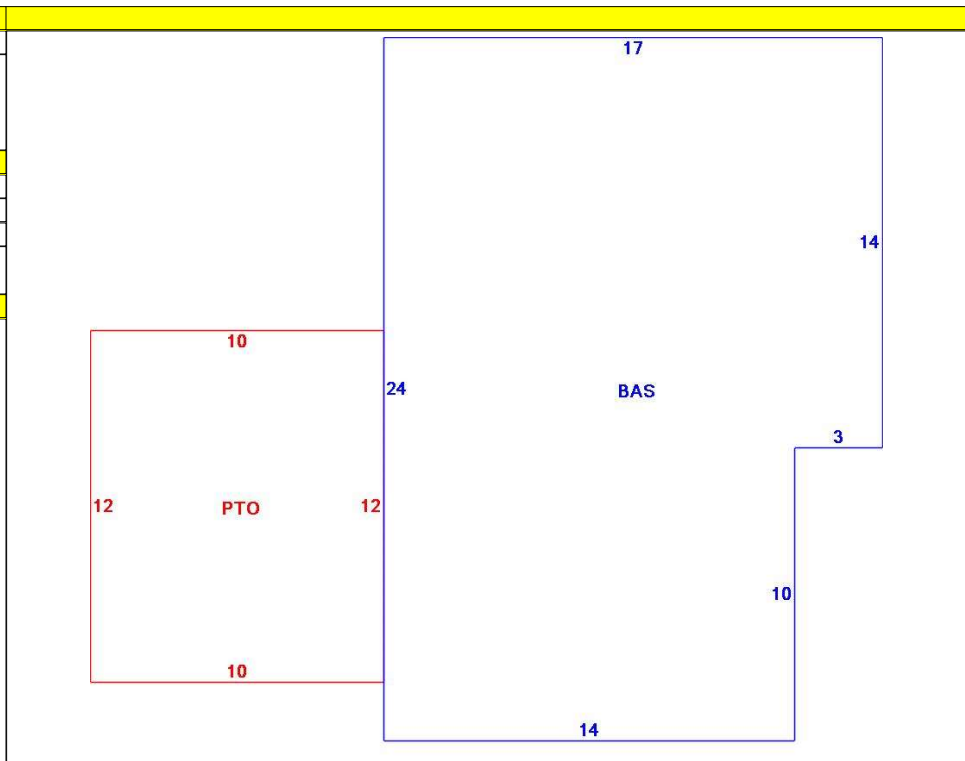

OB - OUTBUILDING & YARD ITEMS(L) / XF - BUILDING EXTRA FEATURES(B)										
Code	Description	L/B	Units	Unit Price	Yr Blt	Cond. Cd	% Gd	Grade	Grade Adj.	Appr. Value
PAT2	Patio-Good	L	120	9.94	1994		75		0.00	1,100

BUILDING SUB-AREA SUMMARY SECTION							
Code	Description	Living Area	Floor Area	Eff Area	Unit Cost	Undeprec Value	
BAS	First Floor	378	378	378	584.21	220,831	
PTO	Patio	0	120	0	0.00	0	
Ttl Gross Liv / Lease Area		378	498	378		220,831	

