

| CURRENT OWNER | | TOPO | | UTILITIES | | STRT / ROAD | | LOCATION | | CURRENT ASSESSMENT | | | |
|---|--|------|-------|-----------|--------------|--|-------|----------|---------------|---------------------------|------|-----------|-----------|
| UEHLEIN, W FREDERICK & DIANA T 109 EEL RIVER ROAD NOMINEE TRU 109 EEL RIVER RD OSTERVILLE MA 02655 | | 1 | Level | 2 | Public Water | 1 | Paved | 7 | Waterfront | Description | Code | Assessed | Assessed |
| | | | | 4 | Gas | | | 1 | Excel View | RESIDNTL | 1090 | 2,091,200 | 2,091,200 |
| | | | | 6 | Septic | | | 9 | Rear Location | RES LAND | 1090 | 4,585,500 | 4,585,500 |
| SUPPLEMENTAL DATA | | | | | | | | | | | | | |
| Alt Prcl ID Split Zonin BID Parcel ResExpt Q YES: #DL 1 LOT 1 & 2 #DL 2 GIS ID F_959434_2688563 | | | | | | Plan Ref. Land Ct# 3145-U & V #SR Life Estate PP STATU Assoc Pid# | | | | Total 6,676,700 6,676,700 | | | |

801
 FY2024
 BARNSTABLE, MA

VISION

| RECORD OF OWNERSHIP | | BK-VOL/PAGE | | SALE DATE | | Q/U | | V/I | | SALE PRIC | | VC | | PREVIOUS ASSESSMENTS (HISTORY) | | | | | | | | |
|----------------------------------|--|-------------|---|------------|--|-----|---|-----|--|-----------|--|-------|--|--------------------------------|------|-----------|------|-----------|-----------|------|------|-----------|
| UEHLEIN, W FREDERICK & DIANA TRS | | C180233 | 0 | 06-05-2006 | | Q | I | | | 3,700,000 | | 00 | | Year | Code | Assessed | Year | Code | Assessed | Year | Code | Assessed |
| LARMON, JAY S TR | | C166755 | 0 | 10-01-2002 | | U | I | | | 1 | | 1A | | 2023 | 1090 | 1,894,000 | 2022 | 1090 | 1,566,600 | 2021 | 1090 | 1,141,200 |
| LARMON, JAY S & SALLY M | | C152500 | 0 | 03-30-1999 | | U | I | | | 1 | | 1A | | | 1090 | 4,168,700 | | 1090 | 3,088,100 | | 1090 | 2,850,600 |
| LARMON, JAY STANTON & SALLY M | | C117915 | 0 | 06-15-1989 | | U | I | | | 1 | | 1A | | | | | | | | | 1090 | 232,000 |
| LARMON, JAY STANTON | | C99594 | 0 | 12-15-1984 | | U | I | | | 0 | | 1A | | | | | | | | | | |
| Total | | | | | | | | | | 6,062,700 | | Total | | 4,654,700 | | Total | | 4,223,800 | | | | |

| EXEMPTIONS | | | | OTHER ASSESSMENTS | | | |
|------------|------|-----------------------|--------|-------------------|-------------|--------|--------|
| Year | Code | Description | Amount | Code | Description | Number | Amount |
| 2023 | 5C | RESIDENTIAL EXEMPTION | 0.00 | | | | |
| Total | | | 0.00 | | | | |

This signature acknowledges a visit by a Data Collector or Assessor

| ASSESSING NEIGHBORHOOD | | | |
|------------------------|-----------|---|---------|
| Nbhd | Nbhd Name | B | Tracing |
| WF09 | | | OSTVIL |

| NOTES | | | |
|-------|--|--|--|
| | | | |

| APPRAISED VALUE SUMMARY | |
|-------------------------------|-----------|
| Appraised Bldg. Value (Card) | 1,666,800 |
| Appraised Xf (B) Value (Bldg) | 132,500 |
| Appraised Ob (B) Value (Bldg) | 291,900 |
| Appraised Land Value (Bldg) | 4,585,500 |
| Special Land Value | 0 |
| Total Appraised Parcel Value | 6,676,700 |
| Valuation Method | C |
| Total Appraised Parcel Value | 6,676,700 |

| BUILDING PERMIT RECORD | | | | | | | | | VISIT / CHANGE HISTORY | | | | | |
|------------------------|------------|------|-----------------|---------|------------|--------|------------|------------------------------------|------------------------|----|------|----|----|-----------------------|
| Permit Id | Issue Date | Type | Description | Amount | Insp Date | % Comp | Date Comp | Comments | Date | Id | Type | Is | Cd | Purpost/Result |
| BLDR-21-44 | 01-19-2021 | 830 | Pool - Inground | 87,680 | 09-01-2021 | 100 | 09-01-2021 | Installation of a single piece fib | 09-13-2022 | JO | | | 16 | In Office Review |
| 200801824 | 04-15-2008 | RE | Remodel | 21,760 | 08-14-2008 | 100 | 06-30-2009 | GUEST HSE | 05-29-2020 | WD | | | FR | Field Review |
| 200808070 | 01-17-2008 | AD | Addition | 15,000 | 08-14-2008 | 100 | 06-30-2009 | FNDN 26X40 | 08-14-2019 | SR | 02 | | 03 | Cycl Insp Comp |
| 200707369 | 11-19-2007 | DG | Detached Gara | 21,504 | 05-28-2008 | 100 | 01-12-2009 | LIVING QUARTERS ABOVE | 05-19-2015 | JR | 03 | | 03 | Cycl Insp Comp |
| 200707367 | 11-19-2007 | DW | Dwelling | 459,360 | 01-12-2009 | 100 | 06-30-2009 | REBLD AFTER DEMO | 06-30-2009 | NF | 03 | | 52 | New Construction |
| 200705675 | 09-11-2007 | DW | Dwelling | 459,360 | 05-28-2008 | 100 | 06-30-2009 | WITHDRAWN | 01-12-2009 | MK | 02 | | 02 | Bldg Permit Completed |
| 200705674 | 09-11-2007 | DE | Demolish | 10,000 | 05-28-2008 | 100 | 12-17-2007 | DEMO MAIN HOUSE | 08-14-2008 | MK | 02 | | 52 | New Construction |

| LAND LINE VALUATION SECTION | | | | | | | | | | | | | | | | | | |
|-----------------------------|----------|-----------------|------|----|------------|------------|------------------------|---------|------------|-------|-------|-----------|------------------|--------------------|------------|------------|-----------|-----------|
| B | Use Code | Description | Zone | LA | Land Units | Unit Price | Size Adj | AC Disc | Site Index | Cond. | Nbhd. | Nbhd. Adj | Notes | Location Adjustmen | Adj Unit P | Land Value | | |
| 1 | 1090 | Multi Hses M-01 | RF-1 | 3 | 1.000 | AC | 176,344.00 | 1.00000 | 1.0000 | 5 | 1.00 | WF10 | 26.000 | ROW ACCESS | 1.0000 | 4,584,944 | 4,584,900 | |
| Total Card Land Units | | | | | 1.00 | AC | Parcel Total Land Area | | | | | 1.04 | Total Land Value | | | | | 4,584,900 |

| CONSTRUCTION DETAIL | | | CONSTRUCTION DETAIL (CONTINUED) | | |
|---------------------|------|---------------|---------------------------------|------|---------------------|
| Element | Cd | Description | Element | Cd | Description |
| Style | 04 | Cape Cod | | | |
| Model | 01 | Residential | | | |
| Grade: | B+ | Custom Plus | | | |
| Stories | 1.75 | 1 3/4 Stories | | | |
| Exterior Wall 1 | 14 | Wood Shingle | | | |
| Exterior Wall 2 | | | | | |
| RooF Structure | 03 | Gable/Hip | | | |
| RooF Cover | 10 | Wood Shingle | | | |
| Interior Wall 1 | 05 | Drywall | | | |
| Interior Wall 2 | 02 | Wall Brd/Wood | | | |
| Interior Floor 1 | 14 | Carpet | | | |
| Interior Floor 2 | 12 | Hardwood | | | |
| Heat Fuel | 03 | Gas | | | |
| Heat Type | 04 | Hot Air | | | |
| AC Type | 03 | Central | | | |
| Bedrooms | 03 | 3 Bedrooms | | | |
| Full Baths | 4 | | | | |
| Half Baths | 0 | | | | |
| Extra Fixtures | | | | | |
| Total Rooms | 11 | 11 Rooms | | | |
| Bath Style | | | | | |
| Kitchen Style | | | | | |
| Occupancy | | | | | |
| Usrflid 105 | 2 | | | | |
| Accessory Apt | | | | | |
| Foundation Alt | 01 | Poured Conc. | | | |
| Rms Prts | | | | | |
| Bath Split | 40 | 4 Full-0 Half | | | |
| | | | CONDO DATA | | |
| | | | Parcel Id | C | Ownr 0.0 |
| | | | Adjust Type | Code | Description Factor% |
| | | | Condo Flr | | |
| | | | Condo Unit | | |
| | | | COST / MARKET VALUATION | | |
| | | | Building Value New | | 1,413,637 |
| | | | Year Built | | 2007 |
| | | | Effective Year Built | | 2009 |
| | | | Depreciation Code | | A |
| | | | Remodel Rating | | |
| | | | Year Remodeled | | |
| | | | Depreciation % | | 8 |
| | | | Functional Obsol | | 0 |
| | | | External Obsol | | 0 |
| | | | Trend Factor | | 1 |
| | | | Condition | | |
| | | | Condition % | | |
| | | | Percent Good | | 92 |
| | | | RCNLD | | 1,300,500 |
| | | | Dep % Ovr | | |
| | | | Dep Ovr Comment | | |
| | | | Misc Imp Ovr | | |
| | | | Misc Imp Ovr Comment | | |
| | | | Cost to Cure Ovr | | |
| | | | Cost to Cure Ovr Comment | | |

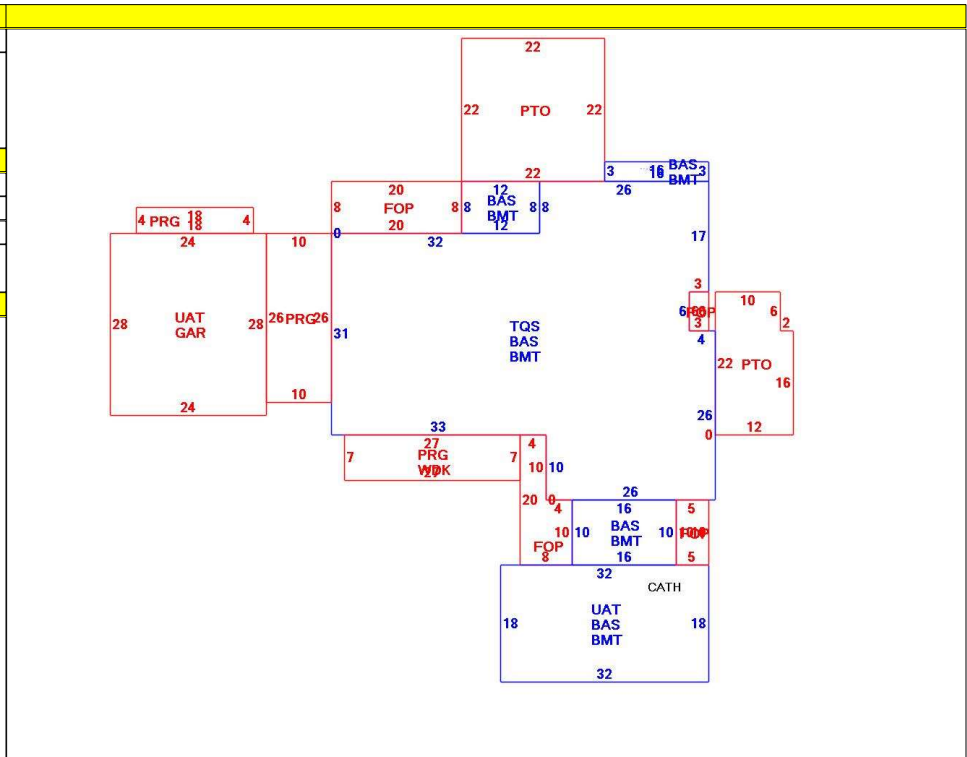

OB - OUTBUILDING & YARD ITEMS(L) / XF - BUILDING EXTRA FEATURES(B)

| Code | Description | L/B | Units | Unit Price | Yr Blt | Cond. Cd | % Gd | Grade | Grade Adj. | Appr. Value |
|------|-----------------|-----|-------|------------|--------|----------|------|-------|------------|-------------|
| FPL2 | Fireplace 1.5 s | B | 1 | 6000.00 | 2011 | | 92 | | 0.00 | 5,500 |
| FPO | Ext FP Openin | B | 1 | 2000.00 | 2011 | | 92 | | 0.00 | 1,800 |
| PATC | Conc Pavers | L | 736 | 15.46 | 2009 | | 90 | | 0.00 | 9,600 |
| WDC | Wood Deck w/ | L | 189 | 18.00 | 2009 | | 80 | | 0.00 | 3,300 |
| PRG1 | Pergola-Avg | L | 521 | 18.00 | 2007 | | 76 | C | 1.00 | 7,100 |
| FOP | Open Porch-ro | B | 348 | 55.00 | 2011 | | 92 | | 0.00 | 12,500 |
| GAR | Attached Gara | B | 672 | 40.00 | 2011 | | 92 | | 0.00 | 21,000 |
| BMT | Basement-Unfi | B | 3,144 | 26.01 | 2011 | | 92 | | 0.00 | 60,000 |
| PAT2 | Patio-Good | L | 113 | 9.94 | 2009 | | 90 | | 0.00 | 1,200 |
| DKHD | Dock-Heavy | L | 1 | 205000.0 | 2018 | | 98 | | 0.00 | 200,900 |

BUILDING SUB-AREA SUMMARY SECTION

| Code | Description | Living Area | Floor Area | Eff Area | Unit Cost | Undeprec Value |
|----------------------------|---------------------|-------------|------------|----------|-----------|----------------|
| BAS | First Floor | 3,144 | 3,144 | 3,144 | 298.17 | 937,455 |
| BMT | Basement Area | 0 | 3,144 | 0 | 0.00 | 0 |
| FOP | Open Porch | 0 | 348 | 0 | 0.00 | 0 |
| GAR | Attached Garage | 0 | 672 | 0 | 0.00 | 0 |
| PRG | Pergola | 0 | 521 | 0 | 0.00 | 0 |
| PTO | Patio | 0 | 736 | 0 | 0.00 | 0 |
| TQS | Three Quarter Story | 1,472 | 2,264 | 1,472 | 193.86 | 438,910 |
| UAT | Attic, Unfinished | 0 | 1,248 | 125 | 29.87 | 37,272 |
| WDK | Wood Deck | 0 | 189 | 0 | 0.00 | 0 |
| Ttl Gross Liv / Lease Area | | 4,616 | 12,266 | 4,741 | | 1,413,637 |



| CURRENT OWNER | | TOPO | UTILITIES | STRT / ROAD | LOCATION | CURRENT ASSESSMENT | | | | 801 FY2024 BARNSTABLE, MA | | | | | | |
|---|------------|-------------|----------------|-------------------|--|--------------------|-----------|---|--------------------------------|---------------------------------|-----------|-----------|-------|--------------------|------------|------------|
| UEHLEIN, W FREDERICK & DIANA T 109 EEL RIVER ROAD NOMINEE TRU 109 EEL RIVER RD OSTERVILLE MA 02655 | | 1 Level | 2 Public Water | 1 Paved | 7 Waterfront | Description | Code | Assessed | Assessed | | | | | | | |
| | | | 4 Gas | | 1 Excel View | RESIDNTL | 1090 | 2,091,200 | 2,091,200 | | | | | | | |
| | | | 6 Septic | | 9 Rear Location | RES LAND | 1090 | 4,585,500 | 4,585,500 | | | | | | | |
| SUPPLEMENTAL DATA | | | | | | | | | | | | | | | | |
| Alt Prcl ID Split Zonin BID Parcel ResExpt Q YES: #DL 1 LOT 1 & 2 #DL 2 GIS ID F_959434_2688563 | | | | | Plan Ref. Land Ct# 3145-U & V #SR Life Estate PP STATU Assoc Pid# | | Total | | 6,676,700 | 6,676,700 | | | | | | |
| RECORD OF OWNERSHIP | | | BK-VOL/PAGE | SALE DATE | Q/U | V/I | SALE PRIC | VC | PREVIOUS ASSESSMENTS (HISTORY) | | | | | | | |
| | | | | | | | | | Year | Code | Assessed | Year | Code | Assessed | | |
| | | | | | | | | | 2023 | 1090 | 1,894,000 | 2022 | 1090 | 1,566,600 | | |
| | | | | | | | | | | 1090 | 4,168,700 | | 1090 | 3,088,100 | | |
| | | | | | | | | | | | | 2021 | 1090 | 1,141,200 | | |
| | | | | | | | | | | | | | 1090 | 2,850,600 | | |
| | | | | | | | | | | | | | 1090 | 232,000 | | |
| | | | | | | | | | Total | | 6,062,700 | Total | | 4,654,700 | | |
| | | | | | | | | | Total | | 4,223,800 | Total | | 4,223,800 | | |
| EXEMPTIONS | | | | OTHER ASSESSMENTS | | | | This signature acknowledges a visit by a Data Collector or Assessor | | | | | | | | |
| Year | Code | Description | Amount | Code | Description | Number | Amount | Comm Int | | | | | | | | |
| | | | | | | | | | | | | | | | | |
| Total | | | | | | | | | | | | | | | | |
| ASSESSING NEIGHBORHOOD | | | | | | | | APPRAISED VALUE SUMMARY | | | | | | | | |
| Nbhd | Nbhd Name | | B | Tracing | | Batch | | Appraised Bldg. Value (Card) | | | | | | | | |
| WF09 | | | | | | OSTVIL | | Appraised Xf (B) Value (Bldg) | | | | | | | | |
| | | | | | | | | Appraised Ob (B) Value (Bldg) | | | | | | | | |
| | | | | | | | | Appraised Land Value (Bldg) | | | | | | | | |
| | | | | | | | | Special Land Value | | | | | | | | |
| | | | | | | | | Total Appraised Parcel Value | | | | | | | | |
| | | | | | | | | Valuation Method | | | | | | | | |
| | | | | | | | | Total Appraised Parcel Value | | | | | | | | |
| | | | | | | | | 6,676,700 | | | | | | | | |
| BUILDING PERMIT RECORD | | | | | | | | VISIT / CHANGE HISTORY | | | | | | | | |
| Permit Id | Issue Date | Type | Description | Amount | Insp Date | % Comp | Date Comp | Comments | Date | Id | Type | Is | Cd | Purpost/Result | | |
| | | | | | | | | | | | | | | | | |
| LAND LINE VALUATION SECTION | | | | | | | | | | | | | | | | |
| B | Use Code | Description | Zone | LA | Land Units | Unit Price | Size Adj | AC Disc | Site Index | Cond. | Nbhd. | Nbhd. Adj | Notes | Location Adjustmen | Adj Unit P | Land Value |
| | | | | | | | | | | | | | | | | |
| Total Card Land Units | | | | | Parcel Total Land Area | | | | | Total Land Value | | | | | | |

VISION

| CONSTRUCTION DETAIL | | | | | | CONSTRUCTION DETAIL (CONTINUED) | | | | | |
|---|-----------------|---------------|------------|------------|-----------|---------------------------------|------|-------------|------------|-------------|-----|
| Element | Cd | Description | | | | Element | Cd | Description | | | |
| Style | 04 | Cape Cod | | | | | | | | | |
| Model | 01 | Residential | | | | | | | | | |
| Grade: | B+ | Custom Plus | | | | | | | | | |
| Stories | 1.75 | 1 3/4 Stories | | | | | | | | | |
| Exterior Wall 1 | 14 | Wood Shingle | | | | CONDO DATA | | | | | |
| Exterior Wall 2 | | | | | | Parcel Id | | C | | Ownr | 0.0 |
| Roof Structure | 03 | Gable/Hip | | | | | | B | | S | |
| Roof Cover | 10 | Wood Shingle | | | | Adjust Type | Code | Description | | Factor% | |
| Interior Wall 1 | 05 | Drywall | | | | Condo Flr | | | | | |
| Interior Wall 2 | 02 | Wall Brd/Wood | | | | Condo Unit | | | | | |
| Interior Floor 1 | 14 | Carpet | | | | COST / MARKET VALUATION | | | | | |
| Interior Floor 2 | 12 | Hardwood | | | | Building Value New | | | | | |
| Heat Fuel | 03 | Gas | | | | Year Built | | | | | |
| Heat Type | 04 | Hot Air | | | | Effective Year Built | | | | | |
| AC Type | 03 | Central | | | | Depreciation Code | | | | | |
| Bedrooms | 03 | 3 Bedrooms | | | | Remodel Rating | | | | | |
| Full Baths | 4 | | | | | Year Remodeled | | | | | |
| Half Baths | 0 | | | | | Depreciation % | | | | | |
| Extra Fixtures | | | | | | Functional Obsol | | | | | |
| Total Rooms | 11 | 11 Rooms | | | | External Obsol | | | | | |
| Bath Style | | | | | | Trend Factor | | | | | |
| Kitchen Style | | | | | | Condition | | | | | |
| Occupancy | | | | | | Condition % | | | | | |
| Usrflid 105 | 2 | | | | | Percent Good | | | | | |
| Accessory Apt | | | | | | RCNLD | | | | | |
| Foundation Alt | 01 | Poured Conc. | | | | Dep % Ovr | | | | | |
| Rms Prts | | | | | | Dep Ovr Comment | | | | | |
| Bath Split | 40 | 4 Full-0 Half | | | | Misc Imp Ovr | | | | | |
| | | | | | | Misc Imp Ovr Comment | | | | | |
| | | | | | | Cost to Cure Ovr | | | | | |
| | | | | | | Cost to Cure Ovr Comment | | | | | |
| OB - OUTBUILDING & YARD ITEMS(L) / XF - BUILDING EXTRA FEATURES(B) | | | | | | | | | | | |
| Code | Description | L/B | Units | Unit Price | Yr Blt | Cond. Cd | % Gd | Grade | Grade Adj. | Appr. Value | |
| WDC | Deck comp w | L | 80 | 28.00 | 2018 | | 98 | | 0.00 | 4,700 | |
| STRS | Stairs to Water | L | 12 | 122.52 | 2018 | | 98 | C | 1.00 | 1,400 | |
| BUILDING SUB-AREA SUMMARY SECTION | | | | | | | | | | | |
| Code | Description | Living Area | Floor Area | Eff Area | Unit Cost | Undeprec Value | | | | | |
| | | | | | | | | | | | |
| Ttl Gross Liv / Lease Area | | | | | | | | | | | |

| CURRENT OWNER | | TOPO | UTILITIES | STRT / ROAD | LOCATION | CURRENT ASSESSMENT | | | |
|---|--|---------|----------------|-------------|--|--------------------|-----------|-----------|-----------|
| UEHLEIN, W FREDERICK & DIANA T 109 EEL RIVER ROAD NOMINEE TRU 109 EEL RIVER RD OSTERVILLE MA 02655 | | 1 Level | 2 Public Water | 1 Paved | 7 Waterfront | Description | Code | Assessed | Assessed |
| | | | 4 Gas | | 1 Excel View | RESIDNTL | 1090 | 2,091,200 | 2,091,200 |
| | | | 6 Septic | | 9 Rear Location | RES LAND | 1090 | 4,585,500 | 4,585,500 |
| SUPPLEMENTAL DATA | | | | | | | | | |
| Alt Prcl ID Split Zonin BID Parcel ResExpt Q YES: #DL 1 LOT 1 & 2 #DL 2 GIS ID F_959434_2688563 | | | | | Plan Ref. Land Ct# 3145-U & V #SR Life Estate PP STATU Assoc Pid# | | | | |
| Total | | | | | | | 6,676,700 | 6,676,700 | |

801
FY2024
BARNSTABLE, MA

VISION

| RECORD OF OWNERSHIP | | BK-VOL/PAGE | SALE DATE | Q/U | V/I | SALE PRIC | VC | PREVIOUS ASSESSMENTS (HISTORY) | | | | | | | | | |
|----------------------------------|--|-------------|-----------|------------|-----|-----------|-----------|--------------------------------|-----------|-------|-----------|-------|-----------|-----------|------|------|-----------|
| UEHLEIN, W FREDERICK & DIANA TRS | | C180233 | 0 | 06-05-2006 | Q | I | 3,700,000 | 00 | Year | Code | Assessed | Year | Code | Assessed | Year | Code | Assessed |
| LARMON, JAY S TR | | C166755 | 0 | 10-01-2002 | U | I | 1 | 1A | 2023 | 1090 | 1,894,000 | 2022 | 1090 | 1,566,600 | 2021 | 1090 | 1,141,200 |
| LARMON, JAY S & SALLY M | | C152500 | 0 | 03-30-1999 | U | I | 1 | 1A | | 1090 | 4,168,700 | | 1090 | 3,088,100 | | 1090 | 2,850,600 |
| LARMON, JAY STANTON & SALLY M | | C117915 | 0 | 06-15-1989 | U | I | 1 | 1A | | | | | | | | 1090 | 232,000 |
| LARMON, JAY STANTON | | C99594 | 0 | 12-15-1984 | U | I | 0 | 1A | | | | | | | | | |
| Total | | | | | | | | | 6,062,700 | Total | 4,654,700 | Total | 4,223,800 | | | | |

| EXEMPTIONS | | | | OTHER ASSESSMENTS | | | |
|------------|------|-----------------------|--------|-------------------|-------------|--------|--------|
| Year | Code | Description | Amount | Code | Description | Number | Amount |
| 2023 | 5C | RESIDENTIAL EXEMPTION | 0.00 | | | | |
| Total | | | 0.00 | | | | |

This signature acknowledges a visit by a Data Collector or Assessor

| ASSESSING NEIGHBORHOOD | | | | APPRAISED VALUE SUMMARY | | | |
|------------------------|-----------|---|---------|--|--|--|--|
| Nbhd | Nbhd Name | B | Tracing | Batch | | | |
| WF09 | | | | OSTVIL | | | |
| NOTES | | | | | | | |
| | | | | Appraised Bldg. Value (Card) 1,666,800 | | | |
| | | | | Appraised Xf (B) Value (Bldg) 132,500 | | | |
| | | | | Appraised Ob (B) Value (Bldg) 291,900 | | | |
| | | | | Appraised Land Value (Bldg) 4,585,500 | | | |
| | | | | Special Land Value 0 | | | |
| | | | | Total Appraised Parcel Value 6,676,700 | | | |
| | | | | Valuation Method C | | | |
| | | | | Total Appraised Parcel Value 6,676,700 | | | |

| BUILDING PERMIT RECORD | | | | | | | | | | VISIT / CHANGE HISTORY | | | | | |
|------------------------|------------|------|-------------|--------|-----------|--------|-----------|----------|--|------------------------|----|------|----|----|-----------------------|
| Permit Id | Issue Date | Type | Description | Amount | Insp Date | % Comp | Date Comp | Comments | | Date | Id | Type | Is | Cd | Purpost/Result |
| | | | | | | | | | | 09-01-2021 | SR | 01 | 1 | 02 | Bldg Permit Completed |

| LAND LINE VALUATION SECTION | | | | | | | | | | | | | | | | | |
|-----------------------------|----------|-----------------|------|----|------------|------------|------------------------|---------|------------|-------|-------|-----------|------------------|--------------------|------------|------------|-----|
| B | Use Code | Description | Zone | LA | Land Units | Unit Price | Size Adj | AC Disc | Site Index | Cond. | Nbhd. | Nbhd. Adj | Notes | Location Adjustmen | Adj Unit P | Land Value | |
| 2 | 1090 | Multi Hses M-01 | RF-1 | 3 | 0.040 AC | 14,250.00 | 1.00000 | 1.0000 | 0 | 1.00 | | 1.000 | | 1.0000 | 14,250 | 600 | |
| Total Card Land Units | | | | | 0.04 | AC | Parcel Total Land Area | | | | | 1.04 | Total Land Value | | | | 600 |

| CONSTRUCTION DETAIL | | | CONSTRUCTION DETAIL (CONTINUED) | | |
|---------------------|------|----------------|---------------------------------|----|-------------|
| Element | Cd | Description | Element | Cd | Description |
| Style | 04 | Cape Cod | | | |
| Model | 01 | Residential | | | |
| Grade: | C | Average | | | |
| Stories | 1.75 | 1 3/4 Stories | | | |
| Exterior Wall 1 | 14 | Wood Shingle | | | |
| Exterior Wall 2 | | | | | |
| Roof Structure | 03 | Gable/Hip | | | |
| Roof Cover | 03 | Asph/F Gls/Cmp | | | |
| Interior Wall 1 | 03 | Plastered | | | |
| Interior Wall 2 | | | | | |
| Interior Floor 1 | 22 | Wide Pine | | | |
| Interior Floor 2 | | | | | |
| Heat Fuel | 03 | Gas | | | |
| Heat Type | 04 | Hot Air | | | |
| AC Type | 03 | Central | | | |
| Bedrooms | 03 | 3 Bedrooms | | | |
| Full Baths | 2 | | | | |
| Half Baths | 0 | | | | |
| Extra Fixtures | | | | | |
| Total Rooms | 6 | | | | |
| Bath Style | | | | | |
| Kitchen Style | | | | | |
| Occupancy | | | | | |
| Usrflid 105 | | | | | |
| Accessory Apt | | | | | |
| Foundation Alt | 01 | Poured Conc. | | | |
| Rms Prts | | | | | |
| Bath Split | 20 | 2 Full-0 Half | | | |

| CONDO DATA | | | | |
|-------------|------|-------------|---------|-----|
| Parcel Id | | C | Ownr | 0.0 |
| Adjust Type | Code | Description | Factor% | |
| Condo Flr | | | | |
| Condo Unit | | | | |

| COST / MARKET VALUATION | |
|--------------------------|---------|
| Building Value New | 452,279 |
| Year Built | 1957 |
| Effective Year Built | 1994 |
| Depreciation Code | VG |
| Remodel Rating | |
| Year Remodeled | |
| Depreciation % | 19 |
| Functional Obsol | |
| External Obsol | |
| Trend Factor | 1 |
| Condition | |
| Condition % | |
| Percent Good | 81 |
| RCNLD | 366,300 |
| Dep % Ovr | |
| Dep Ovr Comment | |
| Misc Imp Ovr | |
| Misc Imp Ovr Comment | |
| Cost to Cure Ovr | |
| Cost to Cure Ovr Comment | |

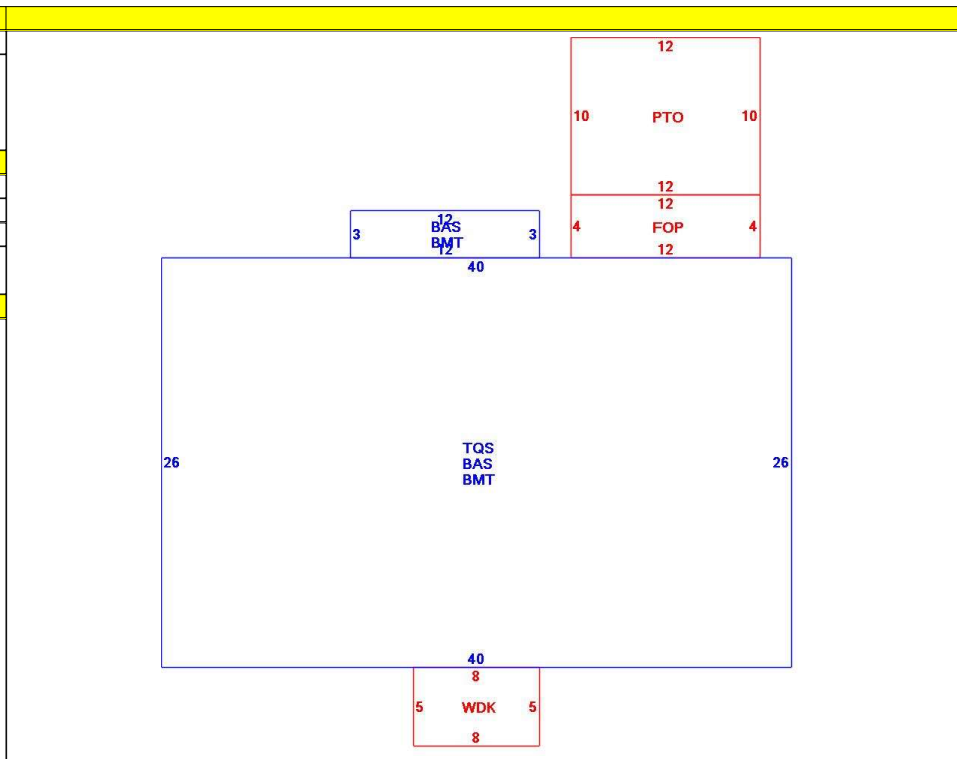

| OB - OUTBUILDING & YARD ITEMS(L) / XF - BUILDING EXTRA FEATURES(B) | | | | | | | | | | |
|--|-----------------|-----|-------|------------|--------|----------|------|-------|------------|-------------|
| Code | Description | L/B | Units | Unit Price | Yr Blt | Cond. Cd | % Gd | Grade | Grade Adj. | Appr. Value |
| FPL2 | Fireplace 1.5 s | B | 1 | 6000.00 | 1996 | | 81 | | 0.00 | 4,900 |
| FPO | Ext FP Openin | B | 1 | 2000.00 | 1996 | | 81 | | 0.00 | 1,600 |
| WDC | Wood Decking | L | 40 | 20.00 | 2001 | | 64 | | 0.00 | 1,600 |
| BMT | Basement-Unfi | B | 1,076 | 26.01 | 1996 | | 81 | | 0.00 | 22,600 |
| PATC | Conc Pavers | L | 120 | 15.46 | 2018 | | 99 | | 0.00 | 2,200 |
| FOP | Open Porch-ro | B | 48 | 55.00 | 1996 | | 81 | | 0.00 | 2,600 |
| SPL4 | POOL FIBER | L | 555 | 45.00 | 2021 | | 100 | C | 1.00 | 23,400 |
| SPC1 | Pool Cover-Au | L | 555 | 17.53 | 2021 | | 100 | | 0.00 | 9,700 |
| PATC | Conc Pavers | L | 1,853 | 15.46 | 2021 | | 100 | | 0.00 | 23,700 |
| SPH2 | Pool Heater 50 | L | 1 | 3081.00 | 2021 | | 100 | | 0.00 | 3,100 |

| BUILDING SUB-AREA SUMMARY SECTION | | | | | | |
|-----------------------------------|---------------------|-------------|------------|----------|-----------|----------------|
| Code | Description | Living Area | Floor Area | Eff Area | Unit Cost | Undeprec Value |
| BAS | First Floor | 1,076 | 1,076 | 1,076 | 258.15 | 277,769 |
| BMT | Basement Area | 0 | 1,076 | 0 | 0.00 | 0 |
| FOP | Open Porch | 0 | 48 | 0 | 0.00 | 0 |
| PTO | Patio | 0 | 120 | 0 | 0.00 | 0 |
| TQS | Three Quarter Story | 676 | 1,040 | 676 | 167.80 | 174,509 |
| WDK | Wood Deck | 0 | 40 | 0 | 0.00 | 0 |
| Ttl Gross Liv / Lease Area | | 1,752 | 3,400 | 1,752 | | 452,278 |

