

| CONSTRUCTION DETAIL | | | CONSTRUCTION DETAIL (CONTINUED) | | |
|---------------------|-------|----------------|---------------------------------|----|-------------|
| Element | Cd | Description | Element | Cd | Description |
| Style | 23 | Res Typ Com | | | |
| Model | 94 | Commercial | | | |
| Grade | C+ | Average Plus | | | |
| Stories | 2 | | | | |
| Occupancy | 1.00 | | | | |
| Exterior Wall 1 | 15 | Concr/Cinder | | | |
| Exterior Wall 2 | 18 | Asphalt | | | |
| Roof Structure | 03 | Gable/Hip | | | |
| Roof Cover | 03 | Asph/F Gls/Cmp | | | |
| Interior Wall 1 | 05 | Drywall | | | |
| Interior Wall 2 | | | | | |
| Interior Floor 1 | 14 | Carpet | | | |
| Interior Floor 2 | | | | | |
| Heating Fuel | 03 | Gas | | | |
| Heating Type | 04 | Hot Air | | | |
| AC Type | 03 | Central | | | |
| Size Adj Tbl | 3400 | OFFICE BLD M94 | | | |
| Total Rooms | | | | | |
| Bedrooms | 00 | | | | |
| Full Bathrooms | 0 | | | | |
| Bath Split | 02 | 0 Full-2 Half | | | |
| Rms/Partitions | 02 | AVERAGE | | | |
| Heat/AC | 01 | HEAT/AC PKGS | | | |
| Frame Type | 02 | WOOD FRAME | | | |
| Baths/Plumbing | 02 | AVERAGE | | | |
| Ceiling/Wall | 05 | SUS-CEIL & WL | | | |
| Common Wall | 00 | 0% | | | |
| Wall Height | 10.00 | | | | |
| 1st Floor Use: | 3161 | | | | |
| Sewer Occupan | | | | | |

| MIXED USE | | |
|-----------|----------------|------------|
| Code | Description | Percentage |
| 3400 | OFFICE BLD M94 | 100 |
| | | 0 |
| | | 0 |

| COST / MARKET VALUATION | |
|--------------------------|---------|
| RCN | 566,202 |
| Year Built | 1920 |
| Effective Year Built | 1986 |
| Depreciation Code | G |
| Remodel Rating | |
| Year Remodeled | |
| Depreciation % | 26 |
| Functional Obsol | 0 |
| External Obsol | 0 |
| Trend Factor | 1 |
| Condition | |
| Condition % | |
| Percent Good | 74 |
| RCNLD | 419,000 |
| Dep % Ovr | |
| Dep Ovr Comment | |
| Misc Imp Ovr | |
| Misc Imp Ovr Comment | |
| Cost to Cure Ovr | |
| Cost to Cure Ovr Comment | |

OB - OUTBUILDING & YARD ITEMS(L) / XF - BUILDING EXTRA FEATURES(B)

| Code | Description | L/B | Units | Unit Price | Yr Blt | Cond. Cd | % Good | Grade | Grade Adj | Appr. Value |
|------|------------------|-----|-------|------------|--------|----------|--------|-------|-----------|-------------|
| PAV1 | PAVING-ASPH | L | 4,000 | 3.00 | 1985 | | 32 | | 0.00 | 3,800 |
| TRS | Trash Encl-6' w/ | L | 1 | 3401.00 | 2019 | | 100 | | 0.00 | 3,400 |
| SGN2 | DOUBLE SIDE | L | 6 | 39.53 | 2019 | | 100 | | 0.00 | 200 |
| SGNP | SIGN POST 6" | L | 10 | 10.66 | 2019 | | 100 | | 0.00 | 100 |
| GEN1 | Large Generato | L | 1 | 29300.00 | 2019 | | 100 | | 0.00 | 29,300 |

BUILDING SUB-AREA SUMMARY SECTION

| Code | Description | Living Area | Floor Area | Eff Area | Unit Cost | Undeprec Value |
|----------------------------|-------------------|-------------|------------|----------|-----------|----------------|
| BAS | First Floor | 2,862 | 2,862 | 2,862 | 124.88 | 357,404 |
| BMT | Basement Area | 0 | 2,862 | 572 | 24.96 | 71,431 |
| FUS | Upper Story | 1,120 | 1,120 | 1,064 | 118.64 | 132,871 |
| PTO | Patio | 0 | 240 | 12 | 6.24 | 1,499 |
| UST | Utility Enclosure | 0 | 240 | 24 | 12.49 | 2,997 |
| Ttl Gross Liv / Lease Area | | 3,982 | 7,324 | 4,534 | | 566,202 |

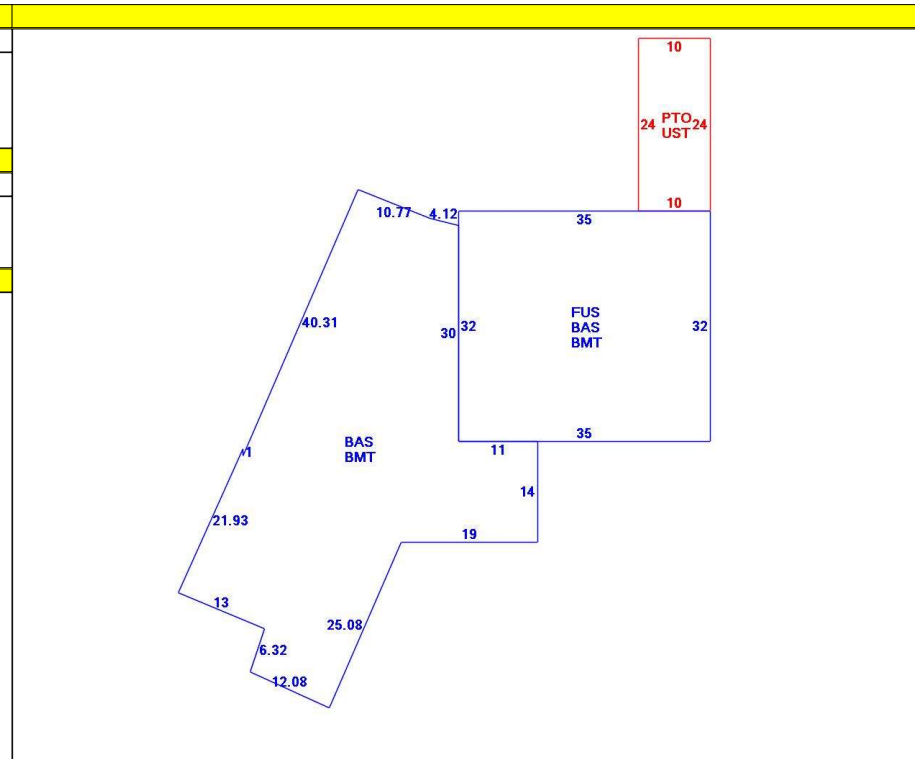

| CURRENT OWNER | | | TOPO | UTILITIES | STRT / ROAD | LOCATION | CURRENT ASSESSMENT | | | | | |
|---|--|--|------------------|-----------|-------------|------------------|--------------------|------|-----------|-----------|--|--|
| RIEDELL, SHARRON E TR 778 MAIN STREET TRUST 178 SCUDDER RD OSTERVILLE MA 02655 | | | | | | | Description | Code | Appraised | Assessed | 801 FY2024 BARNSTABLE, MA <h1 style="text-align: center;">VISION</h1> | |
| | | | | | | | COMMERC. | 332J | 171,700 | 171,700 | | |
| | | | | | | | COMMERC. | 3400 | 455,800 | 455,800 | | |
| SUPPLEMENTAL DATA | | | | | | | COM LAND | 3400 | 394,400 | 394,400 | | |
| Alt Prcl ID | | | Split Zonin | | | Plan Ref. 275/89 | | | | | | |
| #DL 1 | | | LOT A1 | | | Land Ct# | | | | | | |
| #DL 2 | | | | | | #SR | | | | | | |
| GIS ID | | | F_961324_2691622 | | | Life Estate | | | | | | |
| | | | | | | PP STATU | | | | | | |
| | | | | | | Assoc Pid# | | | | | | |
| | | | | | | | Total | | 1,021,900 | 1,021,900 | | |

| RECORD OF OWNERSHIP | | BK-VOL/PAGE | SALE DATE | Q/U | V/I | SALE PRICE | VC | PREVIOUS ASSESSMENTS (HISTORY) | | | | | | | | |
|----------------------|------|-------------|------------|-----|-----|------------|----|--------------------------------|------|-----------|-------|------|-----------|-------|------|-----------|
| RIEDEL, SHARRON E TR | 7410 | 0244 | 01-11-1991 | U | I | 1 | 1F | Year | Code | Assessed | Year | Code | Assessed | Year | Code | Assessed |
| RIEDEL, C S | 3542 | 0092 | 08-24-1982 | U | I | 20,000 | J | 2023 | 332J | 171,700 | 2022 | 332J | 240,100 | 2021 | 332J | 242,500 |
| | | | | | | | | | 3400 | 455,800 | | 3400 | 620,900 | | 3400 | 438,000 |
| | | | | | | | | | 3400 | 394,400 | | 3400 | 345,100 | | 3400 | 345,100 |
| | | | | | | | | | | | | | | | | 182,900 |
| | | | | | | | | Total | | 1,021,900 | Total | | 1,206,100 | Total | | 1,208,500 |

| EXEMPTIONS | | | | OTHER ASSESSMENTS | | | | APPRAISED VALUE SUMMARY | | | | |
|------------|------|-------------|--------|-------------------|-------------|--------|--------|--------------------------------------|---|--|--|--|
| Year | Code | Description | Amount | Code | Description | Number | Amount | Comm Int | This signature acknowledges a visit by a Data Collector or Assessor | | | |
| | | | | | | | | | Appraised Bldg. Value (Card) 558,900 | | | |
| Total | | | 0.00 | | | | | Appraised Xf (B) Value (Bldg) 31,800 | | | | |

| ASSESSING NEIGHBORHOOD | | | |
|------------------------|-----------|---|---------|
| Nbhd | Nbhd Name | B | Tracing |
| CI15 | | | OSTVIL |

| NOTES | | | |
|---|--|--|-----------|
| NEW CONSTRUCTION | | | |
| Appraised Land Value (Bldg) 394,400 Special Land Value 0 Total Appraised Parcel Value 1,021,900 Valuation Method C | | | |
| Total Appraised Parcel Value | | | 1,021,900 |

| BUILDING PERMIT RECORD | | | | | | | VISIT / CHANGE HISTORY | | | | | | | |
|------------------------|------------|------|-------------|--------|-----------|--------|------------------------|----------|------|----|------|----|----|----------------|
| Permit Id | Issue Date | Type | Description | Amount | Insp Date | % Comp | Date Comp | Comments | Date | Id | Type | Is | Cd | Purpost/Result |
| | | | | | | | | | | | | | | |

| LAND LINE VALUATION SECTION | | | | | | | | | | | | | | | | | |
|-----------------------------|----------|-------------|------|----|-----------|------------|------------|-------------------------|------------|-------|-------|----------|-------|-------------------|------------------|------------|---------|
| B | Use Code | Description | Zone | LA | Land Type | Land Units | Unit Price | I. Factor | Site Index | Cond. | Nbhd. | Nbhd Adj | Notes | Location Adjustme | Adj Unit Pric | Land Value | |
| 2 | 332J | JOB SHOP(S) | | 3 | | SF | 0.00 | 1.00000 | 5 | 1.00 | | 1.000 | | 0 | 0 | 0 | |
| Total Card Land Units | | | | | | 0.00 | AC | Parcel Total Land Area: | | | | | | 0.31 | Total Land Value | | 394,400 |

