

| CURRENT OWNER   |  | TOPO    | UTILITIES      | STRT / ROAD   | LOCATION | CURRENT ASSESSMENT |      |          |          |
|---|--|---------|----------------|---|----------|--------------------|------|----------|----------|
| KNELL, PAUL D & MCCORMICK, GAIL<br>PAUL D KNELL TRUST<br>44 BELMONT ROAD<br><br>WEST HARWIC MA 02671            |  | 1 Level | 6 Septic       | 1 Paved   |          | Description        | Code | Assessed | Assessed |
|   |  |         | 4 Gas          |   |          | RESIDNTL           | 1010 | 292,300  | 292,300  |
|   |  |         | 2 Public Water |   |          | RES LAND           | 1010 | 329,900  | 329,900  |
| <b>SUPPLEMENTAL DATA</b>  |  |         |                |   |          |                    |      |          |          |
| Alt Prcl ID<br>Split Zonin<br>BID Parcel<br>ResExpt Q<br>#DL 1 LOT 6/ LOT C<br>#DL 2<br>GIS ID F_960563_2693098 |  |         |                | Plan Ref. 97/17, 331/41<br>Land Ct#<br>#SR<br>Life Estate<br>PP STATU<br>Assoc Pid# |          |                    |      |          |          |
|   |  |         |                |   |          | Total              |      | 622,200  | 622,200  |

801  
 FY2024  
 BARNSTABLE, MA

**VISION**

| RECORD OF OWNERSHIP                |  | BK-VOL/PAGE | SALE DATE  | Q/U | V/I | SALE PRIC | VC | PREVIOUS ASSESSMENTS (HISTORY) |      |          |       |      |          |       |  |         |
|------------------------------------|--|-------------|------------|-----|-----|-----------|----|--------------------------------|------|----------|-------|------|----------|-------|--|---------|
| KNELL, PAUL D & MCCORMICK, GAIL TR |  | 33897 144   | 03-15-2021 | U   | I   | 1         | 1F | Year                           | Code | Assessed | Year  | Code | Assessed |       |  |         |
| KNELL, PAUL D                      |  | 8539 0264   | 04-26-1993 | U   | I   | 1         | 1F | 2023                           | 1010 | 256,600  | 2022  | 1010 | 223,100  |       |  |         |
| KNELL, PAUL D & MARILYN C          |  | 6380 0010   | 08-03-1988 | U   | I   | 1         | A  |                                | 1010 | 306,700  |       | 1010 | 212,100  |       |  |         |
| KNELL, PAUL D                      |  | 1733 0234   | 10-05-1972 | U   |     | 0         |    |                                |      |          |       | 1010 | 7,300    |       |  |         |
|                                    |  |             |            |     |     |           |    | Total                          |      | 563,300  | Total |      | 435,200  | Total |  | 408,900 |

| EXEMPTIONS |      |             | OTHER ASSESSMENTS |      |             |        |        |          |
|------------|------|-------------|-------------------|------|-------------|--------|--------|----------|
| Year       | Code | Description | Amount            | Code | Description | Number | Amount | Comm Int |
|            |      |             |                   |      |             |        |        |          |
|            |      |             | Total             |      |             |        | 0.00   |          |

This signature acknowledges a visit by a Data Collector or Assessor

| ASSESSING NEIGHBORHOOD |           |   |         |
|------------------------|-----------|---|---------|
| Nbhd                   | Nbhd Name | B | Tracing |
| 0109                   |           |   | OSTVIL  |

| APPRAISED VALUE SUMMARY       |         |
|-------------------------------|---------|
| Appraised Bldg. Value (Card)  | 245,900 |
| Appraised Xf (B) Value (Bldg) | 39,100  |
| Appraised Ob (B) Value (Bldg) | 7,300   |
| Appraised Land Value (Bldg)   | 329,900 |
| Special Land Value            | 0       |
| Total Appraised Parcel Value  | 622,200 |
| Valuation Method              | C       |
| Total Appraised Parcel Value  | 622,200 |

| BUILDING PERMIT RECORD |            |      |             |        |            |        |            |          | VISIT / CHANGE HISTORY |    |      |    |    |                            |
|------------------------|------------|------|-------------|--------|------------|--------|------------|----------|------------------------|----|------|----|----|----------------------------|
| Permit Id              | Issue Date | Type | Description | Amount | Insp Date  | % Comp | Date Comp  | Comments | Date                   | Id | Type | Is | Cd | Purpost/Result             |
| 201501912              | 04-10-2015 | NR   | New Roof    | 8,000  | 06-30-2015 | 100    | 06-30-2016 | RE-ROOF  | 07-08-2021             | CK | 03   |    | 16 | In Office Review           |
|                        |            |      |             |        |            |        |            |          | 05-29-2020             | WD |      |    | FR | Field Review               |
|                        |            |      |             |        |            |        |            |          | 02-24-2016             | NF | 02   |    | 03 | Cycl Insp Comp             |
|                        |            |      |             |        |            |        |            |          | 01-11-2016             | GA | 02   |    | 03 | Cycl Insp Comp             |
|                        |            |      |             |        |            |        |            |          | 11-13-2006             | PT | 02   |    | 14 | Cyclical Inspection        |
|                        |            |      |             |        |            |        |            |          | 11-16-1999             | PT | 01   |    | 00 | Meas/Listed-Interior Acces |

| LAND LINE VALUATION SECTION |          |                |      |    |            |                        |          |         |            |       |       |                  |       |                    |            |            |
|-----------------------------|----------|----------------|------|----|------------|------------------------|----------|---------|------------|-------|-------|------------------|-------|--------------------|------------|------------|
| B                           | Use Code | Description    | Zone | LA | Land Units | Unit Price             | Size Adj | AC Disc | Site Index | Cond. | Nbhd. | Nbhd. Adj        | Notes | Location Adjustmen | Adj Unit P | Land Value |
| 1                           | 1010     | Single Fam M-0 | RC   | 3  | 0.280 AC   | 176,344.00             | 3.03702  | 1.0000  | 5          | 1.00  | 0109  | 2.200            |       | 1.0000             | 1,178,224  | 329,900    |
| Total Card Land Units       |          |                |      |    | 0.28 AC    | Parcel Total Land Area |          |         |            |       | 0.28  | Total Land Value |       |                    |            | 329,900    |

| CONSTRUCTION DETAIL |    |                | CONSTRUCTION DETAIL (CONTINUED) |    |             |
|---------------------|----|----------------|---------------------------------|----|-------------|
| Element             | Cd | Description    | Element                         | Cd | Description |
| Style               | 01 | Ranch          |                                 |    |             |
| Model               | 01 | Residential    |                                 |    |             |
| Grade:              | C  | Average        |                                 |    |             |
| Stories             | 1  | 1 Story        |                                 |    |             |
| Exterior Wall 1     | 14 | Wood Shingle   |                                 |    |             |
| Exterior Wall 2     | 25 | Vinyl Siding   |                                 |    |             |
| Roof Structure      | 03 | Gable/Hip      |                                 |    |             |
| Roof Cover          | 03 | Asph/F Gls/Cmp |                                 |    |             |
| Interior Wall 1     | 05 | Drywall        |                                 |    |             |
| Interior Wall 2     |    |                |                                 |    |             |
| Interior Floor 1    | 14 | Carpet         |                                 |    |             |
| Interior Floor 2    | 12 | Hardwood       |                                 |    |             |
| Heat Fuel           | 03 | Gas            |                                 |    |             |
| Heat Type           | 05 | Hot Water      |                                 |    |             |
| AC Type             | 01 | None           |                                 |    |             |
| Bedrooms            | 03 | 3 Bedrooms     |                                 |    |             |
| Full Baths          | 2  |                |                                 |    |             |
| Half Baths          | 0  |                |                                 |    |             |
| Extra Fixtures      |    |                |                                 |    |             |
| Total Rooms         | 6  | 6 Rooms        |                                 |    |             |
| Bath Style          |    |                |                                 |    |             |
| Kitchen Style       |    |                |                                 |    |             |
| Occupancy           |    |                |                                 |    |             |
| Usrflid 105         |    |                |                                 |    |             |
| Accessory Apt       |    |                |                                 |    |             |
| Foundation Alt      | 02 | Conc. Block    |                                 |    |             |
| Rms Prts            |    |                |                                 |    |             |
| Bath Split          | 20 | 2 Full-0 Half  |                                 |    |             |

| CONDO DATA  |      |             |         |     |
|-------------|------|-------------|---------|-----|
| Parcel Id   |      | C           | Owne    | 0.0 |
| Adjust Type | Code | Description | Factor% |     |
| Condo Flr   |      |             |         |     |
| Condo Unit  |      |             |         |     |

| COST / MARKET VALUATION  |         |
|--------------------------|---------|
| Building Value New       | 336,917 |
| Year Built               | 1957    |
| Effective Year Built     | 1984    |
| Depreciation Code        | A       |
| Remodel Rating           |         |
| Year Remodeled           |         |
| Depreciation %           | 27      |
| Functional Obsol         | 0       |
| External Obsol           | 0       |
| Trend Factor             | 1       |
| Condition                |         |
| Condition %              |         |
| Percent Good             | 73      |
| RCNLD                    | 245,900 |
| Dep % Ovr                |         |
| Dep Ovr Comment          |         |
| Misc Imp Ovr             |         |
| Misc Imp Ovr Comment     |         |
| Cost to Cure Ovr         |         |
| Cost to Cure Ovr Comment |         |

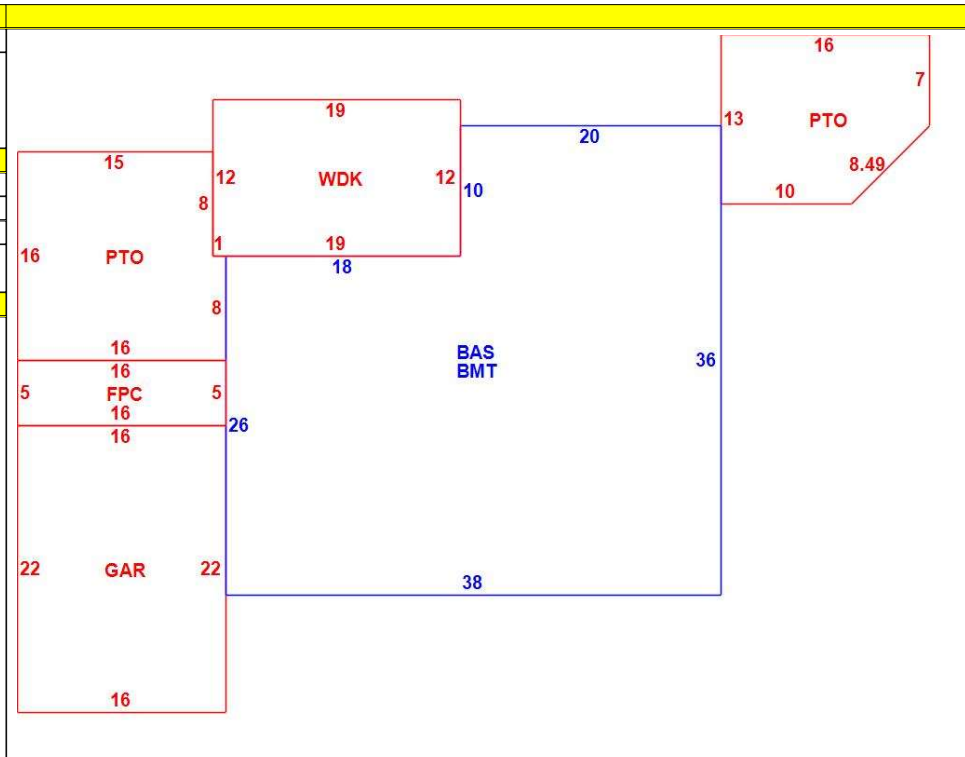

| OB - OUTBUILDING & YARD ITEMS(L) / XF - BUILDING EXTRA FEATURES(B) |                 |     |       |            |        |          |      |       |            |             |
|--|-----------------|-----|-------|------------|--------|----------|------|-------|------------|-------------|
| Code   | Description     | L/B | Units | Unit Price | Yr Blt | Cond. Cd | % Gd | Grade | Grade Adj. | Appr. Value |
| FPL1   | Fireplace 1 sto | B   | 1     | 5000.00    | 1986   |          | 73   |       | 0.00       | 3,700       |
| WDC  | Wood Decking    | L   | 228   | 20.00      | 1992   |          | 46   |       | 0.00       | 2,300       |
| PATC   | Conc Pavers     | L   | 248   | 15.46      | 1992   |          | 73   |       | 0.00       | 2,900       |
| FOPC   | Open Prch-roo   | B   | 80    | 55.00      | 1986   |          | 73   |       | 0.00       | 2,900       |
| GAR  | Attached Gara   | B   | 352   | 40.00      | 1986   |          | 73   |       | 0.00       | 10,800      |
| BMT  | Basement-Unfi   | B   | 1,188 | 26.01      | 1986   |          | 73   |       | 0.00       | 21,700      |
| PATC   | Conc Pavers     | L   | 190   | 15.46      | 1983   |          | 64   |       | 0.00       | 2,100       |

| BUILDING SUB-AREA SUMMARY SECTION |                        |             |            |          |           |                |
|-----------------------------------|------------------------|-------------|------------|----------|-----------|----------------|
| Code                              | Description            | Living Area | Floor Area | Eff Area | Unit Cost | Undeprec Value |
| BAS                               | First Floor            | 1,188       | 1,188      | 1,188    | 283.60    | 336,917        |
| BMT                               | Basement Area          | 0           | 1,188      | 0        | 0.00      | 0              |
| FPC                               | Open Porch Conc. Floor | 0           | 80         | 0        | 0.00      | 0              |
| GAR                               | Attached Garage        | 0           | 352        | 0        | 0.00      | 0              |
| PTO                               | Patio                  | 0           | 438        | 0        | 0.00      | 0              |
| WDK                               | Wood Deck              | 0           | 228        | 0        | 0.00      | 0              |
| Ttl Gross Liv / Lease Area        |                        | 1,188       | 3,474      | 1,188    |           | 336,917        |

