

| CURRENT OWNER | | TOPO | UTILITIES | STRT / ROAD | LOCATION | CURRENT ASSESSMENT | | | |
|--|--|---------|----------------|--|----------|--------------------|------|----------|----------|
| DOGGETT, EARL & ESTHER 47 LONGFELLOW ROAD WATERTOWN MA 02472 | | 1 Level | 6 Septic | 1 Paved | | Description | Code | Assessed | Assessed |
| | | | 4 Gas | | | RESIDNTL | 1010 | 396,300 | 396,300 |
| | | | 2 Public Water | | | RES LAND | 1010 | 242,800 | 242,800 |
| SUPPLEMENTAL DATA | | | | | | Total | | | |
| Alt Prcl ID Split Zonin BID Parcel ResExpt Q #DL 1 LOT 3 #DL 2 GIS ID F_960601_2696188 | | | | Plan Ref. 369/71 Land Ct# #SR Life Estate PP STATU Assoc Pid# | | 639,100 | | | |

801
 FY2024
 BARNSTABLE, MA

VISION

| RECORD OF OWNERSHIP | | BK-VOL/PAGE | SALE DATE | Q/U | V/I | SALE PRIC | VC | PREVIOUS ASSESSMENTS (HISTORY) | | | | | | | | |
|---------------------------|-------|-------------|------------|-----|-----|-----------|----|--------------------------------|------|----------|-------|------|----------|-------|--|---------|
| DOGGETT, EARL & ESTHER | 29714 | 0348 | 06-10-2016 | Q | I | 369,000 | 00 | Year | Code | Assessed | Year | Code | Assessed | | | |
| BERKELEY, ALAN D | 17044 | 0340 | 06-06-2003 | Q | I | 377,000 | 00 | 2023 | 1010 | 350,800 | 2022 | 1010 | 293,600 | | | |
| SCHANCK, NANCY A | 14679 | 0338 | 01-09-2002 | Q | I | 299,000 | 00 | | 1010 | 220,700 | | 1010 | 151,800 | | | |
| PESCE, KAREN E | 11259 | 0134 | 03-03-1998 | U | I | 0 | 1 | | | | | 1010 | 8,400 | | | |
| PESCE, EDWARD L & KAREN E | 6800 | 0325 | 07-07-1989 | U | I | 0 | | Total | | 571,500 | Total | | 445,400 | Total | | 406,600 |

| EXEMPTIONS | | | OTHER ASSESSMENTS | | | | | |
|------------|------|-------------|-------------------|------|-------------|--------|--------|----------|
| Year | Code | Description | Amount | Code | Description | Number | Amount | Comm Int |
| | | | Total | | | 0.00 | | |

This signature acknowledges a visit by a Data Collector or Assessor

| ASSESSING NEIGHBORHOOD | | | | |
|------------------------|-----------|---|---------|--------|
| Nbhd | Nbhd Name | B | Tracing | Batch |
| 0107 | | | | OSTVIL |

| APPRAISED VALUE SUMMARY | |
|-------------------------------|---------|
| Appraised Bldg. Value (Card) | 359,400 |
| Appraised Xf (B) Value (Bldg) | 28,500 |
| Appraised Ob (B) Value (Bldg) | 8,400 |
| Appraised Land Value (Bldg) | 242,800 |
| Special Land Value | 0 |
| Total Appraised Parcel Value | 639,100 |
| Valuation Method | C |
| Total Appraised Parcel Value | 639,100 |

| BUILDING PERMIT RECORD | | | | | | | | VISIT / CHANGE HISTORY | | | | | | |
|------------------------|------------|------|--------------|--------|------------|--------|------------|---------------------------|------------|----|------|----|----|------------------------|
| Permit Id | Issue Date | Type | Description | Amount | Insp Date | % Comp | Date Comp | Comments | Date | Id | Type | Is | Cd | Purpost/Result |
| 201005977 | 11-18-2010 | IN | Insulation | 4,031 | | 100 | | AIR SEAL, INSULATE, WEATH | 05-27-2020 | LS | | | FR | Field Review |
| 200904358 | 09-15-2009 | OB | Out Building | | | | | 10 X 12 SHED | 05-04-2018 | MS | 03 | | 16 | In Office Review |
| 200802364 | 05-20-2008 | WD | Wood Deck | 1,650 | 08-11-2008 | 100 | 06-30-2009 | WDK 72 S.F. | 04-06-2018 | KM | 01 | | 03 | Cycl Insp Comp |
| B25887 | 12-01-1983 | DW | Dwelling | 0 | 01-15-1986 | 100 | | OS 1 STOR | 02-19-2013 | JR | 03 | | 15 | Abatement Review |
| | | | | | | | | | 06-07-2011 | NF | 03 | | 16 | In Office Review |
| | | | | | | | | | 06-19-2009 | NF | 03 | | 52 | New Construction |
| | | | | | | | | | 08-14-2008 | MK | | | 04 | Permit/Hold as NewGrth |

| LAND LINE VALUATION SECTION | | | | | | | | | | | | | | | | | |
|-----------------------------|----------|----------------|------|----|------------|------------|------------------------|---------|------------|-------|-------|-----------|------------------|--------------------|------------|------------|---------|
| B | Use Code | Description | Zone | LA | Land Units | Unit Price | Size Adj | AC Disc | Site Index | Cond. | Nbhd. | Nbhd. Adj | Notes | Location Adjustmen | Adj Unit P | Land Value | |
| 1 | 1010 | Single Fam M-0 | RC | 3 | 0.820 | AC | 176,344.00 | 1.19913 | 1.0000 | 5 | 1.00 | 0107 | 1.400 | | 1.0000 | 296,046.3 | 242,800 |
| Total Card Land Units | | | | | 0.82 | AC | Parcel Total Land Area | | | | | 0.82 | Total Land Value | | | | 242,800 |

| CONSTRUCTION DETAIL | | | CONSTRUCTION DETAIL (CONTINUED) | | |
|---------------------|-----|----------------|---------------------------------|----|-------------|
| Element | Cd | Description | Element | Cd | Description |
| Style | 04 | Cape Cod | | | |
| Model | 01 | Residential | | | |
| Grade: | C | Average | | | |
| Stories | 1.5 | 1 1/2 Stories | | | |
| Exterior Wall 1 | 14 | Wood Shingle | | | |
| Exterior Wall 2 | 11 | Clapboard | | | |
| Roof Structure | 03 | Gable/Hip | | | |
| Roof Cover | 03 | Asph/F Gls/Cmp | | | |
| Interior Wall 1 | 03 | Plastered | | | |
| Interior Wall 2 | | | | | |
| Interior Floor 1 | 09 | Pine/Soft Wood | | | |
| Interior Floor 2 | | | | | |
| Heat Fuel | 04 | Electric | | | |
| Heat Type | 07 | Elec Baseboard | | | |
| AC Type | 03 | Central | | | |
| Bedrooms | 03 | 3 Bedrooms | | | |
| Full Baths | 2 | | | | |
| Half Baths | 0 | | | | |
| Extra Fixtures | | | | | |
| Total Rooms | 6 | 6 Rooms | | | |
| Bath Style | | | | | |
| Kitchen Style | | | | | |
| Occupancy | | | | | |
| Usrflid 105 | | | | | |
| Accessory Apt | | | | | |
| Foundation Alt | 01 | Poured Conc. | | | |
| Rms Prts | | | | | |
| Bath Split | 20 | 2 Full-0 Half | | | |

| CONDO DATA | | | |
|-------------|------|-------------|----------|
| Parcel Id | | C | Ownr 0.0 |
| | | B | S |
| Adjust Type | Code | Description | Factor% |
| Condo Flr | | | |
| Condo Unit | | | |

| COST / MARKET VALUATION | |
|--------------------------|---------|
| Building Value New | 427,798 |
| Year Built | 1984 |
| Effective Year Built | 1998 |
| Depreciation Code | A |
| Remodel Rating | |
| Year Remodeled | |
| Depreciation % | 16 |
| Functional Obsol | 0 |
| External Obsol | 0 |
| Trend Factor | 1 |
| Condition | |
| Condition % | |
| Percent Good | 84 |
| RCNLD | 359,400 |
| Dep % Ovr | |
| Dep Ovr Comment | |
| Misc Imp Ovr | |
| Misc Imp Ovr Comment | |
| Cost to Cure Ovr | |
| Cost to Cure Ovr Comment | |

OB - OUTBUILDING & YARD ITEMS(L) / XF - BUILDING EXTRA FEATURES(B)

| Code | Description | L/B | Units | Unit Price | Yr Blt | Cond. Cd | % Gd | Grade | Grade Adj. | Appr. Value |
|------|-----------------|-----|-------|------------|--------|----------|------|-------|------------|-------------|
| FPL2 | Fireplace 1.5 s | B | 1 | 6000.00 | 2000 | | 84 | | 0.00 | 5,000 |
| SHED | Shed | L | 208 | 18.00 | 1990 | | 42 | | 0.00 | 1,600 |
| WDC | Wood Decking | L | 240 | 20.00 | 1999 | | 60 | | 0.00 | 3,100 |
| WDC | Wood Decking | L | 72 | 20.00 | 1999 | | 60 | | 0.00 | 2,000 |
| BMT | Basement-Unfi | B | 1,080 | 26.01 | 2000 | | 84 | | 0.00 | 23,500 |
| SHED | Shed | L | 96 | 18.00 | 2017 | | 96 | | 0.00 | 1,700 |

BUILDING SUB-AREA SUMMARY SECTION

| Code | Description | Living Area | Floor Area | Eff Area | Unit Cost | Undeprec Value |
|----------------------------|---------------------|-------------|------------|----------|-----------|----------------|
| BAS | First Floor | 1,080 | 1,080 | 1,080 | 261.81 | 282,755 |
| BMT | Basement Area | 0 | 1,080 | 0 | 0.00 | 0 |
| FHS | Half Story | 182 | 364 | 182 | 130.91 | 47,649 |
| TQS | Three Quarter Story | 372 | 572 | 372 | 170.27 | 97,393 |
| WDK | Wood Deck | 0 | 312 | 0 | 0.00 | 0 |
| Ttl Gross Liv / Lease Area | | 1,634 | 3,408 | 1,634 | | 427,797 |

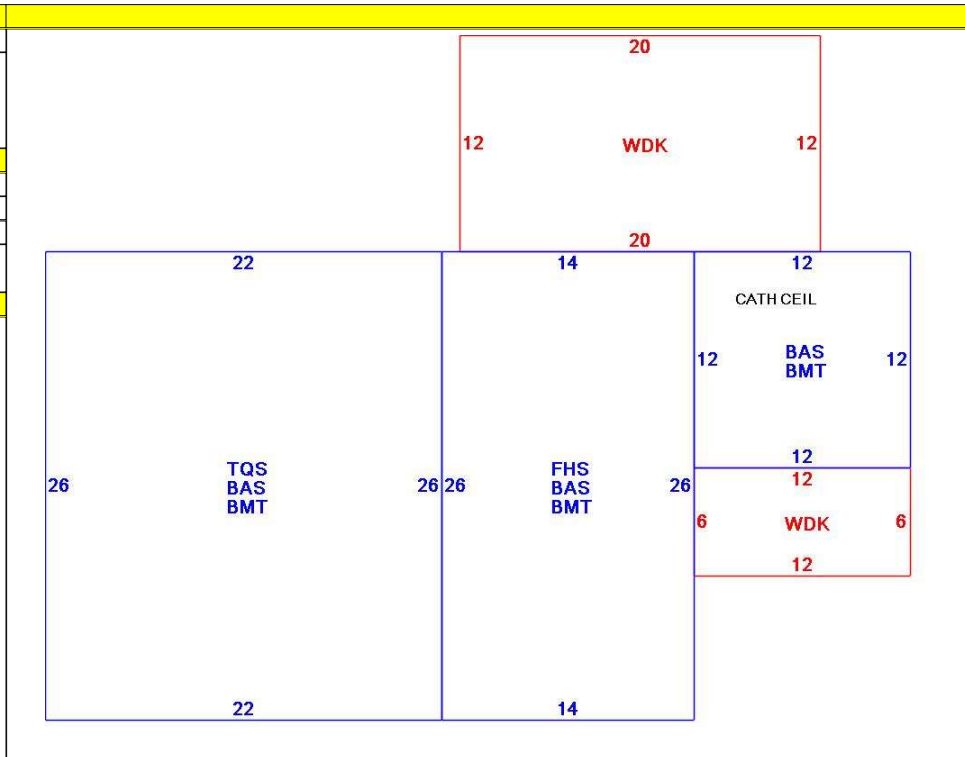

4.4.2018