

| CURRENT OWNER | | TOPO | UTILITIES | STRT / ROAD | LOCATION | CURRENT ASSESSMENT | | | | 801 FY2024 BARNSTABLE, MA VISION | | | | | | |
|---|------------|--|-------------------|-------------|-------------|--|---|-------------------------------------|------------|--|-------|-----------|------------------|--------------------|-----------------------|------------|
| ALLEN, LEA R 22 ACORN DRIVE OSTERVILLE MA 02655 | | | | | | Description | Code | Assessed | Assessed | | | | | | | |
| | | SUPPLEMENTAL DATA | | | | RESIDENTL | 1010 | 449,000 | 449,000 | | | | | | | |
| | | Alt Prcl ID Split Zonin BID Parcel ResExpt Q #DL 1 LOT 5 #DL 2 GIS ID F_960899_2697529 | | | | Plan Ref. 187/93 Land Ct# #SR Life Estate PP STATU Assoc Pid# | RES LAND | 1010 | 151,600 | | | 151,600 | | | | |
| | | | | | | Total | | 600,600 | 600,600 | | | | | | | |
| RECORD OF OWNERSHIP | | BK-VOL/PAGE | SALE DATE | Q/U | V/I | SALE PRIC | VC | PREVIOUS ASSESSMENTS (HISTORY) | | | | | | | | |
| ALLEN, LEA R | | 28299 0204 | 08-01-2014 | Q | I | 335,000 | 00 | Year | Code | Assessed | Year | Code | Assessed | | | |
| HALLETT, KATHLEEN & ROBERT H | | 24599 0133 | 06-04-2010 | U | I | 190,000 | 1S | 2023 | 1010 | 386,600 | 2022 | 1010 | 333,900 | | | |
| US BANK NATIONAL ASSOCIATION TR | | 24599 0128 | 06-04-2010 | U | I | 0 | 1L | | 1010 | 137,800 | | 1010 | 102,100 | | | |
| US BANK NATIONAL ASSOCIATION TR | | 24545 0229 | 05-12-2010 | U | I | 225,325 | 1L | | | | | 1010 | 4,400 | | | |
| KERIG, BARBARA S | | 21413 0254 | 10-06-2006 | U | I | 288,000 | 1A | Total | | 524,400 | Total | | 436,000 | | | |
| | | | | | | | | Total | | | Total | | 376,600 | | | |
| EXEMPTIONS | | | OTHER ASSESSMENTS | | | | This signature acknowledges a visit by a Data Collector or Assessor | | | | | | | | | |
| Year | Code | Description | Amount | Code | Description | Number | Amount | Comm Int | | | | | | | | |
| | | | | | | | | | | | | | | | | |
| Total | | | 0.00 | | | | | | | | | | | | | |
| ASSESSING NEIGHBORHOOD | | | | | | | | | | | | | | | | |
| Nbhd | Nbhd Name | B | Tracing | Batch | | | | | | | | | | | | |
| 0105 | | | | OSTVIL | | | | | | | | | | | | |
| NOTES | | | | | | | | | | | | | | | | |
| | | | | | | | | | | | | | | | | |
| BUILDING PERMIT RECORD | | | | | | | | VISIT / CHANGE HISTORY | | | | | | | | |
| Permit Id | Issue Date | Type | Description | Amount | Insp Date | % Comp | Date Comp | Comments | Date | Id | Type | Is | Cd | Purpost/Result | | |
| 201002917 | 06-22-2010 | RE | Remodel | 35,000 | 09-16-2010 | 100 | 06-30-2011 | KIT & BTHRM; WINDOW REP OS ADD'N | 05-26-2020 | LS | | | FR | Field Review | | |
| B17929 | 09-01-1975 | AD | Addition | 0 | 01-15-1976 | 100 | | | 05-21-2018 | MS | 03 | | | 16 | In Office Review | |
| | | | | | | | | | 01-31-2017 | KM | 02 | | | 03 | Cycl Insp Comp | |
| | | | | | | | | | 08-27-2012 | DR | 22 | | | 22 | Change of Address | |
| | | | | | | | | | 08-20-2012 | DR | 03 | | | 16 | In Office Review | |
| | | | | | | | | | 08-08-2012 | LH | 03 | | | 16 | In Office Review | |
| | | | | | | | | | 01-11-2011 | RB | 03 | | | 02 | Bldg Permit Completed | |
| LAND LINE VALUATION SECTION | | | | | | | | | | | | | | | | |
| B | Use Code | Description | Zone | LA | Land Units | Unit Price | Size Adj | AC Disc | Site Index | Cond. | Nbhd. | Nbhd. Adj | Notes | Location Adjustmen | Adj Unit P | Land Value |
| 1 | 1010 | Single Fam M-0 | RC | 3 | 0.330 AC | 176,344.00 | 2.60499 | 1.0000 | 5 | 1.00 | 0105 | 1.000 | | 1.0000 | 459,376.1 | 151,600 |
| Total Card Land Units | | | | | 0.33 | AC | Parcel Total Land Area | | | | | 0.33 | Total Land Value | | | 151,600 |

| CONSTRUCTION DETAIL | | | CONSTRUCTION DETAIL (CONTINUED) | | |
|---------------------|----|----------------|---------------------------------|----|-------------|
| Element | Cd | Description | Element | Cd | Description |
| Style | 01 | Ranch | | | |
| Model | 01 | Residential | | | |
| Grade: | C | Average | | | |
| Stories | 1 | 1 Story | | | |
| Exterior Wall 1 | 11 | Clapboard | | | |
| Exterior Wall 2 | 06 | Vertical Sidin | | | |
| RooF Structure | 03 | Gable/Hip | | | |
| RooF Cover | 03 | Asph/F Gls/Cmp | | | |
| Interior Wall 1 | 05 | Drywall | | | |
| Interior Wall 2 | | | | | |
| Interior Floor 1 | 12 | Hardwood | | | |
| Interior Floor 2 | | | | | |
| Heat Fuel | 03 | Gas | | | |
| Heat Type | 05 | Hot Water | | | |
| AC Type | 03 | Central | | | |
| Bedrooms | 04 | 4 Bedrooms | | | |
| Full Baths | 2 | | | | |
| Half Baths | 0 | | | | |
| Extra Fixtures | | | | | |
| Total Rooms | 7 | 7 Rooms | | | |
| Bath Style | | | | | |
| Kitchen Style | | | | | |
| Occupancy | | | | | |
| Usrflid 105 | | | | | |
| Accessory Apt | | | | | |
| Foundation Alt | 08 | Mixed | | | |
| Rms Prts | | | | | |
| Bath Split | 20 | 2 Full-0 Half | | | |

| CONDO DATA | | | |
|-------------|------|-------------|----------|
| Parcel Id | | C | Owne 0.0 |
| | | B | S |
| Adjust Type | Code | Description | Factor% |
| Condo Flr | | | |
| Condo Unit | | | |

| COST / MARKET VALUATION | |
|--------------------------|---------|
| Building Value New | 467,406 |
| Year Built | 1964 |
| Effective Year Built | 1998 |
| Depreciation Code | VG |
| Remodel Rating | |
| Year Remodeled | |
| Depreciation % | 16 |
| Functional Obsol | 0 |
| External Obsol | 0 |
| Trend Factor | 1 |
| Condition | |
| Condition % | |
| Percent Good | 84 |
| RCNLD | 392,600 |
| Dep % Ovr | |
| Dep Ovr Comment | |
| Misc Imp Ovr | |
| Misc Imp Ovr Comment | |
| Cost to Cure Ovr | |
| Cost to Cure Ovr Comment | |

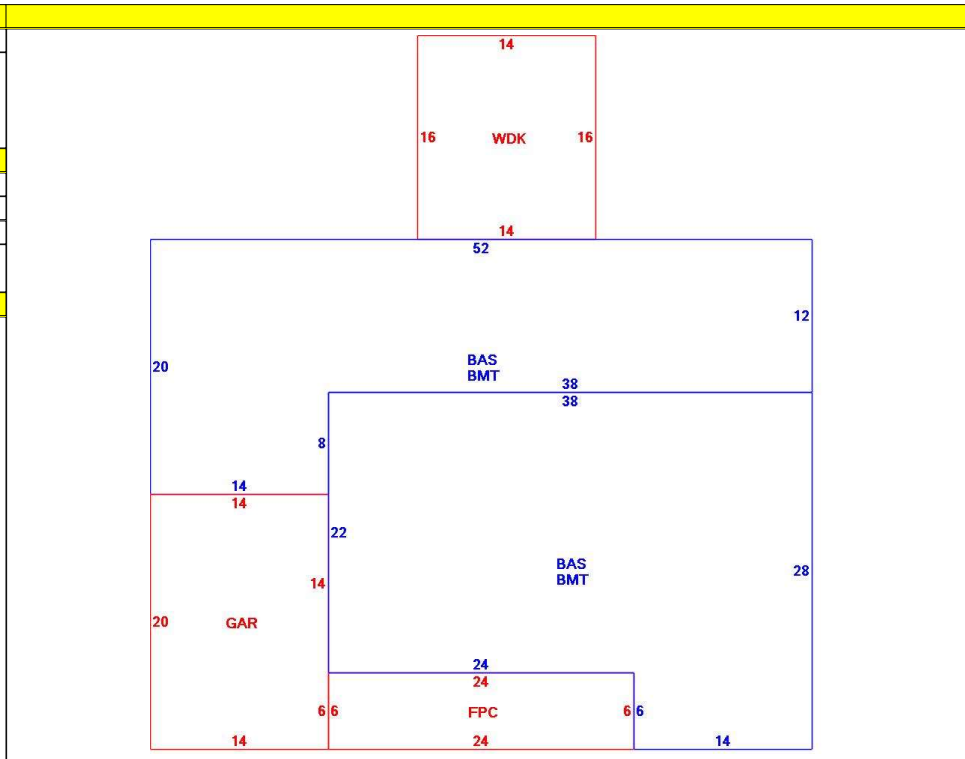

| OB - OUTBUILDING & YARD ITEMS(L) / XF - BUILDING EXTRA FEATURES(B) | | | | | | | | | | |
|--|-----------------|-----|-------|------------|--------|----------|------|-------|------------|-------------|
| Code | Description | L/B | Units | Unit Price | Yr Blt | Cond. Cd | % Gd | Grade | Grade Adj. | Appr. Value |
| FPL1 | Fireplace 1 sto | B | 1 | 5000.00 | 2000 | | 84 | | 0.00 | 4,200 |
| FOPC | Open Prch-roo | B | 144 | 55.00 | 2000 | | 84 | | 0.00 | 5,000 |
| GAR | Attached Gara | B | 280 | 40.00 | 2000 | | 84 | | 0.00 | 10,700 |
| BMT | Basement-Unfi | B | 1,656 | 26.01 | 2000 | | 84 | | 0.00 | 32,100 |
| WDC | Wood Deck w/ | L | 224 | 18.00 | 2017 | | 96 | | 0.00 | 4,400 |

| BUILDING SUB-AREA SUMMARY SECTION | | | | | | |
|-----------------------------------|------------------------|-------------|------------|----------|-----------|----------------|
| Code | Description | Living Area | Floor Area | Eff Area | Unit Cost | Undeprec Value |
| BAS | First Floor | 1,656 | 1,656 | 1,656 | 282.25 | 467,406 |
| BMT | Basement Area | 0 | 1,656 | 0 | 0.00 | 0 |
| FPC | Open Porch Conc. Floor | 0 | 144 | 0 | 0.00 | 0 |
| GAR | Attached Garage | 0 | 280 | 0 | 0.00 | 0 |
| WDC | Wood Deck | 0 | 224 | 0 | 0.00 | 0 |
| Ttl Gross Liv / Lease Area | | 1,656 | 3,960 | 1,656 | | 467,406 |

