

| CURRENT OWNER   |         | TOPO                | UTILITIES | STRT / ROAD      | LOCATION | CURRENT ASSESSMENT |      |          |          | 801<br>FY2024<br>BARNSTABLE, MA<br><br><b>VISION</b> |
|---|---------|---------------------|-----------|------------------|----------|--------------------|------|----------|----------|--|
| KADISH, SIDNEY & HELEN<br><br>121 HIGHLAND ST<br><br>WEST NEWTON MA 02465 | 1 Level | 2 Public Water      | 3 Unpaved |                  |          | Description        | Code | Assessed | Assessed |  |
|   |         | 4 Gas               |           |                  |          | RESIDNTL           | 1010 | 656,400  | 656,400  |  |
|   |         | 6 Septic            |           |                  |          | RES LAND           | 1010 | 232,100  | 232,100  |  |
| <b>SUPPLEMENTAL DATA</b>  |         |                     |           |                  |          | Total              |      |          |          | 888,500  |
| Alt Prcl ID   |         | Split Zonin         |           | Plan Ref. 19/143 |          |                    |      |          |          |  |
| BID Parcel  |         | ResExpt Q           |           | Land Ct#         |          |                    |      |          |          |  |
| #DL 1   |         | LOTS 48C, 48D & UNK |           | #SR              |          |                    |      |          |          |  |
| #DL 2   |         |                     |           | Life Estate      |          |                    |      |          |          |  |
| GIS ID  |         | F_943405_2686587    |           | PP STATU         |          |                    |      |          |          |  |
|   |         |                     |           | Assoc Pid#       |          |                    |      |          |          |  |

| RECORD OF OWNERSHIP          |       | BK-VOL/PAGE | SALE DATE  | Q/U | V/I | SALE PRIC | VC | PREVIOUS ASSESSMENTS (HISTORY) |       |          |         |       |          |         |      |          |
|------------------------------|-------|-------------|------------|-----|-----|-----------|----|--------------------------------|-------|----------|---------|-------|----------|---------|------|----------|
| KADISH, SIDNEY & HELEN       | 20952 | 0227        | 04-28-2006 | Q   | I   | 615,000   | 00 | Year                           | Code  | Assessed | Year    | Code  | Assessed | Year    | Code | Assessed |
| PRESCOTT, WILLIAM R & BRENDA | 12111 | 0067        | 03-08-1999 | U   | I   | 362,000   | 3  | 2023                           | 1010  | 582,000  | 2022    | 1010  | 493,800  | 2021    | 1010 | 422,700  |
| WEINSTEIN, JOSEPH            | 11047 | 0302        | 11-05-1997 | Q   | V   | 44,500    | 00 |                                | 1010  | 211,000  |         | 1010  | 145,100  |         | 1010 | 147,400  |
| JAMES, LOIS K                | 4740  | 0268        | 10-15-1985 | Q   | V   | 33,000    | U  |                                |       |          |         |       |          |         |      |          |
| CRAWFORD, ARTHUR C           | 1354  | 0407        | 12-19-1966 | U   |     | 0         |    |                                |       |          |         |       |          |         |      |          |
| Total                        |       |             |            |     |     |           |    | 793,000                        | Total |          | 638,900 | Total |          | 573,100 |      |          |

| EXEMPTIONS |      |             |        | OTHER ASSESSMENTS |             |        |        | This signature acknowledges a visit by a Data Collector or Assessor |  |  |  |  |  |  |  |  |
|------------|------|-------------|--------|-------------------|-------------|--------|--------|---|--|--|--|--|--|--|--|--|
| Year       | Code | Description | Amount | Code              | Description | Number | Amount | Comm Int  |  |  |  |  |  |  |  |  |
| Total      |      |             | 0.00   |                   |             |        |        |   |  |  |  |  |  |  |  |  |

| ASSESSING NEIGHBORHOOD |           |   |         | APPRAISED VALUE SUMMARY       |                              |         |  |
|------------------------|-----------|---|---------|-------------------------------|------------------------------|---------|--|
| Nbhd                   | Nbhd Name | B | Tracing | Batch                         |                              |         |  |
| 0107                   |           |   | COTUIT  |                               | Appraised Bldg. Value (Card) | 588,100 |  |
|                        |           |   |         | Appraised Xf (B) Value (Bldg) | 65,300                       |         |  |
|                        |           |   |         | Appraised Ob (B) Value (Bldg) | 3,000                        |         |  |
|                        |           |   |         | Appraised Land Value (Bldg)   | 232,100                      |         |  |
|                        |           |   |         | Special Land Value            | 0                            |         |  |
|                        |           |   |         | Total Appraised Parcel Value  | 888,500                      |         |  |
|                        |           |   |         | Valuation Method              | C                            |         |  |
|                        |           |   |         | Total Appraised Parcel Value  | 888,500                      |         |  |

| NOTES     |            |      |             |         |            |        |            |          | VISIT / CHANGE HISTORY |    |      |    |    |                   |  |
|-----------|------------|------|-------------|---------|------------|--------|------------|----------|------------------------|----|------|----|----|-------------------|--|
| Permit Id | Issue Date | Type | Description | Amount  | Insp Date  | % Comp | Date Comp  | Comments | Date                   | Id | Type | Is | Cd | Purpost/Result    |  |
| 27051     | 11-12-1997 | DW   | Dwelling    | 119,000 | 07-09-1998 | 100    | 01-01-1999 | NW DW    | 09-01-2021             | CK | 02   |    | 03 | Cycl Insp Comp    |  |
|           |            |      |             |         |            |        |            |          | 06-10-2020             | WD |      |    | FR | Field Review      |  |
|           |            |      |             |         |            |        |            |          | 03-09-2015             | JR | 03   |    | 03 | Cycl Insp Comp    |  |
|           |            |      |             |         |            |        |            |          | 02-22-2013             | RB | 03   |    | 03 | Cycl Insp Comp    |  |
|           |            |      |             |         |            |        |            |          | 11-22-2006             | JK | 22   |    | 22 | Change of Address |  |
|           |            |      |             |         |            |        |            |          | 03-29-2005             | PT | 02   |    | 01 | Meas/Est          |  |
|           |            |      |             |         |            |        |            |          | 08-20-2002             | PT | 02   |    | 01 | Meas/Est          |  |

| LAND LINE VALUATION SECTION |          |                |      |    |            |            |                        |         |            |       |       |           |                  |                    |            |            |         |
|-----------------------------|----------|----------------|------|----|------------|------------|------------------------|---------|------------|-------|-------|-----------|------------------|--------------------|------------|------------|---------|
| B                           | Use Code | Description    | Zone | LA | Land Units | Unit Price | Size Adj               | AC Disc | Site Index | Cond. | Nbhd. | Nbhd. Adj | Notes            | Location Adjustmen | Adj Unit P | Land Value |         |
| 1                           | 1010     | Single Fam M-0 | RF   | 2  | 0.610      | AC         | 176,344.00             | 1.54133 | 1.0000     | 5     | 1.00  | 0107      | 1.400            |                    | 1.0000     | 380,532.7  | 232,100 |
| Total Card Land Units       |          |                |      |    | 0.61       | AC         | Parcel Total Land Area |         |            |       |       | 0.61      | Total Land Value |                    |            | 232,100    |         |

| CONSTRUCTION DETAIL |      |                | CONSTRUCTION DETAIL (CONTINUED) |    |             |
|---------------------|------|----------------|---------------------------------|----|-------------|
| Element             | Cd   | Description    | Element                         | Cd | Description |
| Style               | 04   | Cape Cod       |                                 |    |             |
| Model               | 01   | Residential    |                                 |    |             |
| Grade:              | C+   | Average Plus   |                                 |    |             |
| Stories             | 1.75 | 1 3/4 Stories  |                                 |    |             |
| Exterior Wall 1     | 11   | Clapboard      |                                 |    |             |
| Exterior Wall 2     | 14   | Wood Shingle   |                                 |    |             |
| RooF Structure      | 03   | Gable/Hip      |                                 |    |             |
| RooF Cover          | 03   | Asph/F Gls/Cmp |                                 |    |             |
| Interior Wall 1     | 05   | Drywall        |                                 |    |             |
| Interior Wall 2     |      |                |                                 |    |             |
| Interior Floor 1    | 12   | Hardwood       |                                 |    |             |
| Interior Floor 2    |      |                |                                 |    |             |
| Heat Fuel           | 03   | Gas            |                                 |    |             |
| Heat Type           | 05   | Hot Water      |                                 |    |             |
| AC Type             | 03   | Central        |                                 |    |             |
| Bedrooms            | 04   | 4 Bedrooms     |                                 |    |             |
| Full Baths          | 2    |                |                                 |    |             |
| Half Baths          | 1    |                |                                 |    |             |
| Extra Fixtures      |      |                |                                 |    |             |
| Total Rooms         | 9    | 9 Rooms        |                                 |    |             |
| Bath Style          |      |                |                                 |    |             |
| Kitchen Style       |      |                |                                 |    |             |
| Occupancy           |      |                |                                 |    |             |
| Usrflid 105         |      |                |                                 |    |             |
| Accessory Apt       |      |                |                                 |    |             |
| Foundation Alt      | 01   | Poured Conc.   |                                 |    |             |
| Rms Prts            |      |                |                                 |    |             |
| Bath Split          | 21   | 2 Full-1 Half  |                                 |    |             |

| CONDO DATA  |      |             |         |     |
|-------------|------|-------------|---------|-----|
| Parcel Id   |      | C           | Owne    | 0.0 |
| Adjust Type | Code | Description | Factor% |     |
| Condo Flr   |      |             |         |     |
| Condo Unit  |      |             |         |     |

| COST / MARKET VALUATION  |  |         |
|--------------------------|--|---------|
| Building Value New       |  | 660,743 |
| Year Built               |  | 1998    |
| Effective Year Built     |  | 2005    |
| Depreciation Code        |  | A       |
| Remodel Rating           |  |         |
| Year Remodeled           |  |         |
| Depreciation %           |  | 11      |
| Functional Obsol         |  | 0       |
| External Obsol           |  | 0       |
| Trend Factor             |  | 1       |
| Condition                |  |         |
| Condition %              |  |         |
| Percent Good             |  | 89      |
| RCNLD                    |  | 588,100 |
| Dep % Ovr                |  |         |
| Dep Ovr Comment          |  |         |
| Misc Imp Ovr             |  |         |
| Misc Imp Ovr Comment     |  |         |
| Cost to Cure Ovr         |  |         |
| Cost to Cure Ovr Comment |  |         |

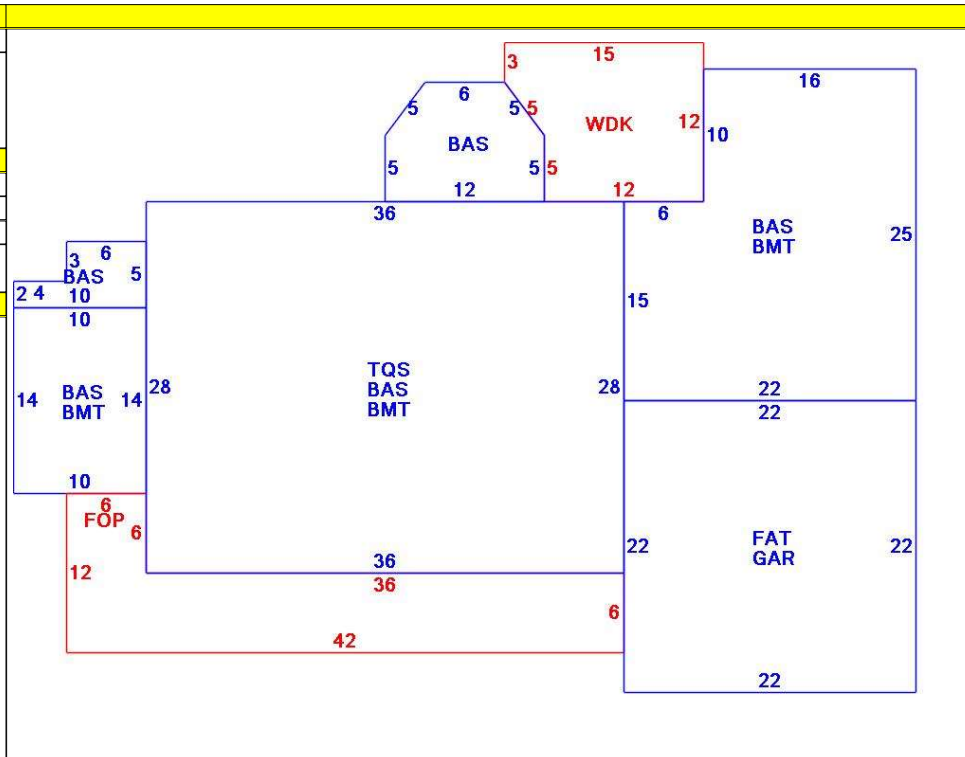

| OB - OUTBUILDING & YARD ITEMS(L) / XF - BUILDING EXTRA FEATURES(B) |                 |     |       |            |        |          |      |       |            |             |
|--|-----------------|-----|-------|------------|--------|----------|------|-------|------------|-------------|
| Code   | Description     | L/B | Units | Unit Price | Yr Blt | Cond. Cd | % Gd | Grade | Grade Adj. | Appr. Value |
| FPL2   | Fireplace 1.5 s | B   | 1     | 6000.00    | 2007   |          | 89   |       | 0.00       | 5,300       |
| WDC  | Wood Decking    | L   | 159   | 20.00      | 2004   |          | 70   |       | 0.00       | 3,000       |
| FOP  | Open Porch-ro   | B   | 288   | 55.00      | 2007   |          | 89   |       | 0.00       | 10,200      |
| GAR  | Attached Gara   | B   | 484   | 40.00      | 2007   |          | 89   |       | 0.00       | 16,100      |
| BMT  | Basement-Unfi   | B   | 1,638 | 26.01      | 2007   |          | 89   |       | 0.00       | 33,700      |

| BUILDING SUB-AREA SUMMARY SECTION |                     |             |            |          |           |                |
|-----------------------------------|---------------------|-------------|------------|----------|-----------|----------------|
| Code                              | Description         | Living Area | Floor Area | Eff Area | Unit Cost | Undeprec Value |
| BAS                               | First Floor         | 1,772       | 1,772      | 1,772    | 264.30    | 468,334        |
| BMT                               | Basement Area       | 0           | 1,638      | 0        | 0.00      | 0              |
| FAT                               | Attic, Finished     | 73          | 484        | 73       | 39.86     | 19,294         |
| FOP                               | Open Porch          | 0           | 288        | 0        | 0.00      | 0              |
| GAR                               | Attached Garage     | 0           | 484        | 0        | 0.00      | 0              |
| TQS                               | Three Quarter Story | 655         | 1,008      | 655      | 171.74    | 173,115        |
| WDK                               | Wood Deck           | 0           | 159        | 0        | 0.00      | 0              |
| Ttl Gross Liv / Lease Area        |                     | 2,500       | 5,833      | 2,500    |           | 660,743        |

