

| CURRENT OWNER | | TOPO | UTILITIES | STRT / ROAD | LOCATION | CURRENT ASSESSMENT | | | | 801 FY2024 BARNSTABLE, MA VISION |
|---------------------------|--------------------------|----------|------------------|-------------|----------|--------------------|------|----------|----------|--|
| LIPNER, NORMAN D & RHEA C | 1 Level | 6 Septic | 1 Paved | | | Description | Code | Assessed | Assessed | |
| | | 4 Gas | | | | RESIDNTL | 1010 | 423,900 | 423,900 | |
| 17 THATCHER HOLWAY RD | SUPPLEMENTAL DATA | | | | | RES LAND | 1010 | 156,800 | 156,800 | |
| MARSTONS MIL MA 02648 | Alt Prcl ID | | Plan Ref. 287/27 | | | Total | | 580,700 | 580,700 | |
| | Split Zonin | | Land Ct# | | | | | | | |
| | BID Parcel | | #SR | | | | | | | |
| | ResExpt Q YES: | | Life Estate | | | | | | | |
| | #DL 1 LOT 13 | | PP STATU | | | | | | | |
| | #DL 2 | | Assoc Pid# | | | | | | | |
| | GIS ID F_961191_2704591 | | | | | | | | | |

| RECORD OF OWNERSHIP | | BK-VOL/PAGE | SALE DATE | Q/U | V/I | SALE PRIC | VC | PREVIOUS ASSESSMENTS (HISTORY) | | | | | |
|--------------------------------|-------|-------------|------------|-----|-----|-----------|----|--------------------------------|------|----------|-------|------|----------|
| LIPNER, NORMAN D & RHEA C | 17176 | 0346 | 06-30-2003 | Q | I | 339,500 | 00 | Year | Code | Assessed | Year | Code | Assessed |
| KEATING, CAROLYN C | 10589 | 0121 | 01-29-1997 | | | 0 | | 2023 | 1010 | 337,300 | 2022 | 1010 | 317,300 |
| KEATING, WILLIAM F & CAROLYN C | 6610 | 0135 | 01-15-1989 | Q | I | 187,000 | U | | 1010 | 142,600 | | 1010 | 105,600 |
| | | | | | | | | Total | | 479,900 | Total | | 422,900 |
| | | | | | | | | Total | | | Total | | 383,100 |

| EXEMPTIONS | | OTHER ASSESSMENTS | | | | | | |
|------------|------|-----------------------|--------|------|-------------|--------|--------|----------|
| Year | Code | Description | Amount | Code | Description | Number | Amount | Comm Int |
| 2024 | 5C | RESIDENTIAL EXEMPTION | | | | | | |
| Total | | | 0.00 | | | | | |

| ASSESSING NEIGHBORHOOD | | | | VISIT / CHANGE HISTORY | | | | |
|------------------------|-----------|---|---------|---|--|--|--|--|
| Nbhd | Nbhd Name | B | Tracing | Batch | | | | |
| 0105 | | | | MARSTM | | | | |
| NOTES | | | | This signature acknowledges a visit by a Data Collector or Assessor | | | | |
| | | | | APPRAISED VALUE SUMMARY | | | | |
| | | | | Appraised Bldg. Value (Card) 354,100 | | | | |
| | | | | Appraised Xf (B) Value (Bldg) 55,400 | | | | |
| | | | | Appraised Ob (B) Value (Bldg) 14,400 | | | | |
| | | | | Appraised Land Value (Bldg) 156,800 | | | | |
| | | | | Special Land Value 0 | | | | |
| | | | | Total Appraised Parcel Value 580,700 | | | | |
| | | | | Valuation Method C | | | | |
| | | | | Total Appraised Parcel Value 580,700 | | | | |

| BUILDING PERMIT RECORD | | | | | | | | VISIT / CHANGE HISTORY | | | | | | |
|------------------------|------------|------|----------------|--------|------------|--------|-----------|------------------------|------------|----|------|----|----|----------------------------|
| Permit Id | Issue Date | Type | Description | Amount | Insp Date | % Comp | Date Comp | Comments | Date | Id | Type | Is | Cd | Purpost/Result |
| 19-2113 | 06-27-2019 | 835 | Sid/Wind/Roof/ | 5,196 | | 100 | | window repacement (2) | 07-19-2023 | EG | 03 | | 16 | In Office Review |
| B26473 | 05-01-1984 | AD | Addition | 6,000 | 04-15-1985 | 100 | | MM | 05-07-2020 | LS | | | FR | Field Review |
| | | | | | | | | | 02-26-2018 | KM | 02 | | 03 | Cycl Insp Comp |
| | | | | | | | | | 01-24-2007 | PT | 02 | | 14 | Cyclical Inspection |
| | | | | | | | | | 12-04-2003 | PT | 01 | | 00 | Meas/Listed-Interior Acces |
| | | | | | | | | | 12-02-1998 | DD | 01 | | 00 | Meas/Listed-Interior Acces |

| LAND LINE VALUATION SECTION | | | | | | | | | | | | | | | | |
|-----------------------------|----------|----------------|------|----|------------|------------|------------------------|---------|------------|-------|-------|-----------|------------------|--------------------|------------|------------|
| B | Use Code | Description | Zone | LA | Land Units | Unit Price | Size Adj | AC Disc | Site Index | Cond. | Nbhd. | Nbhd. Adj | Notes | Location Adjustmen | Adj Unit P | Land Value |
| 1 | 1010 | Single Fam M-0 | RF | 3 | 0.490 AC | 176,344.00 | 1.81499 | 1.0000 | 5 | 1.00 | 0105 | 1.000 | | 1.0000 | 320,064.3 | 156,800 |
| Total Card Land Units | | | | | 0.49 | AC | Parcel Total Land Area | | | | | 0.49 | Total Land Value | | | 156,800 |

| CONSTRUCTION DETAIL | | | CONSTRUCTION DETAIL (CONTINUED) | | |
|--------------------------------|------|----------------|---------------------------------|-----|-------------|
| Element | Cd | Description | Element | Cd | Description |
| Style | 07 | Modern/Contemp | | | |
| Model | 01 | Residential | | | |
| Grade: | C+ | Average Plus | | | |
| Stories | 1 | 1 Story | | | |
| Exterior Wall 1 | 08 | Wood on Sheath | | | |
| Exterior Wall 2 | | | | | |
| Roof Structure | 03 | Gable/Hip | | | |
| Roof Cover | 03 | Asph/F Gls/Cmp | | | |
| Interior Wall 1 | 05 | Drywall | | | |
| Interior Wall 2 | | | | | |
| Interior Floor 1 | 14 | Carpet | | | |
| Interior Floor 2 | 12 | Hardwood | | | |
| Heat Fuel | 02 | Oil | | | |
| Heat Type | 05 | Hot Water | | | |
| AC Type | 03 | Central | | | |
| Bedrooms | 03 | 3 Bedrooms | | | |
| Full Baths | 2 | | | | |
| Half Baths | 0 | | | | |
| Extra Fixtures | | | | | |
| Total Rooms | 5 | 5 Rooms | | | |
| Bath Style | | | | | |
| Kitchen Style | | | | | |
| Occupancy | | | | | |
| Usrflid 105 | | | | | |
| Accessory Apt Foundation Alt | 01 | Poured Conc. | | | |
| Rms Prts | | | | | |
| Bath Split | 20 | 2 Full-0 Half | | | |
| CONDO DATA | | | | | |
| Parcel Id | | C | Owne | 0.0 | |
| Adjust Type | Code | Description | Factor% | | |
| Condo Flr | | | | | |
| Condo Unit | | | | | |
| COST / MARKET VALUATION | | | | | |
| Building Value New | | | 426,570 | | |
| Year Built | | | 1982 | | |
| Effective Year Built | | | 1997 | | |
| Depreciation Code | | | A | | |
| Remodel Rating | | | | | |
| Year Remodeled | | | | | |
| Depreciation % | | | 17 | | |
| Functional Obsol | | | 0 | | |
| External Obsol | | | 0 | | |
| Trend Factor | | | 1 | | |
| Condition | | | | | |
| Condition % | | | | | |
| Percent Good | | | 83 | | |
| RCNLD | | | 354,100 | | |
| Dep % Ovr | | | | | |
| Dep Ovr Comment | | | | | |
| Misc Imp Ovr | | | | | |
| Misc Imp Ovr Comment | | | | | |
| Cost to Cure Ovr | | | | | |
| Cost to Cure Ovr Comment | | | | | |

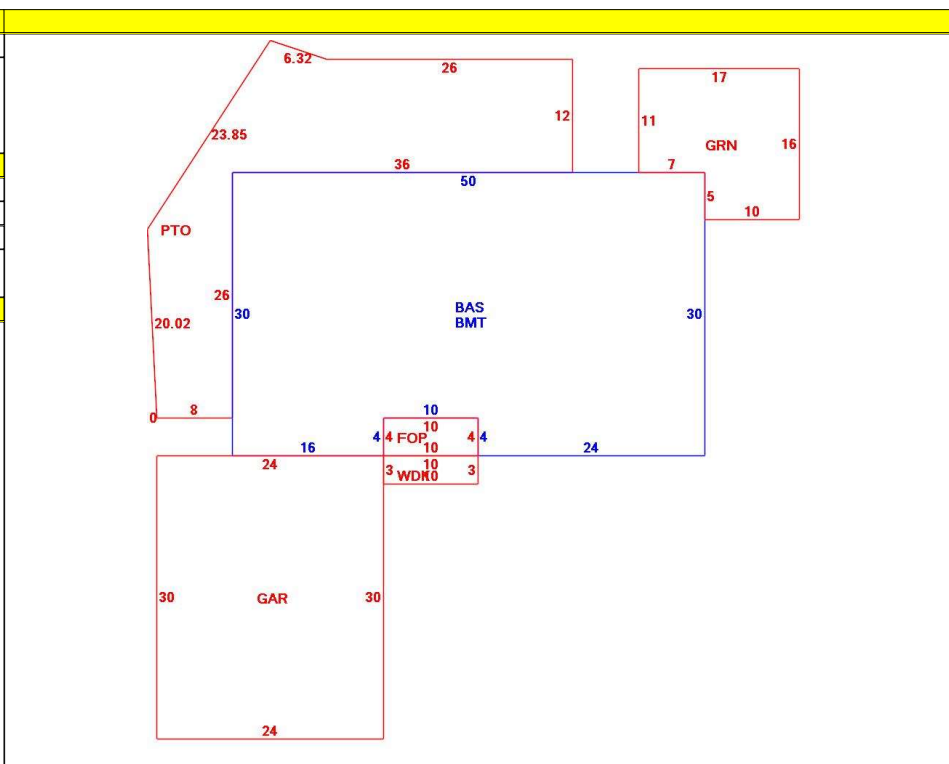

| OB - OUTBUILDING & YARD ITEMS(L) / XF - BUILDING EXTRA FEATURES(B) | | | | | | | | | | |
|--|-----------------|-----|-------|------------|--------|----------|------|-------|------------|-------------|
| Code | Description | L/B | Units | Unit Price | Yr Blt | Cond. Cd | % Gd | Grade | Grade Adj. | Appr. Value |
| FPL1 | Fireplace 1 sto | B | 1 | 5000.00 | 1999 | | 83 | | 0.00 | 4,200 |
| GRN1 | Greenhouse-R | L | 237 | 60.75 | 2000 | | 62 | C | 1.00 | 8,900 |
| PAT1 | Patio- Average | L | 666 | 5.89 | 1998 | | 79 | | 0.00 | 2,900 |
| FOP | Open Porch-ro | B | 40 | 55.00 | 1999 | | 83 | | 0.00 | 2,400 |
| GAR | Attached Gara | B | 720 | 40.00 | 1999 | | 83 | | 0.00 | 19,900 |
| BMT | Basement-Unfi | B | 1,460 | 26.01 | 1999 | | 83 | | 0.00 | 28,900 |
| FPIT | Fire Pit | L | 1 | 3010.00 | 1998 | | 58 | C | 1.00 | 1,700 |
| WDC | Wood Deck w/ | L | 30 | 18.00 | 1993 | | 48 | | 0.00 | 900 |

| BUILDING SUB-AREA SUMMARY SECTION | | | | | | | |
|-----------------------------------|-----------------|--------------|--------------|--------------|-----------|----------------|--|
| Code | Description | Living Area | Floor Area | Eff Area | Unit Cost | Undeprec Value | |
| BAS | First Floor | 1,460 | 1,460 | 1,460 | 292.17 | 426,570 | |
| BMT | Basement Area | 0 | 1,460 | 0 | 0.00 | 0 | |
| FOP | Open Porch | 0 | 40 | 0 | 0.00 | 0 | |
| GAR | Attached Garage | 0 | 720 | 0 | 0.00 | 0 | |
| GRN | Greenhouse | 0 | 237 | 0 | 0.00 | 0 | |
| PTO | Patio | 0 | 666 | 0 | 0.00 | 0 | |
| WDC | Wood Deck | 0 | 30 | 0 | 0.00 | 0 | |
| Ttl Gross Liv / Lease Area | | 1,460 | 4,613 | 1,460 | | 426,570 | |

