

| CURRENT OWNER  |  | TOPO           | UTILITIES   | STRT / ROAD | LOCATION | CURRENT ASSESSMENT    |      |          |          |
|--|--|----------------|---|-------------|----------|-----------------------|------|----------|----------|
| CHAFFIN, BARBARA BOWMAN<br><br>PO BOX 209<br><br>COTUIT MA 02635   |  | 2 Above Street | 2 Public Water  | 1 Paved     |          | Description           | Code | Assessed | Assessed |
|  |  |                | 4 Gas   |             |          | RESIDENTL             | 1010 | 392,300  | 392,300  |
|  |  |                | 6 Septic  |             |          | RES LAND              | 1010 | 266,600  | 266,600  |
| <b>SUPPLEMENTAL DATA</b>   |  |                |   |             |          |                       |      |          |          |
| Alt Prcl ID<br>Split Zonin<br>BID Parcel<br>ResExpt Q<br>#DL 1 LOT 4<br>#DL 2<br>GIS ID F_946164_2688630 |  |                | Plan Ref. 273/7<br>Land Ct#<br>#SR<br>Life Estate<br>PP STATU<br>Assoc Pid# |             |          | Total 658,900 658,900 |      |          |          |

801  
 FY2024  
 BARNSTABLE, MA  
**VISION**

| RECORD OF OWNERSHIP              |  | BK-VOL/PAGE | SALE DATE  | Q/U | V/I | SALE PRIC | VC | PREVIOUS ASSESSMENTS (HISTORY) |      |          |       |      |          |
|----------------------------------|--|-------------|------------|-----|-----|-----------|----|--------------------------------|------|----------|-------|------|----------|
| CHAFFIN, BARBARA BOWMAN          |  | 34797 290   | 12-30-2021 | U   | I   | 500,000   | 1  | Year                           | Code | Assessed | Year  | Code | Assessed |
| DANNHAUSER, STEPHEN J & JAMES F, |  | 30512 0293  | 05-25-2017 | U   | I   | 100       | 1F | 2023                           | 1010 | 337,800  | 2022  | 1010 | 291,800  |
| DANNHAUSER, JAMES F & STEPHEN J  |  | 29740 0231  | 06-21-2016 | U   | I   | 0         | 1F |                                | 1010 | 263,800  |       | 1010 | 169,000  |
| DANNHAUSER, SANDRA J & JAMES F T |  | 27965 0084  | 01-31-2014 | Q   | I   | 350,000   | 00 |                                |      |          |       | 1010 | 12,100   |
| TARDANICO & WELCH & KENDALL TRS  |  | 27837 0128  | 11-21-2013 | U   | I   | 265,000   | 1  | Total                          |      | 601,600  | Total |      | 460,800  |
|                                  |  |             |            |     |     |           |    | Total                          |      |          | Total |      | 419,500  |

| EXEMPTIONS |      |             | OTHER ASSESSMENTS |      |             |        |        |          |
|------------|------|-------------|-------------------|------|-------------|--------|--------|----------|
| Year       | Code | Description | Amount            | Code | Description | Number | Amount | Comm Int |
| Total      |      |             | 0.00              |      |             |        |        |          |

This signature acknowledges a visit by a Data Collector or Assessor

---

**APPRAISED VALUE SUMMARY**

Appraised Bldg. Value (Card) 342,600  
 Appraised Xf (B) Value (Bldg) 37,600  
 Appraised Ob (B) Value (Bldg) 12,100  
 Appraised Land Value (Bldg) 266,600  
 Special Land Value 0  
 Total Appraised Parcel Value 658,900  
 Valuation Method C  
 Total Appraised Parcel Value 658,900

| ASSESSING NEIGHBORHOOD |           |   |         |
|------------------------|-----------|---|---------|
| Nbhd                   | Nbhd Name | B | Tracing |
| 0108                   |           |   | COTUIT  |

| BUILDING PERMIT RECORD |            |      |                |        |            |        |            |                          |            |    |      |    |    | VISIT / CHANGE HISTORY |  |  |  |  |
|------------------------|------------|------|----------------|--------|------------|--------|------------|--------------------------|------------|----|------|----|----|------------------------|--|--|--|--|
| Permit Id              | Issue Date | Type | Description    | Amount | Insp Date  | % Comp | Date Comp  | Comments                 | Date       | Id | Type | Is | Cd | Purpost/Result         |  |  |  |  |
| EXPR-22-11             | 08-18-2022 | 835  | Sid/Wind/Roof/ | 9,000  |            | 100    |            | siding and windows (2)   | 07-12-2022 | BM | 22   |    | 22 | Change of Address      |  |  |  |  |
| 201504974              | 08-14-2015 | IN   | Insulation     | 4,139  | 06-30-2016 | 100    | 06-30-2016 | WEATHERIZATION           | 01-11-2022 | BM | 03   |    | 16 | In Office Review       |  |  |  |  |
| 201500277              | 02-02-2015 | PV   | Solar PV Syste | 22,831 | 04-16-2015 | 100    | 06-30-2015 | INSTALLATION OF A ROOF T | 05-26-2020 | DM |      |    | FR | Field Review           |  |  |  |  |
| 201405494              | 09-15-2014 | WD   | Wood Deck      | 5,000  | 11-13-2014 | 100    | 06-30-2015 | WD 14X20 SUNDECK NEW     | 04-23-2015 | SR | 02   |    | 03 | Cycl Insp Comp         |  |  |  |  |
| B34448                 | 07-01-1991 | AD   | Addition       | 7,500  | 01-15-1992 | 100    | 06-30-1992 | CO ADD'N                 | 02-02-2015 | MW | 02   |    | 02 | Bldg Permit Completed  |  |  |  |  |
| B19209                 | 05-01-1977 | DW   | Dwelling       | 0      | 01-15-1978 | 100    | 06-30-1978 | CO 1 STOR                | 07-16-2014 | TR | 03   |    | 16 | In Office Review       |  |  |  |  |
|                        |            |      |                |        |            |        |            |                          | 04-09-2014 | TW | 22   |    | 22 | Change of Address      |  |  |  |  |

| LAND LINE VALUATION SECTION |          |                |      |    |            |            |            |         |            |       |       |           |       |                    |            |            |         |
|-----------------------------|----------|----------------|------|----|------------|------------|------------|---------|------------|-------|-------|-----------|-------|--------------------|------------|------------|---------|
| B                           | Use Code | Description    | Zone | LA | Land Units | Unit Price | Size Adj   | AC Disc | Site Index | Cond. | Nbhd. | Nbhd. Adj | Notes | Location Adjustmen | Adj Unit P | Land Value |         |
| 1                           | 1010     | Single Fam M-0 | RF   | 2  | 0.490      | AC         | 176,344.00 | 1.81499 | 1.0000     | 5     | 1.00  | 0108      | 1.700 |                    | 1.0000     | 544,109.4  | 266,600 |

|                       |  |  |  |  |      |    |                        |  |  |  |  |      |                  |  |  |  |         |
|-----------------------|--|--|--|--|------|----|------------------------|--|--|--|--|------|------------------|--|--|--|---------|
| Total Card Land Units |  |  |  |  | 0.49 | AC | Parcel Total Land Area |  |  |  |  | 0.49 | Total Land Value |  |  |  | 266,600 |
|-----------------------|--|--|--|--|------|----|------------------------|--|--|--|--|------|------------------|--|--|--|---------|

| CONSTRUCTION DETAIL |    |                | CONSTRUCTION DETAIL (CONTINUED) |    |             |
|---------------------|----|----------------|---------------------------------|----|-------------|
| Element             | Cd | Description    | Element                         | Cd | Description |
| Style               | 01 | Ranch          |                                 |    |             |
| Model               | 01 | Residential    |                                 |    |             |
| Grade:              | C  | Average        |                                 |    |             |
| Stories             | 1  | 1 Story        |                                 |    |             |
| Exterior Wall 1     | 14 | Wood Shingle   |                                 |    |             |
| Exterior Wall 2     | 06 | Vertical Sidin |                                 |    |             |
| Roof Structure      | 03 | Gable/Hip      |                                 |    |             |
| Roof Cover          | 03 | Asph/F Gls/Cmp |                                 |    |             |
| Interior Wall 1     | 05 | Drywall        |                                 |    |             |
| Interior Wall 2     |    |                |                                 |    |             |
| Interior Floor 1    | 14 | Carpet         |                                 |    |             |
| Interior Floor 2    | 05 | Vinyl/Asphalt  |                                 |    |             |
| Heat Fuel           | 03 | Gas            |                                 |    |             |
| Heat Type           | 04 | Hot Air        |                                 |    |             |
| AC Type             | 03 | Central        |                                 |    |             |
| Bedrooms            | 02 | 2 Bedrooms     |                                 |    |             |
| Full Baths          | 2  |                |                                 |    |             |
| Half Baths          | 0  |                |                                 |    |             |
| Extra Fixtures      |    |                |                                 |    |             |
| Total Rooms         | 4  | 6 Rooms        |                                 |    |             |
| Bath Style          |    |                |                                 |    |             |
| Kitchen Style       |    |                |                                 |    |             |
| Occupancy           |    |                |                                 |    |             |
| Usrflid 105         |    |                |                                 |    |             |
| Accessory Apt       |    |                |                                 |    |             |
| Foundation Alt      | 02 | Conc. Block    |                                 |    |             |
| Rms Prts            |    |                |                                 |    |             |
| Bath Split          | 20 | 2 Full-0 Half  |                                 |    |             |

| CONDO DATA  |      |             |         |     |
|-------------|------|-------------|---------|-----|
| Parcel Id   |      | C           | Owne    | 0.0 |
| Adjust Type | Code | Description | Factor% |     |
| Condo Flr   |      |             |         |     |
| Condo Unit  |      |             |         |     |

| COST / MARKET VALUATION  |         |
|--------------------------|---------|
| Building Value New       | 422,979 |
| Year Built               | 1977    |
| Effective Year Built     | 1994    |
| Depreciation Code        | A       |
| Remodel Rating           |         |
| Year Remodeled           |         |
| Depreciation %           | 19      |
| Functional Obsol         | 0       |
| External Obsol           | 0       |
| Trend Factor             | 1       |
| Condition                |         |
| Condition %              |         |
| Percent Good             | 81      |
| RCNLD                    | 342,600 |
| Dep % Ovr                |         |
| Dep Ovr Comment          |         |
| Misc Imp Ovr             |         |
| Misc Imp Ovr Comment     |         |
| Cost to Cure Ovr         |         |
| Cost to Cure Ovr Comment |         |

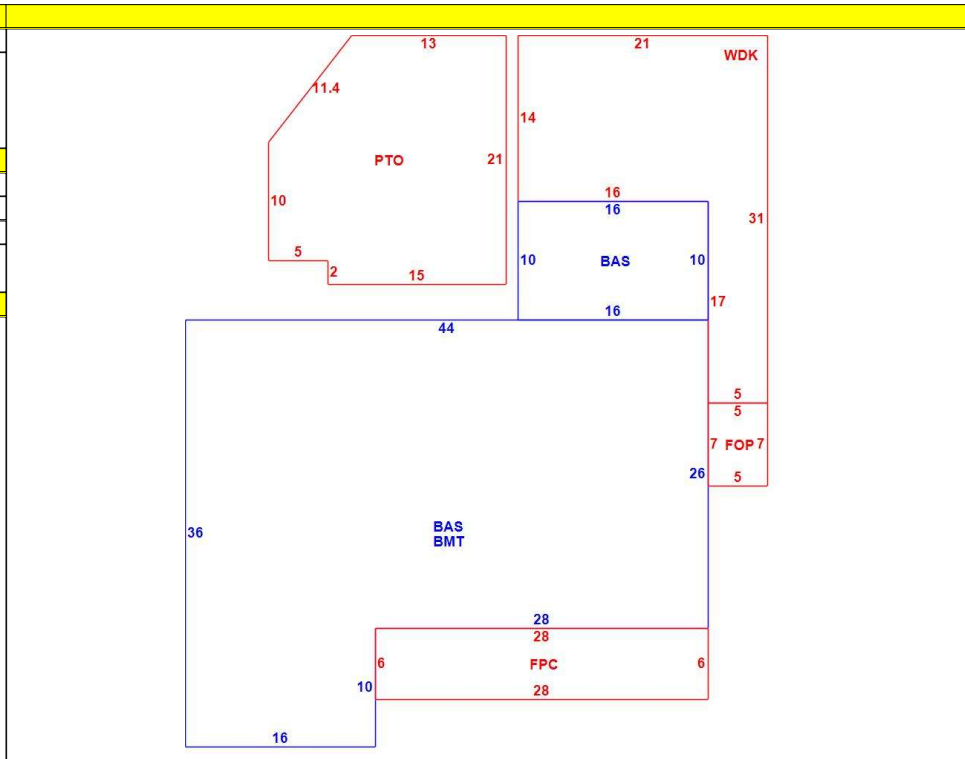

| OB - OUTBUILDING & YARD ITEMS(L) / XF - BUILDING EXTRA FEATURES(B) |                 |     |       |            |        |          |      |       |            |             |
|--|-----------------|-----|-------|------------|--------|----------|------|-------|------------|-------------|
| Code   | Description     | L/B | Units | Unit Price | Yr Blt | Cond. Cd | % Gd | Grade | Grade Adj. | Appr. Value |
| FPL1   | Fireplace 1 sto | B   | 1     | 5000.00    | 1996   |          | 81   |       | 0.00       | 4,100       |
| FOP  | Open Porch-ro   | B   | 35    | 55.00      | 1996   |          | 81   |       | 0.00       | 2,200       |
| BMT  | Basement-Unfi   | B   | 1,304 | 26.01      | 1996   |          | 81   |       | 0.00       | 25,900      |
| FOPC   | Open Prch-roo   | B   | 168   | 55.00      | 1996   |          | 81   |       | 0.00       | 5,400       |
| WDC  | Wood Decking    | L   | 379   | 20.00      | 2014   |          | 90   |       | 0.00       | 6,600       |
| PATC   | Conc Pavers     | L   | 378   | 15.46      | 2014   |          | 95   |       | 0.00       | 5,500       |
| SOL1   | Solar PV Pane   | B   | 22    | 860.00     | 1996   |          | 0    |       | 0.00       | 0           |

| BUILDING SUB-AREA SUMMARY SECTION |                        |             |            |          |           |                |
|-----------------------------------|------------------------|-------------|------------|----------|-----------|----------------|
| Code                              | Description            | Living Area | Floor Area | Eff Area | Unit Cost | Undeprec Value |
| BAS                               | First Floor            | 1,464       | 1,464      | 1,464    | 288.92    | 422,979        |
| BMT                               | Basement Area          | 0           | 1,304      | 0        | 0.00      | 0              |
| FOP                               | Open Porch             | 0           | 35         | 0        | 0.00      | 0              |
| FPC                               | Open Porch Conc. Floor | 0           | 168        | 0        | 0.00      | 0              |
| PTO                               | Patio                  | 0           | 379        | 0        | 0.00      | 0              |
| WDK                               | Wood Deck              | 0           | 379        | 0        | 0.00      | 0              |
| Ttl Gross Liv / Lease Area        |                        | 1,464       | 3,729      | 1,464    |           | 422,979        |

