

| CURRENT OWNER | | TOPO | UTILITIES | STRT / ROAD | LOCATION | CURRENT ASSESSMENT | | | | | | 801 FY2024 BARNSTABLE, MA VISION | | | | | | | |
|--|------------|-------------------|-------------|-------------------------------|-------------|--------------------------|------------|------------------------|------------|---|--------------------------------|--|--------------------------------------|--------------------|-------------------|------------|------|------|----------|
| GALLAGHER, JOHN J III & PAUL T TR WIANNO NOMINEE TRUST 96 WEBSTER STREET HANOVER MA 02339 | | | | | | Description | Code | Assessed | Assessed | | | | | | | | | | |
| | | | | | | COMMERC. | 3430 | 270,600 | 270,600 | | | | | | | | | | |
| | | | | | | SUPPLEMENTAL DATA | | | | | | | | Total | 270,600 | 270,600 | | | |
| Alt Prcl ID | | Split Zonin RC;BA | | Plan Ref. 363/88-95 | | | | | | | | | | | | | | | |
| #DL 1 | | UNIT J5 | | Land Ct# | | | | | | | | | | | | | | | |
| #DL 2 | | BLDG G | | #SR | | | | | | | | | | | | | | | |
| GIS ID | | F_961840_2691249 | | Life Estate | | | | | | | | | | | | | | | |
| | | | | PP STATU | | | | | | | | | | | | | | | |
| | | | | Assoc Pid# | | | | | | | | | | | | | | | |
| RECORD OF OWNERSHIP | | | | BK-VOL/PAGE | SALE DATE | Q/U | V/I | SALE PRICE | VC | PREVIOUS ASSESSMENTS (HISTORY) | | | | | | | | | |
| GALLAGHER, JOHN J III & PAUL T TRS | | | | 35225 | 256 | 03-30-2017 | U | I | 0 | 1F | Year | Code | Assessed | Year | Code | Assessed | Year | Code | Assessed |
| GALLAGHER, ANNE H ET AL TRS | | | | 27260 | 0264 | 04-03-2013 | U | I | 1 | 1F | 2023 | 3430 | 298,400 | 2022 | 3430 | 238,400 | 2021 | 3430 | 238,400 |
| GALLAGHER, JOHN J III TR | | | | 3485 | 0105 | 05-15-1982 | U | | 0 | | | | | | | | | | |
| | | | | Total | | | | | | Total | 298,400 | Total | 238,400 | Total | 238,400 | | | | |
| EXEMPTIONS | | | | OTHER ASSESSMENTS | | | | | | This signature acknowledges a visit by a Data Collector or Assessor | | | | | | | | | |
| Year | Code | Description | Amount | Code | Description | Number | Amount | Comm Int | | | | | | | | | | | |
| | | | Total | 0.00 | | | | | | | APPRAISED VALUE SUMMARY | | | | | | | | |
| | | | | ASSESSING NEIGHBORHOOD | | | | | | Appraised Bldg. Value (Card) 266,900 | | | | | | | | | |
| Nbhd | | Nbhd Name | | B | | Tracing | | Batch | | Appraised Xf (B) Value (Bldg) 3,700 | | | | | | | | | |
| 0001 | | | | | | | | OSTVIL | | Appraised Ob (B) Value (Bldg) 0 | | | | | | | | | |
| NOTES | | | | | | | | | | | | | Appraised Land Value (Bldg) 0 | | | | | | |
| | | | | | | | | | | | | | Special Land Value 0 | | | | | | |
| | | | | | | | | | | | | | Total Appraised Parcel Value 270,600 | | | | | | |
| | | | | | | | | | | | | | Valuation Method C | | | | | | |
| | | | | | | | | | | | | | Total Appraised Parcel Value 270,600 | | | | | | |
| BUILDING PERMIT RECORD | | | | | | | | | | VISIT / CHANGE HISTORY | | | | | | | | | |
| Permit Id | Issue Date | Type | Description | Amount | Insp Date | % Comp | Date Comp | Comments | | Date | Id | Type | Is | Cd | Purpost/Result | | | | |
| | | | | | | | | | | 05-08-2023 | AG | 22 | | 22 | Change of Address | | | | |
| | | | | | | | | | | 04-30-2020 | GM | 04 | | FR | Field Review | | | | |
| | | | | | | | | | | 05-20-2019 | SR | 02 | | 03 | Cycl Insp Comp | | | | |
| | | | | | | | | | | 07-29-2015 | TP | 03 | | 16 | In Office Review | | | | |
| | | | | | | | | | | 03-28-2014 | TR | 22 | | 22 | Change of Address | | | | |
| | | | | | | | | | | 07-25-2013 | DR | 03 | | 16 | In Office Review | | | | |
| | | | | | | | | | | 05-13-2010 | DR | 22 | | 22 | Change of Address | | | | |
| LAND LINE VALUATION SECTION | | | | | | | | | | | | | | | | | | | |
| B | Use Code | Description | Zone | Dist | Land Type | Land Units | Unit Price | Size Adj | Site Index | Cond. | Nbhd. | Nbhd. Adj | Notes | Location Adjustmen | Adj Unit P | Land Value | | | |
| 1 | 3430 | OFF CONDO M- | SPLI | 3 | | 0 SF | 0.00 | 1.00000 | 5 | 1.00 | 0003 | 1.000 | | 0.0000 | 0 | 0 | | | |
| Total Card Land Units | | | | | | 0 | SF | Parcel Total Land Area | | | | | | 0.00 | Total Land Value | | | 0 | |

| CONSTRUCTION DETAIL | | | CONSTRUCTION DETAIL (CONTINUED) | | |
|--------------------------|--------------|----------------|---------------------------------|-----|-------------|
| Element | Cd | Description | Element | Cd | Description |
| Style | 56 | Condo Office | | | |
| Model | 06 | Com Condo | | | |
| Bedrm Func | C+ | Average Plus | | | |
| Stories | 1 | 1 Story | | | |
| Occupancy | 0 | | | | |
| Interior Wall 1 | 05 | Drywall | | | |
| Interior Wall 2 | | | | | |
| Interior Floor 1 | 14 | Carpet | | | |
| Interior Floor 2 | | | | | |
| Heat Fuel | 04 | Electric | | | |
| Heat Type | 07 | Elec Baseboard | | | |
| AC Type | 03 | Central | | | |
| Bedrooms | 00 | | | | |
| Full Baths | 0 | | | | |
| Half Baths | 0 | | | | |
| Extra Fixtures | | | | | |
| Total Rooms | | | | | |
| Bath Style | | | | | |
| Kitchen Style | | | | | |
| Master Deed L | 1000 | | | | |
| Bath Split | 00 | 0 Full-0 Half | | | |
| Foundation | 01 | Poured Conc. | | | |
| AC Type Alt | | | | | |
| Sewer Occupan | | | | | |
| CONDO DATA | | | | | |
| Parcel Id | 104194 | C 0030 | Ownr | 2.0 | |
| | WIANNO KNOLL | B 1 | S 1 | | |
| Adjust Type | Code | Description | Factor% | | |
| Condo Flr | | | 100 | | |
| Condo Unit | MKT0 | MKT0 | 100 | | |
| COST / MARKET VALUATION | | | | | |
| Building Value New | | | 346,581 | | |
| Year Built | | | 1983 | | |
| Effective Year Built | | | 1989 | | |
| Depreciation Code | | | A | | |
| Remodel Rating | | | | | |
| Year Remodeled | | | | | |
| Depreciation % | | | 23 | | |
| Functional Obsol | | | 0 | | |
| External Obsol | | | 0 | | |
| Trend Factor | | | 1 | | |
| Condition | | | | | |
| Condition % | | | | | |
| Percent Good | | | 77 | | |
| Cns Sect Rcnd | | | 266,900 | | |
| Dep % Ovr | | | | | |
| Dep Ovr Comment | | | | | |
| Misc Imp Ovr | | | | | |
| Misc Imp Ovr Comment | | | | | |
| Cost to Cure Ovr | | | | | |
| Cost to Cure Ovr Comment | | | | | |

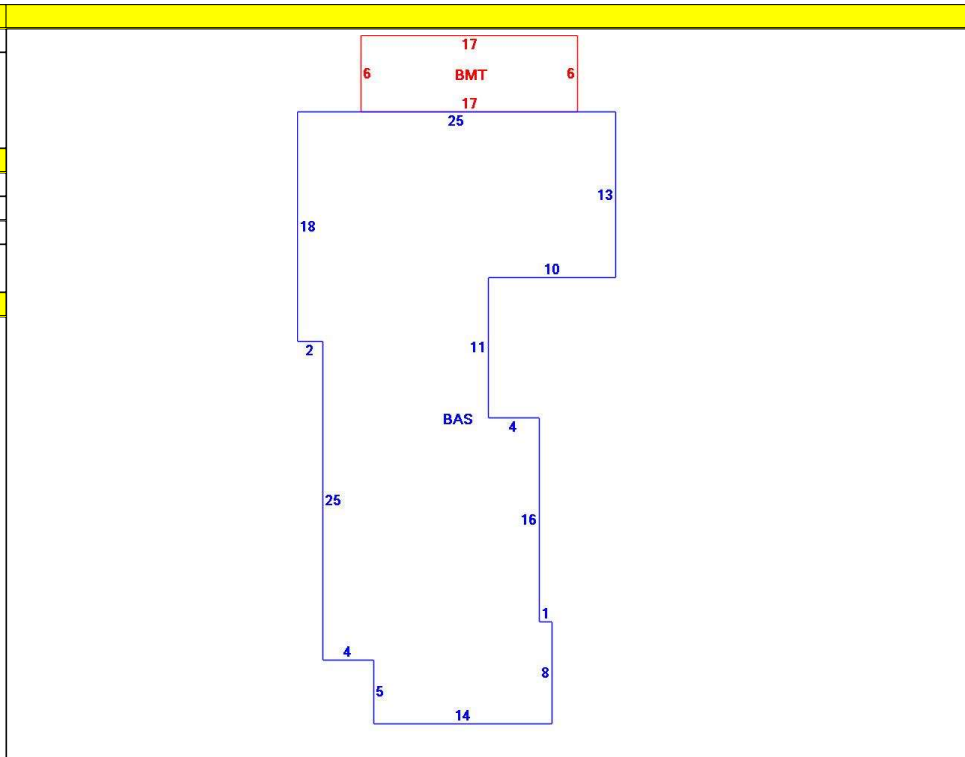

| OB - OUTBUILDING & YARD ITEMS(L) / XF - BUILDING EXTRA FEATURES(B) | | | | | | | | | | |
|--|---------------|-----|-------|------------|--------|----------|------|-------|------------|-------------|
| Code | Description | L/B | Units | Unit Price | Yr Blt | Cond. Cd | % Gd | Grade | Grade Adj. | Appr. Value |
| BMT | Basement-Unfi | B | 102 | 26.01 | 1991 | | 77 | | 0.00 | 3,700 |

| BUILDING SUB-AREA SUMMARY SECTION | | | | | | | |
|-----------------------------------|---------------|-------------|------------|----------|-----------|----------------|--|
| Code | Description | Living Area | Floor Area | Eff Area | Unit Cost | Undeprec Value | |
| BAS | First Floor | 874 | 874 | 874 | 387.67 | 338,827 | |
| BMT | Basement Area | 0 | 102 | 20 | 76.01 | 7,753 | |
| Ttl Gross Liv / Lease Area | | 874 | 976 | 894 | | 346,580 | |

