

| CURRENT OWNER  |   | TOPO             | UTILITIES | STRT / ROAD  | LOCATION | CURRENT ASSESSMENT |             |          |          | 801<br>FY2024<br>BARNSTABLE, MA<br><br><b>VISION</b> |          |
|--|---|------------------|-----------|--------------|----------|--------------------|-------------|----------|----------|--|----------|
| HARRIS, LAURENCE P & ANNE L<br><br>100 ROSEMARY LN<br><br>CENTERVILLE MA 02632 | 1 | Level            | 2         | Public Water | 1        | Paved              | Description | Code     | Assessed |  | Assessed |
|  |   |                  | 4         | Gas          |          |                    | RESIDNTL    | 1010     | 408,900  |  | 408,900  |
|  |   |                  | 6         | Septic       |          |                    | RES LAND    | 1010     | 152,600  | 152,600  |          |
| <b>SUPPLEMENTAL DATA</b>   |   |                  |           |              |          | Total              |             | 561,500  | 561,500  |  |          |
| Alt Prcl ID  |   | Split Zonin      |           | Plan Ref.    |          | Land Ct#           |             | 37432-F  |          |  |          |
| BID Parcel   |   | ResExpt Q        |           | YES:         |          | Life Estate        |             | PP STATU |          |  |          |
| #DL 1  |   | LOT 15           |           | #DL 2        |          | Assoc Pid#         |             |          |          |  |          |
| GIS ID   |   | F_962661_2703976 |           |              |          |                    |             |          |          |  |          |

| RECORD OF OWNERSHIP  |      | BK-VOL/PAGE | SALE DATE  | Q/U | V/I | SALE PRIC | VC | PREVIOUS ASSESSMENTS (HISTORY) |      |          |      |         |          |       |      |          |
|--|------|-------------|------------|-----|-----|-----------|----|--------------------------------|------|----------|------|---------|----------|-------|------|----------|
| HARRIS, LAURENCE P & ANNE L<br>CONNECTICUT NATIONAL BANK<br>VALAND INC | 7505 | 0325        | 04-23-1991 | U   | V   | 32,500    | 1L | Year                           | Code | Assessed | Year | Code    | Assessed | Year  | Code | Assessed |
|  | 7483 | 0090        | 04-01-1991 | U   | V   | 0         | L  | 2023                           | 1010 | 352,400  | 2022 | 1010    | 304,700  | 2021  | 1010 | 247,600  |
|  | 5053 | 0197        | 05-01-1986 | U   | V   | 0         |    |                                | 1010 | 138,700  |      | 1010    | 102,700  |       | 1010 | 102,700  |
| Total  |      |             |            |     |     |           |    | 491,100                        |      | Total    |      | 407,400 |          | Total |      | 353,600  |

| EXEMPTIONS |      |                       | OTHER ASSESSMENTS |      |             |        |        | This signature acknowledges a visit by a Data Collector or Assessor |  |  |  |  |  |  |  |  |  |  |
|------------|------|-----------------------|-------------------|------|-------------|--------|--------|---|--|--|--|--|--|--|--|--|--|--|
| Year       | Code | Description           | Amount            | Code | Description | Number | Amount | Comm Int  |  |  |  |  |  |  |  |  |  |  |
| 2023       | 5C   | RESIDENTIAL EXEMPTION |                   |      |             |        |        |   |  |  |  |  |  |  |  |  |  |  |
| Total      |      | 0.00                  |                   |      |             |        |        |   |  |  |  |  |  |  |  |  |  |  |

| ASSESSING NEIGHBORHOOD |           |   |  | APPRAISED VALUE SUMMARY       |  |       |  |                               |         |
|------------------------|-----------|---|--|-------------------------------|--|-------|--|-------------------------------|---------|
| Nbhd                   | Nbhd Name | B |  | Tracing                       |  | Batch |  | Appraised Bldg. Value (Card)  | 355,400 |
| 0105                   |           |   |  | CENVIL                        |  |       |  | Appraised Xf (B) Value (Bldg) | 50,200  |
| <b>NOTES</b>           |           |   |  | Appraised Ob (B) Value (Bldg) |  |       |  | Appraised Land Value (Bldg)   | 152,600 |
|                        |           |   |  | Special Land Value            |  |       |  | Total Appraised Parcel Value  | 561,500 |
|                        |           |   |  | Valuation Method              |  |       |  |                               | C       |
|                        |           |   |  | Total Appraised Parcel Value  |  |       |  |                               | 561,500 |

| BUILDING PERMIT RECORD |            |      |             |        |            |        |           | VISIT / CHANGE HISTORY |            |    |      |    |    |                     |
|------------------------|------------|------|-------------|--------|------------|--------|-----------|------------------------|------------|----|------|----|----|---------------------|
| Permit Id              | Issue Date | Type | Description | Amount | Insp Date  | % Comp | Date Comp | Comments               | Date       | Id | Type | Is | Cd | Purpost/Result      |
| B36526                 | 03-01-1994 | DW   | Dwelling    | 60,000 | 01-15-1995 | 100    |           | CE 1 STOR              | 01-26-2023 | JO | 03   |    | 16 | In Office Review    |
|                        |            |      |             |        |            |        |           |                        | 04-29-2020 | LS |      |    | FR | Field Review        |
|                        |            |      |             |        |            |        |           |                        | 01-10-2018 | SR | 02   |    | 03 | Cycl Insp Comp      |
|                        |            |      |             |        |            |        |           |                        | 07-17-2007 | PT | 02   |    | 14 | Cyclical Inspection |

| LAND LINE VALUATION SECTION |          |                |      |    |            |            |                        |         |            |       |       |           |                  |                    |            |            |
|-----------------------------|----------|----------------|------|----|------------|------------|------------------------|---------|------------|-------|-------|-----------|------------------|--------------------|------------|------------|
| B                           | Use Code | Description    | Zone | LA | Land Units | Unit Price | Size Adj               | AC Disc | Site Index | Cond. | Nbhd. | Nbhd. Adj | Notes            | Location Adjustmen | Adj Unit P | Land Value |
| 1                           | 1010     | Single Fam M-0 | RC   | 3  | 0.360 AC   | 176,344.00 | 2.40337                | 1.0000  | 5          | 1.00  | 0105  | 1.000     |                  | 1.0000             | 423,825.1  | 152,600    |
| Total Card Land Units       |          |                |      |    | 0.36       | AC         | Parcel Total Land Area |         |            |       |       | 0.36      | Total Land Value |                    |            | 152,600    |

| CONSTRUCTION DETAIL |    |                | CONSTRUCTION DETAIL (CONTINUED) |    |             |
|---------------------|----|----------------|---------------------------------|----|-------------|
| Element             | Cd | Description    | Element                         | Cd | Description |
| Style               | 01 | Ranch          |                                 |    |             |
| Model               | 01 | Residential    |                                 |    |             |
| Grade:              | C  | Average        |                                 |    |             |
| Stories             | 1  | 1 Story        |                                 |    |             |
| Exterior Wall 1     | 14 | Wood Shingle   |                                 |    |             |
| Exterior Wall 2     | 11 | Clapboard      |                                 |    |             |
| RooF Structure      | 03 | Gable/Hip      |                                 |    |             |
| RooF Cover          | 03 | Asph/F Gls/Cmp |                                 |    |             |
| Interior Wall 1     | 05 | Drywall        |                                 |    |             |
| Interior Wall 2     |    |                |                                 |    |             |
| Interior Floor 1    | 14 | Carpet         |                                 |    |             |
| Interior Floor 2    | 12 | Hardwood       |                                 |    |             |
| Heat Fuel           | 03 | Gas            |                                 |    |             |
| Heat Type           | 05 | Hot Water      |                                 |    |             |
| AC Type             | 01 | None           |                                 |    |             |
| Bedrooms            | 03 | 3 Bedrooms     |                                 |    |             |
| Full Baths          | 2  |                |                                 |    |             |
| Half Baths          | 0  |                |                                 |    |             |
| Extra Fixtures      |    |                |                                 |    |             |
| Total Rooms         | 6  | 6 Rooms        |                                 |    |             |
| Bath Style          |    |                |                                 |    |             |
| Kitchen Style       |    |                |                                 |    |             |
| Occupancy           |    |                |                                 |    |             |
| Usrflid 105         |    |                |                                 |    |             |
| Accessory Apt       |    |                |                                 |    |             |
| Foundation Alt      | 01 | Poured Conc.   |                                 |    |             |
| Rms Prts            |    |                |                                 |    |             |
| Bath Split          | 20 | 2 Full-0 Half  |                                 |    |             |

| CONDO DATA  |      |             |          |
|-------------|------|-------------|----------|
| Parcel Id   |      | C           | Ownr 0.0 |
|             |      | B           | S        |
| Adjust Type | Code | Description | Factor%  |
| Condo Flr   |      |             |          |
| Condo Unit  |      |             |          |

| COST / MARKET VALUATION  |         |
|--------------------------|---------|
| Building Value New       | 403,865 |
| Year Built               | 1994    |
| Effective Year Built     | 2003    |
| Depreciation Code        | A       |
| Remodel Rating           |         |
| Year Remodeled           |         |
| Depreciation %           | 12      |
| Functional Obsol         | 0       |
| External Obsol           | 0       |
| Trend Factor             | 1       |
| Condition                |         |
| Condition %              |         |
| Percent Good             | 88      |
| RCNLD                    | 355,400 |
| Dep % Ovr                |         |
| Dep Ovr Comment          |         |
| Misc Imp Ovr             |         |
| Misc Imp Ovr Comment     |         |
| Cost to Cure Ovr         |         |
| Cost to Cure Ovr Comment |         |

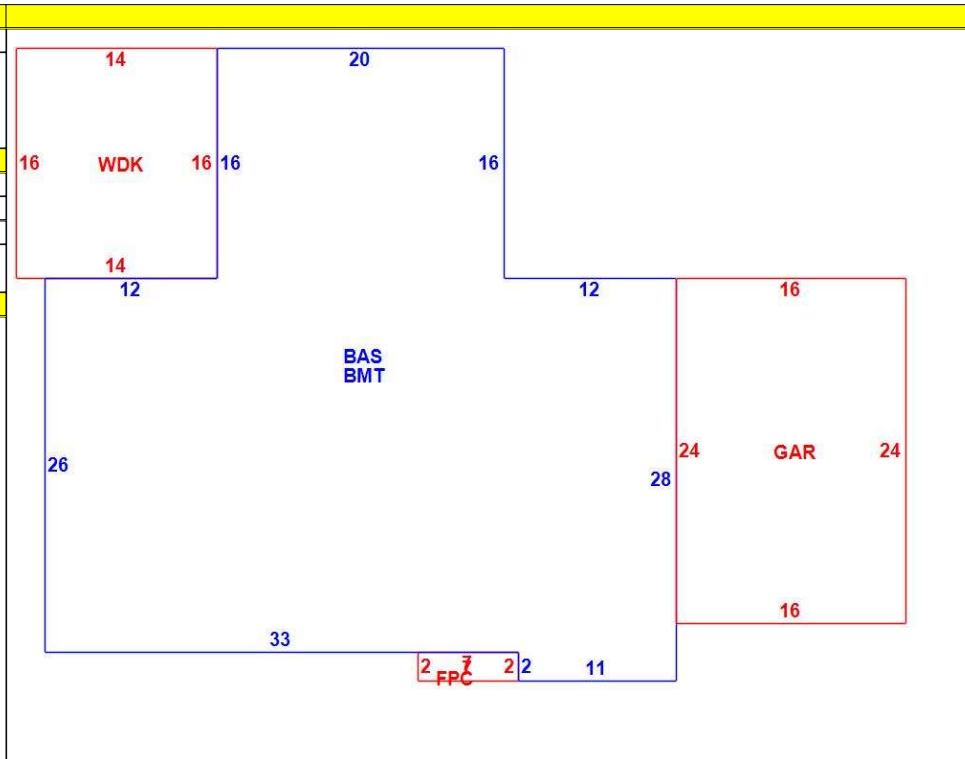

| OB - OUTBUILDING & YARD ITEMS(L) / XF - BUILDING EXTRA FEATURES(B) |                 |     |       |            |        |          |      |       |            |             |
|--|-----------------|-----|-------|------------|--------|----------|------|-------|------------|-------------|
| Code   | Description     | L/B | Units | Unit Price | Yr Blt | Cond. Cd | % Gd | Grade | Grade Adj. | Appr. Value |
| FPL1   | Fireplace 1 sto | B   | 1     | 5000.00    | 2005   |          | 88   |       | 0.00       | 4,400       |
| WDC  | Wood Decking    | L   | 224   | 20.00      | 2002   |          | 66   |       | 0.00       | 3,300       |
| FOPC   | Open Prch-roo   | B   | 14    | 55.00      | 2005   |          | 88   |       | 0.00       | 1,000       |
| GAR  | Attached Gara   | B   | 384   | 40.00      | 2005   |          | 88   |       | 0.00       | 13,800      |
| BMT  | Basement-Unfi   | B   | 1,486 | 26.01      | 2005   |          | 88   |       | 0.00       | 31,000      |

| BUILDING SUB-AREA SUMMARY SECTION |                        |             |            |          |           |                |
|-----------------------------------|------------------------|-------------|------------|----------|-----------|----------------|
| Code                              | Description            | Living Area | Floor Area | Eff Area | Unit Cost | Undeprec Value |
| BAS                               | First Floor            | 1,486       | 1,486      | 1,486    | 271.78    | 403,865        |
| BMT                               | Basement Area          | 0           | 1,486      | 0        | 0.00      | 0              |
| FPC                               | Open Porch Conc. Floor | 0           | 14         | 0        | 0.00      | 0              |
| GAR                               | Attached Garage        | 0           | 384        | 0        | 0.00      | 0              |
| WDC                               | Wood Deck              | 0           | 224        | 0        | 0.00      | 0              |
| Ttl Gross Liv / Lease Area        |                        | 1,486       | 3,594      | 1,486    |           | 403,865        |

