

| CURRENT OWNER | | TOPO | UTILITIES | STRT / ROAD | LOCATION | CURRENT ASSESSMENT | | | | 801 FY2024 BARNSTABLE, MA VISION | |
|---|--|------------------|----------------|-------------|----------|--------------------|------|----------|----------|--|---------|
| AMI TRUST 110 HIGHLAND AVENUE COTUIT MA 02635 | | 1 Level | 2 Public Water | 1 Paved | | Description | Code | Assessed | Assessed | | |
| | | | 6 Septic | | | RESIDENTL | 1010 | 354,700 | 354,700 | | |
| | | | 4 Gas | | | RES LAND | 1010 | 264,900 | 264,900 | | |
| SUPPLEMENTAL DATA | | | | | | Total | | | | 619,600 | 619,600 |
| Alt Prcl ID | | Split Zonin | | Plan Ref. | | | | | | | |
| BID Parcel | | ResExpt Q | | Land Ct# | | | | | | | |
| #DL 1 | | #DL 2 | | #SR | | | | | | | |
| GIS ID | | F_945891_2688530 | | Life Estate | | | | | | | |
| | | | | PP STATU | | | | | | | |
| | | | | Assoc Pid# | | | | | | | |

| RECORD OF OWNERSHIP | | BK-VOL/PAGE | SALE DATE | Q/U | V/I | SALE PRIC | VC | PREVIOUS ASSESSMENTS (HISTORY) | | | | | |
|---------------------------|-------|-------------|------------|-----|-----|-----------|----|--------------------------------|------|----------|-------|------|----------|
| AMI TRUST | 27317 | 0288 | 04-24-2013 | U | I | 1 | 1F | Year | Code | Assessed | Year | Code | Assessed |
| MILLER, JOANNE M | 8498 | 0076 | 03-26-1993 | Q | I | 103,500 | U | 2023 | 1010 | 314,100 | 2022 | 1010 | 276,200 |
| MOORE, ALICE M | 7264 | 0196 | 08-17-1990 | U | I | 1 | A | | 1010 | 262,100 | 2021 | 1010 | 167,900 |
| MOORE, ALBERT H & ALICE M | 1950 | 0083 | 10-12-1973 | U | I | 0 | A | Total | | 576,200 | Total | | 444,100 |
| | | | | | | | | Total | | 412,400 | Total | | 412,400 |

| EXEMPTIONS | | | OTHER ASSESSMENTS | | | | This signature acknowledges a visit by a Data Collector or Assessor | | | | | |
|------------|------|-------------|-------------------|------|-------------|--------|---|----------|--|--|--|--|
| Year | Code | Description | Amount | Code | Description | Number | Amount | Comm Int | | | | |
| | | | | | | | | | | | | |
| Total | | | 0.00 | | | | | | | | | |

| ASSESSING NEIGHBORHOOD | | | | APPRAISED VALUE SUMMARY | | | | | |
|------------------------|-----------|---|---------|-------------------------|--|--|-------------------------------|-------------------------------|---------|
| Nbhd | Nbhd Name | B | Tracing | Batch | | | | Appraised Bldg. Value (Card) | 279,300 |
| 0108 | | | COTUIT | | | | | Appraised Xf (B) Value (Bldg) | 66,900 |
| | | | | | | | Appraised Ob (B) Value (Bldg) | 8,500 | |
| | | | | | | | Appraised Land Value (Bldg) | 264,900 | |
| | | | | | | | Special Land Value | 0 | |
| | | | | | | | Total Appraised Parcel Value | 619,600 | |
| | | | | | | | Valuation Method | C | |
| | | | | | | | Total Appraised Parcel Value | 619,600 | |

| NOTES | | | | | | | | | | VISIT / CHANGE HISTORY | | | | | |
|-------|--|--|--|--|--|--|--|--|--|------------------------|----|------|----|----|----------------------------|
| | | | | | | | | | | Date | Id | Type | Is | Cd | Purpost/Result |
| | | | | | | | | | | 05-26-2020 | DM | | | FR | Field Review |
| | | | | | | | | | | 07-07-2017 | SR | 02 | | 02 | Bldg Permit Completed |
| | | | | | | | | | | 10-18-2013 | RB | 03 | | 16 | In Office Review |
| | | | | | | | | | | 08-26-2013 | RB | 03 | | 03 | Cycl Insp Comp |
| | | | | | | | | | | 03-07-2005 | PT | 01 | | 00 | Meas/Listed-Interior Acces |
| | | | | | | | | | | 10-23-2003 | MF | 02 | | 02 | Bldg Permit Completed |
| | | | | | | | | | | 09-04-2002 | PT | 01 | | 00 | Meas/Listed-Interior Acces |

| BUILDING PERMIT RECORD | | | | | | | | | | LAND LINE VALUATION SECTION | | | | | |
|------------------------|------------|------|--------------|--------|------------|--------|------------|-------------------------|--|-----------------------------|----|------|----|----|----------------------------|
| Permit Id | Issue Date | Type | Description | Amount | Insp Date | % Comp | Date Comp | Comments | | Date | Id | Type | Is | Cd | Purpost/Result |
| 16-538 | 09-21-2016 | 804 | Addn Alt-Res | 3,000 | 06-09-2017 | 100 | 06-30-2017 | Enclose Porch | | 05-26-2020 | DM | | | FR | Field Review |
| 201408182 | 01-29-2015 | RE | Remodel | 3,000 | 06-09-2017 | 100 | 06-30-2017 | ROOF ON PORCH OF EXISTI | | 07-07-2017 | SR | 02 | | 02 | Bldg Permit Completed |
| 201202733 | 05-10-2012 | WR | Withdrawn | 3,000 | 05-10-2018 | 100 | 06-30-2018 | SCREEN PORCH ON EXIST | | 10-18-2013 | RB | 03 | | 16 | In Office Review |
| 200903764 | 08-13-2009 | NS | New Siding | 1,100 | 06-30-2010 | 100 | 06-30-2010 | RESIDE | | 08-26-2013 | RB | 03 | | 03 | Cycl Insp Comp |
| 69754 | 06-26-2003 | AD | Addition | 1,000 | 10-23-2003 | 100 | 01-01-2004 | 6 X 45 PORCH-FRNT | | 03-07-2005 | PT | 01 | | 00 | Meas/Listed-Interior Acces |
| 17001 | 08-01-1996 | AD | Addition | 300 | 07-15-1997 | 100 | 01-01-1997 | 8 X 11 SHED | | 10-23-2003 | MF | 02 | | 02 | Bldg Permit Completed |
| B35830 | 05-01-1993 | WD | Wood Deck | 3,000 | 01-15-1994 | 100 | 06-30-1994 | CO DECK | | 09-04-2002 | PT | 01 | | 00 | Meas/Listed-Interior Acces |

| B | Use Code | Description | Zone | LA | Land Units | Unit Price | Size Adj | AC Disc | Site Index | Cond. | Nbhd. | Nbhd. Adj | Notes | Location Adjustmen | Adj Unit P | Land Value | |
|-----------------------|----------|----------------|------|----|------------|------------|------------------------|---------|------------|-------|-------|-----------|------------------|--------------------|------------|------------|---------|
| 1 | 1010 | Single Fam M-0 | RF | 2 | 0.460 | AC | 176,344.00 | 1.92125 | 1.0000 | 5 | 1.00 | 0108 | 1.700 | | 1.0000 | 575,957.1 | 264,900 |
| Total Card Land Units | | | | | 0.46 | AC | Parcel Total Land Area | | | | | 0.46 | Total Land Value | | | 264,900 | |

| CONSTRUCTION DETAIL | | | CONSTRUCTION DETAIL (CONTINUED) | | |
|---------------------|----|----------------|---------------------------------|----|-------------|
| Element | Cd | Description | Element | Cd | Description |
| Style | 01 | Ranch | | | |
| Model | 01 | Residential | | | |
| Grade: | C | Average | | | |
| Stories | 1 | 1 Story | | | |
| Exterior Wall 1 | 14 | Wood Shingle | | | |
| Exterior Wall 2 | | | | | |
| Roof Structure | 03 | Gable/Hip | | | |
| Roof Cover | 03 | Asph/F Gls/Cmp | | | |
| Interior Wall 1 | 05 | Drywall | | | |
| Interior Wall 2 | | | | | |
| Interior Floor 1 | 12 | Hardwood | | | |
| Interior Floor 2 | | | | | |
| Heat Fuel | 02 | Oil | | | |
| Heat Type | 05 | Hot Water | | | |
| AC Type | 01 | None | | | |
| Bedrooms | 03 | 3 Bedrooms | | | |
| Full Baths | 2 | | | | |
| Half Baths | 0 | | | | |
| Extra Fixtures | | | | | |
| Total Rooms | 5 | 5 Rooms | | | |
| Bath Style | | | | | |
| Kitchen Style | | | | | |
| Occupancy | | | | | |
| Usrflid 105 | | | | | |
| Accessory Apt | | | | | |
| Foundation Alt | 01 | Poured Conc. | | | |
| Rms Prts | | | | | |
| Bath Split | 20 | 2 Full-0 Half | | | |

| CONDO DATA | | | |
|-------------|------|-------------|---------|
| Parcel Id | C | B | S |
| Adjust Type | Code | Description | Factor% |
| | | | |
| Condo Flr | | | |
| Condo Unit | | | |

| COST / MARKET VALUATION | |
|--------------------------|---------|
| Building Value New | 353,493 |
| Year Built | 1973 |
| Effective Year Built | 1992 |
| Depreciation Code | A |
| Remodel Rating | |
| Year Remodeled | |
| Depreciation % | 21 |
| Functional Obsol | 0 |
| External Obsol | 0 |
| Trend Factor | 1 |
| Condition | |
| Condition % | |
| Percent Good | 79 |
| RCNLD | 279,300 |
| Dep % Ovr | |
| Dep Ovr Comment | |
| Misc Imp Ovr | |
| Misc Imp Ovr Comment | |
| Cost to Cure Ovr | |
| Cost to Cure Ovr Comment | |

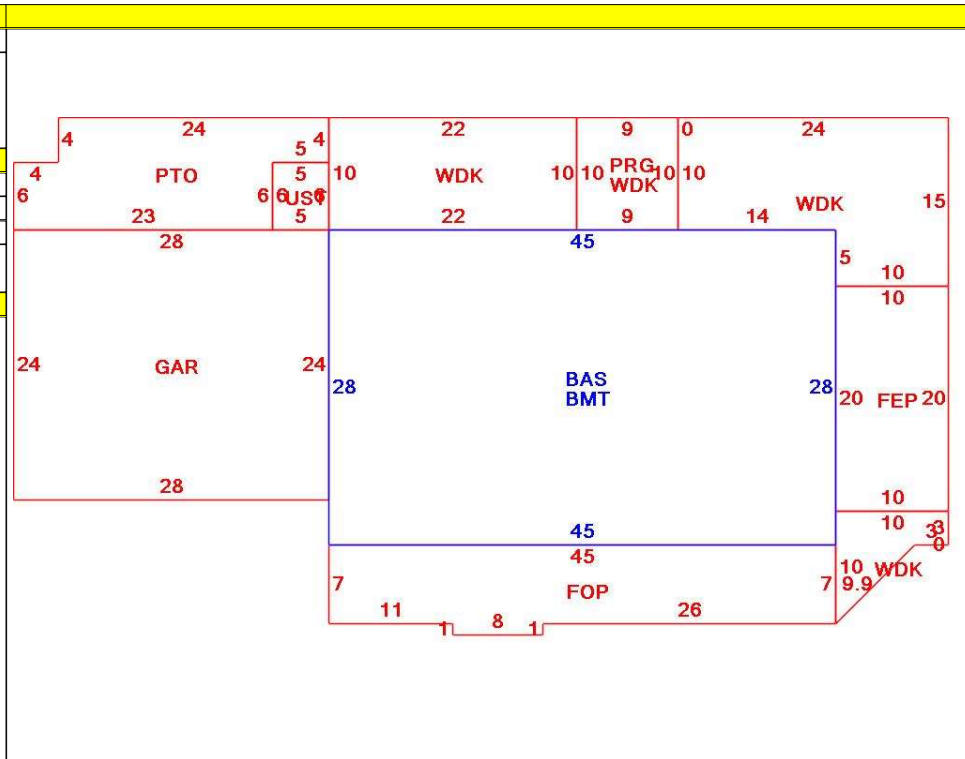

OB - OUTBUILDING & YARD ITEMS(L) / XF - BUILDING EXTRA FEATURES(B)

| Code | Description | L/B | Units | Unit Price | Yr Blt | Cond. Cd | % Gd | Grade | Grade Adj. | Appr. Value |
|------|------------------|-----|-------|------------|--------|----------|------|-------|------------|-------------|
| FPL1 | Fireplace 1 sto | B | 1 | 5000.00 | 1994 | | 79 | | 0.00 | 4,000 |
| WDC | Wood Decking | L | 654 | 20.00 | 1996 | | 54 | | 0.00 | 6,500 |
| FOP | Open Porch-ro | B | 323 | 55.00 | 1994 | | 79 | | 0.00 | 10,000 |
| GAR | Attached Gara | B | 672 | 40.00 | 1994 | | 79 | | 0.00 | 18,000 |
| BMT | Basement-Unfi | B | 1,260 | 26.01 | 1994 | | 79 | | 0.00 | 24,600 |
| PAT1 | Patio- Average | L | 234 | 5.89 | 1996 | | 77 | | 0.00 | 1,100 |
| PRG1 | Pergola-Avg | L | 90 | 18.00 | 1996 | | 54 | C | 1.00 | 900 |
| UST | Utility Storage- | B | 30 | 17.11 | 1994 | | 79 | | 0.00 | 400 |
| FEP | Enclosed porc | B | 200 | 70.00 | 1994 | | 79 | | 0.00 | 9,900 |

BUILDING SUB-AREA SUMMARY SECTION

| Code | Description | Living Area | Floor Area | Eff Area | Unit Cost | Undeprec Value |
|----------------------------|-------------------|-------------|------------|----------|-----------|----------------|
| BAS | First Floor | 1,260 | 1,260 | 1,260 | 280.55 | 353,493 |
| BMT | Basement Area | 0 | 1,260 | 0 | 0.00 | 0 |
| FEP | Enclosed Porch | 0 | 200 | 0 | 0.00 | 0 |
| FOP | Open Porch | 0 | 323 | 0 | 0.00 | 0 |
| GAR | Attached Garage | 0 | 672 | 0 | 0.00 | 0 |
| PRG | Pergola | 0 | 90 | 0 | 0.00 | 0 |
| PTO | Patio | 0 | 234 | 0 | 0.00 | 0 |
| UST | Utility Enclosure | 0 | 30 | 0 | 0.00 | 0 |
| WDK | Wood Deck | 0 | 655 | 0 | 0.00 | 0 |
| Ttl Gross Liv / Lease Area | | 1,260 | 4,724 | 1,260 | | 353,493 |

