

CONSTRUCTION DETAIL			CONSTRUCTION DETAIL (CONTINUED)		
Element	Cd	Description	Element	Cd	Description
Style	04	Cape Cod			
Model	01	Residential			
Grade:	C	Average			
Stories	1.66				
Exterior Wall 1	11	Clapboard			
Exterior Wall 2	14	Wood Shingle			
Roof Structure	03	Gable/Hip			
Roof Cover	03	Asph/F Gls/Cmp			
Interior Wall 1	05	Drywall			
Interior Wall 2					
Interior Floor 1	12	Hardwood			
Interior Floor 2	14	Carpet			
Heat Fuel	03	Gas			
Heat Type	04	Hot Air			
AC Type	03	Central			
Bedrooms	03	3 Bedrooms			
Full Baths	2				
Half Baths	1				
Extra Fixtures					
Total Rooms	5				
Bath Style					
Kitchen Style					
Occupancy					
Usrflid 105					
Accessory Apt					
Foundation Alt	01	Poured Conc.			
Rms Prts					
Bath Split	21	2 Full-1 Half			

CONDO DATA				
Parcel Id		C	Owne	0.0
Adjust Type	Code	Description	Factor%	
Condo Flr				
Condo Unit				

COST / MARKET VALUATION	
Building Value New	434,881
Year Built	2014
Effective Year Built	2013
Depreciation Code	A
Remodel Rating	
Year Remodeled	
Depreciation %	5
Functional Obsol	0
External Obsol	0
Trend Factor	1
Condition	
Condition %	
Percent Good	95
RCNLD	413,100
Dep % Ovr	
Dep Ovr Comment	
Misc Imp Ovr	
Misc Imp Ovr Comment	
Cost to Cure Ovr	
Cost to Cure Ovr Comment	

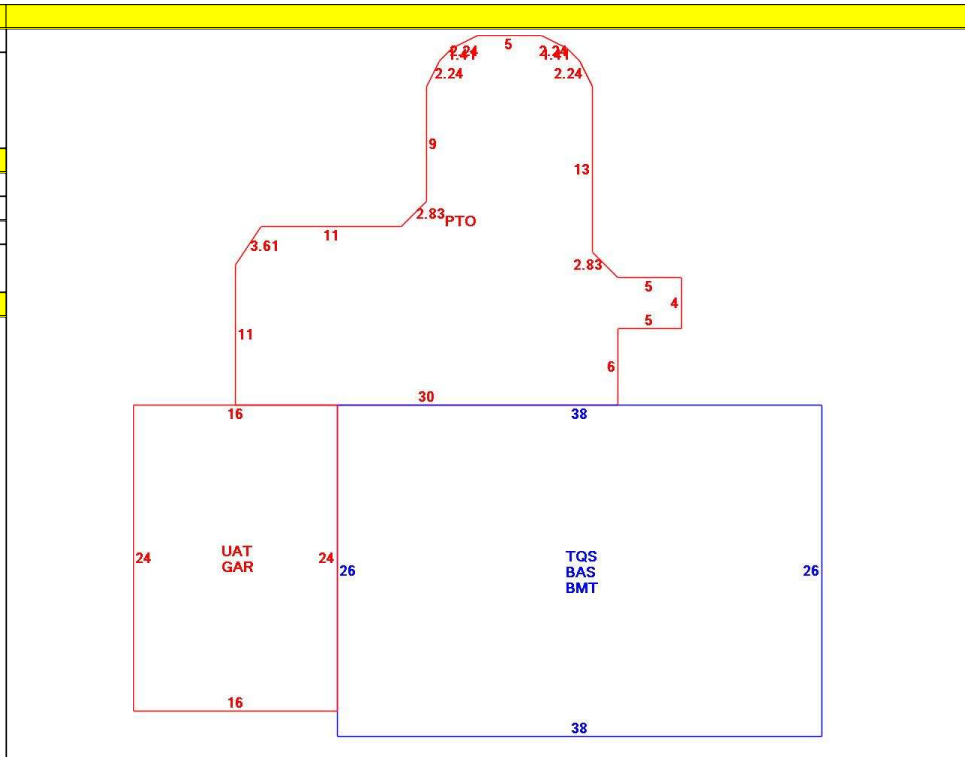

OB - OUTBUILDING & YARD ITEMS(L) / XF - BUILDING EXTRA FEATURES(B)										
Code	Description	L/B	Units	Unit Price	Yr Blt	Cond. Cd	% Gd	Grade	Grade Adj.	Appr. Value
BMT	Basement-Unfi	B	988	26.01	2016		95		0.00	25,000
GAR	Attached Gara	B	384	40.00	2016		95		0.00	14,900
PAT1	Patio- Average	L	617	5.89	2014		95		0.00	3,300
BFA	Bsmt Fin-Avg	B	432	17.36	2016		100		0.00	7,500

BUILDING SUB-AREA SUMMARY SECTION						
Code	Description	Living Area	Floor Area	Eff Area	Unit Cost	Undeprec Value
BAS	First Floor	988	988	988	260.72	257,591
BMT	Basement Area	0	988	0	0.00	0
GAR	Attached Garage	0	384	0	0.00	0
PTO	Patio	0	617	0	0.00	0
TQS	Three Quarter Story	642	988	642	169.42	167,382
UAT	Attic, Unfinished	0	384	38	25.80	9,907
Ttl Gross Liv / Lease Area		1,630	4,349	1,668		434,880

