

| CURRENT OWNER | | TOPO | | UTILITIES | | STRT / ROAD | | LOCATION | | CURRENT ASSESSMENT | | | | 801 FY2025 BARNSTABLE, MA VISION | | | | | | | | | | |
|---|------------|------------------|----------------|-------------------|--------------|-------------|------------------------|--------------------------------|------------|--------------------------------------|-------|---|------------------|--|----|--------------------------------|----------------------------|--------------------|--------------------|------|----------|-------|------|----------|
| MCMAHON, ROBERT P & CAROL 9213 RIDGE BLVD BROOKLYN NY 11209 | | 1 | Level | 2 | Public Water | 1 | Paved | | | Description | Code | Assessed | Assessed | | | RESIDNTL RES LAND | 1010 1010 | 520,100 208,600 | 520,100 208,600 | | | | | |
| | | 4 | Gas | | | | | | | | | | | | | | | | | | | | | |
| | | 6 | Septic | | | | | 3 | | | | | | | | | | | | | | | | |
| SUPPLEMENTAL DATA | | | | | | | | | | Total | | 728,700 | 728,700 | | | | | | | | | | | |
| Alt Prcl ID | | Split Zonin | | Plan Ref. | | Land Ct# | | 76/1 | | | | | | | | | | | | | | | | |
| BID Parcel | | ResExpt Q | | #SR | | Life Estate | | PP STATU | | | | | | | | | | | | | | | | |
| #DL 1 | | #DL 2 | | Assoc Pid# | | | | | | | | | | | | | | | | | | | | |
| GIS ID | | F_976282_2697114 | | | | | | | | | | | | | | | | | | | | | | |
| RECORD OF OWNERSHIP | | | | BK-VOL/PAGE | | SALE DATE | | Q/U | | V/I | | SALE PRIC | | VC | | PREVIOUS ASSESSMENTS (HISTORY) | | | | | | | | |
| MCMAHON, ROBERT P & CAROL | | | | 1433 | 0674 | 04-16-1969 | | U | V | | | 0 | | | | Year | Code | Assessed | Year | Code | Assessed | Year | Code | Assessed |
| | | | | | | | | | | | | | | | | 2025 | 1010 | 520,100 | 2024 | 1010 | 485,600 | 2023 | 1010 | 434,500 |
| | | | | | | | | | | | | | | | | | 1010 | 208,600 | | 1010 | 208,600 | | 1010 | 189,600 |
| | | | | | | | | | | | | | | | | Total | | 728,700 | Total | | 694,200 | Total | | 624,100 |
| EXEMPTIONS | | | | OTHER ASSESSMENTS | | | | | | | | This signature acknowledges a visit by a Data Collector or Assessor | | | | | | | | | | | | |
| Year | Code | Description | | Amount | | Code | Description | | Number | Amount | | Comm Int | | | | | | | | | | | | |
| | | | | | | | | | | | | | | | | | | | | | | | | |
| | | | | Total | | 0.00 | | | | | | | | | | | | | | | | | | |
| ASSESSING NEIGHBORHOOD | | | | | | | | | | | | APPRAISED VALUE SUMMARY | | | | | | | | | | | | |
| Nbhd | | Nbhd Name | | B | | Tracing | | Batch | | Appraised Bldg. Value (Card) 480,400 | | | | | | | | | | | | | | |
| 0107 | | | | | | | | CENVIL | | Appraised Xf (B) Value (Bldg) 35,800 | | | | | | | | | | | | | | |
| | | | | | | | | | | | | Appraised Ob (B) Value (Bldg) 3,900 | | | | | | | | | | | | |
| | | | | | | | | | | | | Appraised Land Value (Bldg) 208,600 | | | | | | | | | | | | |
| | | | | | | | | | | | | Special Land Value 0 | | | | | | | | | | | | |
| | | | | | | | | | | | | Total Appraised Parcel Value 728,700 | | | | | | | | | | | | |
| | | | | | | | | | | | | Valuation Method C | | | | | | | | | | | | |
| | | | | | | | | | | | | Total Appraised Parcel Value 728,700 | | | | | | | | | | | | |
| BUILDING PERMIT RECORD | | | | | | | | | | | | VISIT / CHANGE HISTORY | | | | | | | | | | | | |
| Permit Id | Issue Date | Type | Description | Amount | Insp Date | % Comp | Date Comp | Comments | | | | Date | Id | Type | Is | Cd | Purpost/Result | | | | | | | |
| EXPR-22-1 | 09-22-2022 | 835 | Sid/Wind/Roof/ | 5,000 | | 100 | | Residential weatherization/air | | | | 10-08-2020 | CK | 03 | | 16 | In Office Review | | | | | | | |
| 90386 | 02-17-2006 | RE | Remodel | 150,000 | 03-28-2007 | 100 | 06-30-2007 | DEMO & RECONSTRUCT FR | | | | 05-18-2020 | WD | | | FR | Field Review | | | | | | | |
| B35037 | 05-01-1992 | AD | Addition | 35,000 | 01-15-1993 | 100 | | HP ADD'N | | | | 02-08-2018 | SR | 02 | | 03 | Cycl Insp Comp | | | | | | | |
| | | | | | | | | | | | | 12-03-2009 | PT | 04 | | 44 | Drive by inspection only | | | | | | | |
| | | | | | | | | | | | | 07-25-2007 | JG | 03 | | 52 | New Construction | | | | | | | |
| | | | | | | | | | | | | 03-28-2007 | MF | 01 | | 00 | Meas/Listed-Interior Acces | | | | | | | |
| | | | | | | | | | | | | 12-28-2001 | PT | 01 | | 00 | Meas/Listed-Interior Acces | | | | | | | |
| LAND LINE VALUATION SECTION | | | | | | | | | | | | | | | | | | | | | | | | |
| B | Use Code | Description | Zone | LA | Land Units | Unit Price | Size Adj | AC Disc | Site Index | Cond. | Nbhd. | Nbhd. Adj | Notes | | | Location Adjustmen | Adj Unit P | Land Value | | | | | | |
| 1 | 1010 | Single Fam M-0 | RB | 3 | 0.250 | AC | 176,344.00 | 3.37919 | 1.0000 | 5 | 1.00 | 0107 | 1.400 | | | | 1.0000 | 834,265.8 | 208,600 | | | | | |
| Total Card Land Units | | | | | 0.25 | AC | Parcel Total Land Area | | | | | 0.25 | Total Land Value | | | | | 208,600 | | | | | | |

| CONSTRUCTION DETAIL | | | CONSTRUCTION DETAIL (CONTINUED) | | |
|--------------------------|------|----------------|---------------------------------|-----|-------------|
| Element | Cd | Description | Element | Cd | Description |
| Style | 04 | Cape Cod | | | |
| Model | 01 | Residential | | | |
| Grade: | C | Average | | | |
| Stories | 1.4 | | | | |
| Exterior Wall 1 | 25 | Vinyl Siding | | | |
| Exterior Wall 2 | | | | | |
| RooF Structure | 03 | Gable/Hip | | | |
| RooF Cover | 03 | Asph/F Gls/Cmp | | | |
| Interior Wall 1 | 05 | Drywall | | | |
| Interior Wall 2 | | | | | |
| Interior Floor 1 | 12 | Hardwood | | | |
| Interior Floor 2 | | | | | |
| Heat Fuel | 03 | Gas | | | |
| Heat Type | 05 | Hot Water | | | |
| AC Type | 03 | Central | | | |
| Bedrooms | 03 | 3 Bedrooms | | | |
| Full Baths | 2 | | | | |
| Half Baths | 0 | | | | |
| Extra Fixtures | | | | | |
| Total Rooms | 6 | 6 Rooms | | | |
| Bath Style | | | | | |
| Kitchen Style | | | | | |
| Occupancy | | | | | |
| Sewer Occupan | | | | | |
| Accessory Apt | | | | | |
| Foundation Alt | 08 | Mixed | | | |
| Rms Prts | | | | | |
| Bath Split | 20 | 2 Full-0 Half | | | |
| CONDO DATA | | | COST / MARKET VALUATION | | |
| Parcel Id | | C | Owne | 0.0 | |
| Adjust Type | Code | Description | Factor% | | |
| Condo Flr | | | | | |
| Condo Unit | | | | | |
| Building Value New | | | 593,148 | | |
| Year Built | | | 1959 | | |
| Effective Year Built | | | 1999 | | |
| Depreciation Code | | | VG | | |
| Remodel Rating | | | | | |
| Year Remodeled | | | | | |
| Depreciation % | | | 19 | | |
| Functional Obsol | | | 0 | | |
| External Obsol | | | 0 | | |
| Trend Factor | | | 1 | | |
| Condition | | | | | |
| Condition % | | | | | |
| Percent Good | | | 81 | | |
| RCNLD | | | 480,400 | | |
| Dep % Ovr | | | | | |
| Dep Ovr Comment | | | | | |
| Misc Imp Ovr | | | | | |
| Misc Imp Ovr Comment | | | | | |
| Cost to Cure Ovr | | | | | |
| Cost to Cure Ovr Comment | | | | | |

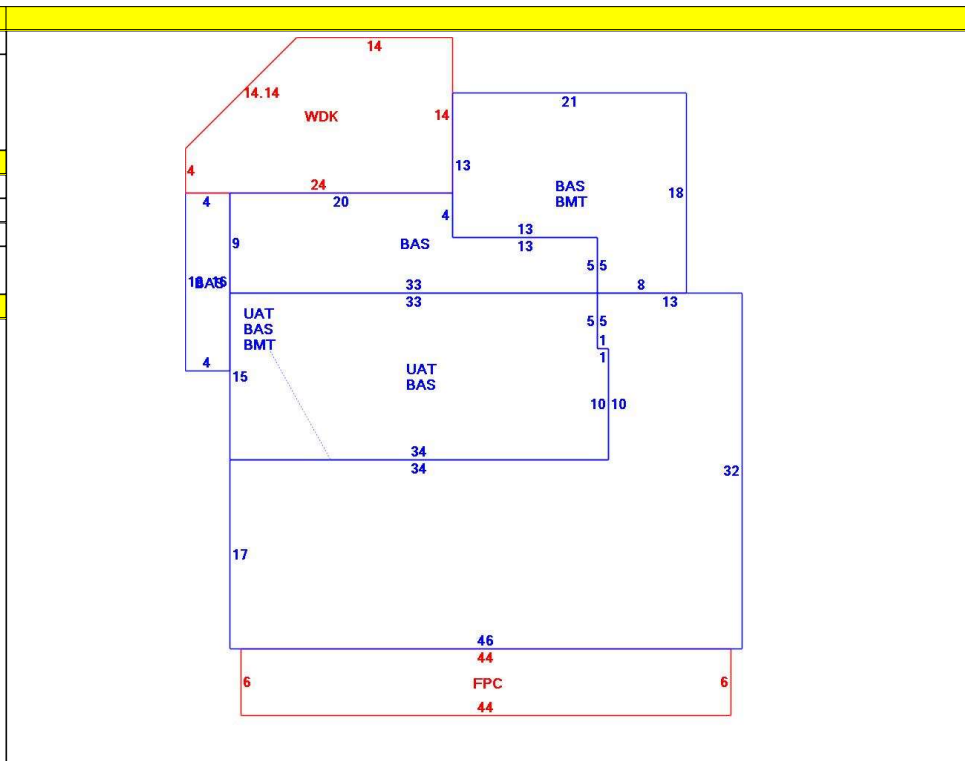

| OB - OUTBUILDING & YARD ITEMS(L) / XF - BUILDING EXTRA FEATURES(B) | | | | | | | | | | |
|--|---------------|-----|-------|------------|--------|----------|------|-------|------------|-------------|
| Code | Description | L/B | Units | Unit Price | Yr Blt | Cond. Cd | % Gd | Grade | Grade Adj. | Appr. Value |
| FPLG | Gas Fireplace | B | 1 | 2500.00 | 1997 | | 81 | | 0.00 | 2,000 |
| WDC | Wood Decking | L | 286 | 20.00 | 2002 | | 66 | | 0.00 | 3,900 |
| FOPC | Open Prch-roo | B | 264 | 55.00 | 1997 | | 81 | | 0.00 | 8,300 |
| BMT | Basement-Unfi | B | 1,280 | 26.01 | 1997 | | 81 | | 0.00 | 25,500 |

| BUILDING SUB-AREA SUMMARY SECTION | | | | | | |
|-----------------------------------|------------------------|--------------|--------------|--------------|-----------|----------------|
| Code | Description | Living Area | Floor Area | Eff Area | Unit Cost | Undeprec Value |
| BAS | First Floor | 2,094 | 2,094 | 2,094 | 264.68 | 554,240 |
| BMT | Basement Area | 0 | 1,280 | 0 | 0.00 | 0 |
| FPC | Open Porch Conc. Floor | 0 | 264 | 0 | 0.00 | 0 |
| UAT | Attic, Unfinished | 0 | 1,472 | 147 | 26.43 | 38,908 |
| WDK | Wood Deck | 0 | 286 | 0 | 0.00 | 0 |
| Ttl Gross Liv / Lease Area | | 2,094 | 5,396 | 2,241 | | 593,148 |

