

| CURRENT OWNER  |  | TOPO |        | UTILITIES |  | STRT / ROAD |       | LOCATION |  | CURRENT ASSESSMENT |      |          |          |
|--|--|------|--------|-----------|--|-------------|-------|----------|--|--------------------|------|----------|----------|
| VERDI, MELISSA L<br><br>42 SILVER LANE<br><br>HYANNIS MA 02601   |  | 1    | Level  | 2         | Public Water   | 1           | Paved |          |  | Description        | Code | Assessed | Assessed |
|  |  | 4    | Gas    |           |  |             |       |          |  | RESIDNTL           | 1010 | 368,800  | 368,800  |
|  |  | 6    | Septic |           |  |             |       | 4        |  | RES LAND           | 1010 | 149,600  | 149,600  |
| <b>SUPPLEMENTAL DATA</b>   |  |      |        |           |  |             |       |          |  |                    |      |          |          |
| Alt Prcl ID<br>Split Zonin<br>BID Parcel<br>ResExpt Q YES:<br>#DL 1 LOT 19<br>#DL 2<br>GIS ID F_982184_2697987 |  |      |        |           | Plan Ref. 213/85<br>Land Ct#<br>#SR<br>Life Estate<br>PP STATU<br>Assoc Pid# |             |       |          |  | Total              |      | 518,400  | 518,400  |

801  
 FY2025  
 BARNSTABLE, MA  
**VISION**

| RECORD OF OWNERSHIP                |  | BK-VOL/PAGE |      | SALE DATE  |  | Q/U |   | V/I     |  | SALE PRIC |  | VC      |       | PREVIOUS ASSESSMENTS (HISTORY) |       |         |          |      |      |          |
|------------------------------------|--|-------------|------|------------|--|-----|---|---------|--|-----------|--|---------|-------|--------------------------------|-------|---------|----------|------|------|----------|
| VERDI, MELISSA L                   |  | 33253       | 0123 | 09-14-2020 |  | U   | I | 325,000 |  | 1         |  | Year    | Code  | Assessed                       | Year  | Code    | Assessed | Year | Code | Assessed |
| DELIO, ANGELO V & MARY L TRS       |  | 15153       | 0345 | 05-14-2002 |  | U   | I | 10      |  | 1F        |  | 2025    | 1010  | 368,800                        | 2024  | 1010    | 361,000  | 2023 | 1010 | 310,100  |
| DELIO, ANGELO V & LOUISE           |  | 10003       | 0026 | 01-15-1996 |  | Q   | I | 85,000  |  | 00        |  |         | 1010  | 149,600                        |       | 1010    | 149,600  |      | 1010 | 136,000  |
| BRADSHAW, HELEN A                  |  | 10003       | 0024 | 01-15-1996 |  | U   | I | 1       |  | 1A        |  |         |       |                                |       |         |          |      |      |          |
| SULLIVAN, LILLIAN & BRADSHAW, HELE |  | 7524        | 0209 | 05-15-1991 |  | U   | I | 1       |  | 1A        |  |         |       |                                |       |         |          |      |      |          |
| Total                              |  |             |      |            |  |     |   |         |  |           |  | 518,400 | Total | 510,600                        | Total | 446,100 |          |      |      |          |

| EXEMPTIONS |      |                       |        | OTHER ASSESSMENTS |             |        |        |
|------------|------|-----------------------|--------|-------------------|-------------|--------|--------|
| Year       | Code | Description           | Amount | Code              | Description | Number | Amount |
| 2022       | 5C   | RESIDENTIAL EXEMPTION |        |                   |             |        |        |
| Total      |      |                       | 0.00   |                   |             |        |        |

This signature acknowledges a visit by a Data Collector or Assessor

| ASSESSING NEIGHBORHOOD |           |   |            |
|------------------------|-----------|---|------------|
| Nbhd                   | Nbhd Name | B | Tracing    |
| 0105                   |           |   | Batch HYAN |

| NOTES |  |  |  |
|-------|--|--|--|
|       |  |  |  |

| APPRAISED VALUE SUMMARY       |         |
|-------------------------------|---------|
| Appraised Bldg. Value (Card)  | 327,400 |
| Appraised Xf (B) Value (Bldg) | 39,700  |
| Appraised Ob (B) Value (Bldg) | 1,700   |
| Appraised Land Value (Bldg)   | 149,600 |
| Special Land Value            | 0       |
| Total Appraised Parcel Value  | 518,400 |
| Valuation Method              | C       |
| Total Appraised Parcel Value  | 518,400 |

| BUILDING PERMIT RECORD |            |      |                |        |            |        |            |                        |  | VISIT / CHANGE HISTORY |    |      |    |    |                       |
|------------------------|------------|------|----------------|--------|------------|--------|------------|------------------------|--|------------------------|----|------|----|----|-----------------------|
| Permit Id              | Issue Date | Type | Description    | Amount | Insp Date  | % Comp | Date Comp  | Comments               |  | Date                   | Id | Type | Is | Cd | Purpost/Result        |
| EXPR-22-1              | 11-30-2022 | 835  | Sid/Wind/Roof/ | 4,872  |            | 100    |            | 3 sq of rolled asphalt |  | 08-23-2021             | BM | 03   |    | 16 | In Office Review      |
| 17-4038                | 11-20-2017 | 835  | Sid/Wind/Roof/ | 1,800  |            | 100    |            | reside - yarmouth      |  | 08-10-2021             | LH | 03   |    | 16 | In Office Review      |
| 63755                  | 09-13-2002 | RE   | Remodel        | 8,000  | 02-25-2003 | 100    | 01-01-2003 |                        |  | 08-10-2021             | LH | 03   |    | 22 | Change of Address     |
|                        |            |      |                |        |            |        |            |                        |  | 05-22-2020             | WD |      |    | FR | Field Review          |
|                        |            |      |                |        |            |        |            |                        |  | 01-09-2015             | SR | 02   |    | 14 | Cyclical Inspection   |
|                        |            |      |                |        |            |        |            |                        |  | 09-01-2010             | PT | 02   |    | 14 | Cyclical Inspection   |
|                        |            |      |                |        |            |        |            |                        |  | 02-25-2003             | MF | 02   |    | 02 | Bldg Permit Completed |

| LAND LINE VALUATION SECTION |          |                |      |    |            |            |                        |         |            |       |       |           |                  |                    |            |            |         |         |
|-----------------------------|----------|----------------|------|----|------------|------------|------------------------|---------|------------|-------|-------|-----------|------------------|--------------------|------------|------------|---------|---------|
| B                           | Use Code | Description    | Zone | LA | Land Units | Unit Price | Size Adj               | AC Disc | Site Index | Cond. | Nbhd. | Nbhd. Adj | Notes            | Location Adjustmen | Adj Unit P | Land Value |         |         |
| 1                           | 1010     | Single Fam M-0 | RB   | 4  | 0.270      | AC         | 176,344.00             | 3.14262 | 1.0000     | 5     | 1.00  | 0105      | 1.000            |                    | 1.0000     | 554,178.6  | 149,600 |         |
| Total Card Land Units       |          |                |      |    | 0.27       | AC         | Parcel Total Land Area |         |            |       |       | 0.27      | Total Land Value |                    |            |            |         | 149,600 |

| CONSTRUCTION DETAIL |    |                | CONSTRUCTION DETAIL (CONTINUED) |    |             |
|---------------------|----|----------------|---------------------------------|----|-------------|
| Element             | Cd | Description    | Element                         | Cd | Description |
| Style               | 01 | Ranch          |                                 |    |             |
| Model               | 01 | Residential    |                                 |    |             |
| Grade:              | C  | Average        |                                 |    |             |
| Stories             | 1  | 1 Story        |                                 |    |             |
| Exterior Wall 1     | 14 | Wood Shingle   |                                 |    |             |
| Exterior Wall 2     |    |                |                                 |    |             |
| RooF Structure      | 03 | Gable/Hip      |                                 |    |             |
| RooF Cover          | 03 | Asph/F Gls/Cmp |                                 |    |             |
| Interior Wall 1     | 05 | Drywall        |                                 |    |             |
| Interior Wall 2     |    |                |                                 |    |             |
| Interior Floor 1    | 12 | Hardwood       |                                 |    |             |
| Interior Floor 2    | 14 | Carpet         |                                 |    |             |
| Heat Fuel           | 03 | Gas            |                                 |    |             |
| Heat Type           | 04 | Hot Air        |                                 |    |             |
| AC Type             | 03 | Central        |                                 |    |             |
| Bedrooms            | 03 | 3 Bedrooms     |                                 |    |             |
| Full Baths          | 1  |                |                                 |    |             |
| Half Baths          | 1  |                |                                 |    |             |
| Extra Fixtures      |    |                |                                 |    |             |
| Total Rooms         | 7  | 7 Rooms        |                                 |    |             |
| Bath Style          |    |                |                                 |    |             |
| Kitchen Style       |    |                |                                 |    |             |
| Occupancy           |    |                |                                 |    |             |
| Sewer Occupan       |    |                |                                 |    |             |
| Accessory Apt       |    |                |                                 |    |             |
| Foundation Alt      | 01 | Poured Conc.   |                                 |    |             |
| Rms Prts            |    |                |                                 |    |             |
| Bath Split          | 11 | 1 Full-1 Half  |                                 |    |             |

| CONDO DATA  |      |             |         |     |
|-------------|------|-------------|---------|-----|
| Parcel Id   |      | C           | Owne    | 0.0 |
| Adjust Type | Code | Description | Factor% |     |
| Condo Flr   |      |             |         |     |
| Condo Unit  |      |             |         |     |

| COST / MARKET VALUATION  |  |         |
|--------------------------|--|---------|
| Building Value New       |  | 425,253 |
| Year Built               |  | 1968    |
| Effective Year Built     |  | 1994    |
| Depreciation Code        |  | A       |
| Remodel Rating           |  |         |
| Year Remodeled           |  |         |
| Depreciation %           |  | 23      |
| Functional Obsol         |  | 0       |
| External Obsol           |  | 0       |
| Trend Factor             |  | 1       |
| Condition                |  |         |
| Condition %              |  |         |
| Percent Good             |  | 77      |
| RCNLD                    |  | 327,400 |
| Dep % Ovr                |  |         |
| Dep Ovr Comment          |  |         |
| Misc Imp Ovr             |  |         |
| Misc Imp Ovr Comment     |  |         |
| Cost to Cure Ovr         |  |         |
| Cost to Cure Ovr Comment |  |         |

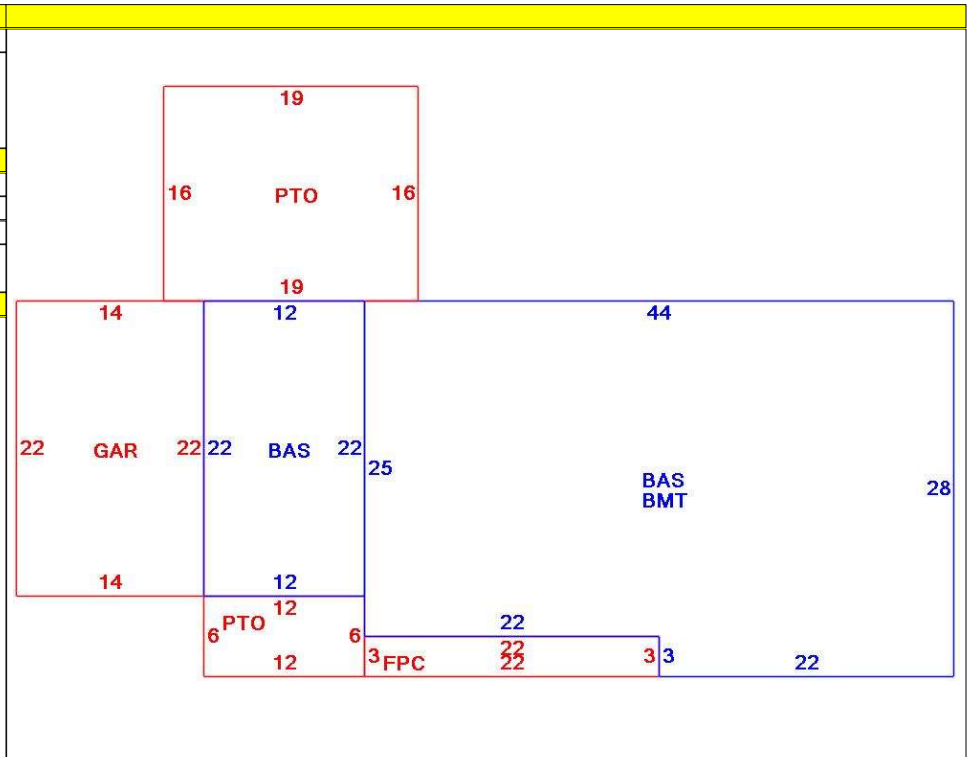

| OB - OUTBUILDING & YARD ITEMS(L) / XF - BUILDING EXTRA FEATURES(B) |                 |     |       |            |        |          |      |       |            |             |
|--|-----------------|-----|-------|------------|--------|----------|------|-------|------------|-------------|
| Code   | Description     | L/B | Units | Unit Price | Yr Blt | Cond. Cd | % Gd | Grade | Grade Adj. | Appr. Value |
| FPL1   | Fireplace 1 sto | B   | 1     | 5000.00    | 1992   |          | 77   |       | 0.00       | 3,900       |
| PAT1   | Patio- Average  | L   | 376   | 5.89       | 1995   |          | 76   |       | 0.00       | 1,700       |
| FOPC   | Open Prch-roo   | B   | 66    | 55.00      | 1992   |          | 77   |       | 0.00       | 2,700       |
| GAR  | Attached Gara   | B   | 308   | 40.00      | 1992   |          | 77   |       | 0.00       | 10,500      |
| BMT  | Basement-Unfi   | B   | 1,166 | 26.01      | 1992   |          | 77   |       | 0.00       | 22,600      |

| BUILDING SUB-AREA SUMMARY SECTION |                        |             |            |          |           |                |
|-----------------------------------|------------------------|-------------|------------|----------|-----------|----------------|
| Code                              | Description            | Living Area | Floor Area | Eff Area | Unit Cost | Undeprec Value |
| BAS                               | First Floor            | 1,430       | 1,430      | 1,430    | 297.38    | 425,253        |
| BMT                               | Basement Area          | 0           | 1,166      | 0        | 0.00      | 0              |
| FPC                               | Open Porch Conc. Floor | 0           | 66         | 0        | 0.00      | 0              |
| GAR                               | Attached Garage        | 0           | 308        | 0        | 0.00      | 0              |
| PTO                               | Patio                  | 0           | 376        | 0        | 0.00      | 0              |
| Ttl Gross Liv / Lease Area        |                        | 1,430       | 3,346      | 1,430    |           | 425,253        |

