

| CURRENT OWNER | | TOPO | UTILITIES | STRT / ROAD | LOCATION | CURRENT ASSESSMENT | | | | 801 FY2025 BARNSTABLE, MA |
|---|--|---------|----------------|---|----------|--------------------|------|-----------|-----------|---------------------------------|
| GROSSIS, MARY TR GROSSIS FAMILY REVOCABLE LIVI 3900 GALT OCEAN DRIVE UNIT 1102 FORT LAUDERD FL 33308 | | 1 Level | 2 Public Water | 1 Paved | | Description | Code | Assessed | Assessed | |
| | | | 4 Gas | | | RESIDNTL | 1010 | 2,040,000 | 2,040,000 | |
| | | | 6 Septic | | | RES LAND | 1010 | 176,300 | 176,300 | |
| SUPPLEMENTAL DATA | | | | | | | | | | |
| Alt Prcl ID Split Zonin BID Parcel ResExpt Q #DL 1 #DL 2 GIS ID F_982987_2697400 | | | | Plan Ref. Land Ct# #SR Life Estate PP STATU Assoc Pid# | | Total | | 2,216,300 | 2,216,300 | VISION |

| RECORD OF OWNERSHIP | | BK-VOL/PAGE | SALE DATE | Q/U | V/I | SALE PRIC | VC | PREVIOUS ASSESSMENTS (HISTORY) | | | | | | | | |
|---------------------|--|-------------|------------|-----|-----|-----------|----|--------------------------------|------|-----------|-------|------|-----------|-------|------|-----------|
| GROSSIS, MARY TR | | 36476 180 | 07-19-2024 | U | I | 10 | 1F | Year | Code | Assessed | Year | Code | Assessed | Year | Code | Assessed |
| GROSSIS, STELIOS | | 20314 0010 | 09-30-2005 | Q | I | 330,000 | 00 | 2025 | 1010 | 2,040,000 | 2024 | 1010 | 1,834,500 | 2023 | 1010 | 1,582,300 |
| SIDDALL, DOROTHY E | | 7012 0178 | 01-15-1990 | U | I | 1 | 1A | | 1010 | 176,300 | | 1010 | 176,300 | | 1010 | 160,300 |
| SIDDALL, DOROTHY E | | 1798 0234 | 01-19-1973 | U | V | 0 | | Total | | 2,216,300 | Total | | 2,010,800 | Total | | 1,742,600 |

| EXEMPTIONS | | | OTHER ASSESSMENTS | | | | | This signature acknowledges a visit by a Data Collector or Assessor | | | | | | | | | | |
|------------|------|-------------|-------------------|------|-------------|--------|--------|---|--|--|--|--|--|--|--|--|--|--|
| Year | Code | Description | Amount | Code | Description | Number | Amount | Comm Int | | | | | | | | | | |
| Total | | | 0.00 | | | | | | | | | | | | | | | |

| ASSESSING NEIGHBORHOOD | | | | | | | | | | APPRAISED VALUE SUMMARY | | | | | | |
|------------------------|-----------|---|---------|-------|-------------------------------|--|--|--|--|-------------------------|-----------|--|--|--|--|--|
| Nbhd | Nbhd Name | B | Tracing | Batch | Appraised Bldg. Value (Card) | | | | | | 1,772,100 | | | | | |
| 0105 | | | | HYAN | Appraised Xf (B) Value (Bldg) | | | | | | 198,100 | | | | | |
| | | | | | Appraised Ob (B) Value (Bldg) | | | | | | 69,800 | | | | | |
| | | | | | Appraised Land Value (Bldg) | | | | | | 176,300 | | | | | |
| | | | | | Special Land Value | | | | | | 0 | | | | | |
| | | | | | Total Appraised Parcel Value | | | | | | 2,216,300 | | | | | |
| | | | | | Valuation Method | | | | | | C | | | | | |
| | | | | | Total Appraised Parcel Value | | | | | | 2,216,300 | | | | | |

| NOTES | | | | | | | | | | VISIT / CHANGE HISTORY | | | | | | |
|-----------|------------|------|----------------|---------|------------|--------|------------|--------------------------|--|------------------------|----|------|----|----|-----------------------|--|
| Permit Id | Issue Date | Type | Description | Amount | Insp Date | % Comp | Date Comp | Comments | | Date | Id | Type | Is | Cd | Purpost/Result | |
| 200904834 | 10-08-2009 | PH | Pool Heater | 0 | 06-29-2010 | 100 | 06-30-2010 | GRILL/POOL HEATER | | 07-22-2024 | AG | 03 | | 16 | In Office Review | |
| 200904436 | 09-30-2009 | SP | Swimming Pool | 20,000 | 06-29-2010 | 100 | 06-30-2013 | 20X46 INGR GUNITE NO DIV | | 05-26-2020 | WD | | | FR | Field Review | |
| 200903013 | 06-30-2009 | FB | Finish Basemen | 70,000 | 06-29-2010 | 100 | 06-30-2010 | EXERCISE RM; MECH RM, B | | 12-01-2014 | MW | 02 | | 02 | Bldg Permit Completed | |
| 200804087 | 08-11-2008 | DW | Dwelling | 165,000 | 07-17-2014 | 100 | 06-30-2015 | 3BD ATT GARW/O STOR OV | | 10-16-2014 | JR | 03 | | 16 | In Office Review | |
| 200803802 | 07-16-2008 | DE | Demolish | 10,500 | 06-30-2009 | 100 | 06-30-2009 | DEMO EXIST DW | | 08-01-2014 | MW | 02 | | 13 | CALL BACK | |
| | | | | | | | | | | 08-19-2013 | RB | 03 | | 13 | CALL BACK | |
| | | | | | | | | | | 05-13-2013 | RB | 03 | | 13 | CALL BACK | |

| LAND LINE VALUATION SECTION | | | | | | | | | | | | | | | | |
|-----------------------------|----------|----------------|------|----|------------|------------|------------------------|---------|------------|-------|-------|-----------|------------------|--------------------|------------|------------|
| B | Use Code | Description | Zone | LA | Land Units | Unit Price | Size Adj | AC Disc | Site Index | Cond. | Nbhd. | Nbhd. Adj | Notes | Location Adjustmen | Adj Unit P | Land Value |
| 1 | 1010 | Single Fam M-0 | RB | 4 | 1.000 | AC | 176,344.00 | 1.00000 | 1.0000 | 5 | 1.00 | 0105 | 1.000 | | 1.0000 | 176,344 |
| Total Card Land Units | | | | | 1.00 | AC | Parcel Total Land Area | | | | | 1.00 | Total Land Value | | | 176,300 |

| CONSTRUCTION DETAIL | | | CONSTRUCTION DETAIL (CONTINUED) | | |
|---------------------|----|----------------|--------------------------------------|----|-------------|
| Element | Cd | Description | Element | Cd | Description |
| Style | 03 | Colonial | | | |
| Model | 01 | Residential | | | |
| Grade: | B+ | Custom Plus | | | |
| Stories | 2 | 2 Stories | | | |
| Exterior Wall 1 | 30 | Cement Clapbd | | | |
| Exterior Wall 2 | | | | | |
| RooF Structure | 03 | Gable/Hip | | | |
| RooF Cover | 03 | Asph/F Gls/Cmp | | | |
| Interior Wall 1 | 05 | Drywall | | | |
| Interior Wall 2 | | | | | |
| Interior Floor 1 | 19 | Marble | | | |
| Interior Floor 2 | | | | | |
| Heat Fuel | 03 | Gas | | | |
| Heat Type | 05 | Hot Water | | | |
| AC Type | 03 | Central | | | |
| Bedrooms | 03 | 3 Bedrooms | | | |
| Full Baths | 4 | | | | |
| Half Baths | 1 | | | | |
| Extra Fixtures | | | | | |
| Total Rooms | 9 | | | | |
| Bath Style | | | | | |
| Kitchen Style | | | | | |
| Occupancy | | | | | |
| Sewer Occupan | | | | | |
| Accessory Apt | | | | | |
| Foundation Alt | 01 | Poured Conc. | | | |
| Rms Prts | | | | | |
| Bath Split | 41 | 4 Full-1 Half | | | |
| | | | CONDO DATA | | |
| | | | Parcel Id | C | Owne 0.0 |
| | | | Adjust Type Code Description Factor% | | |
| | | | Condo Flr | | |
| | | | Condo Unit | | |
| | | | COST / MARKET VALUATION | | |
| | | | Building Value New | | 1,926,239 |
| | | | Year Built | | 2008 |
| | | | Effective Year Built | | 2014 |
| | | | Depreciation Code | | A |
| | | | Remodel Rating | | |
| | | | Year Remodeled | | |
| | | | Depreciation % | | 8 |
| | | | Functional Obsol | | 0 |
| | | | External Obsol | | 0 |
| | | | Trend Factor | | 1 |
| | | | Condition | | |
| | | | Condition % | | |
| | | | Percent Good | | 92 |
| | | | RCNLD | | 1,772,100 |
| | | | Dep % Ovr | | |
| | | | Dep Ovr Comment | | |
| | | | Misc Imp Ovr | | |
| | | | Misc Imp Ovr Comment | | |
| | | | Cost to Cure Ovr | | |
| | | | Cost to Cure Ovr Comment | | |

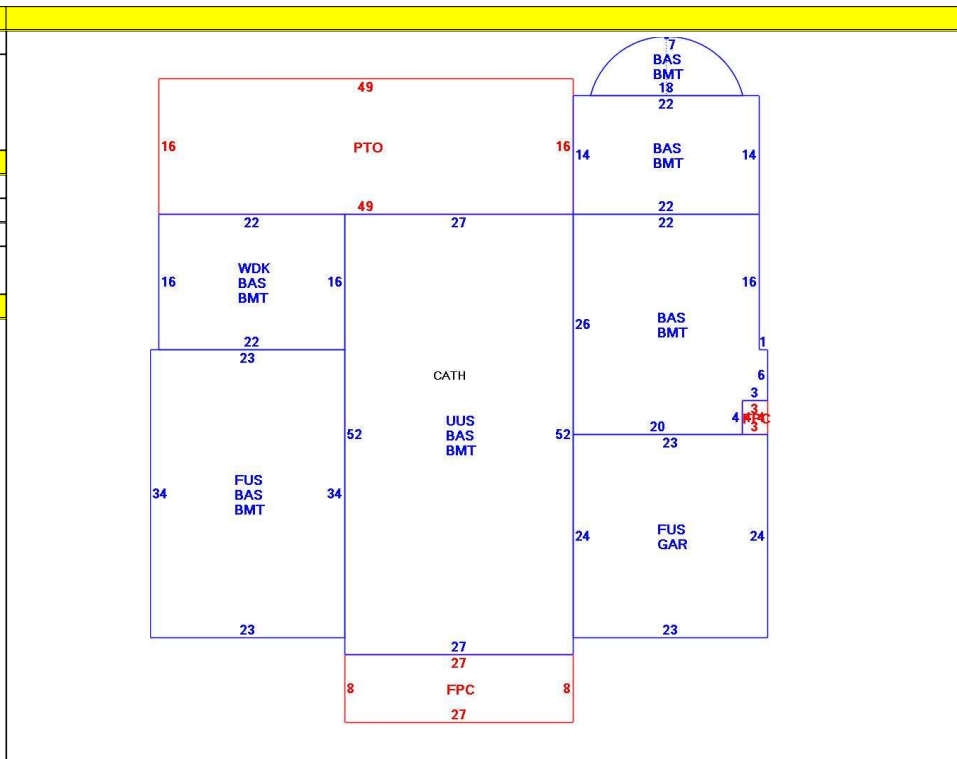

| OB - OUTBUILDING & YARD ITEMS(L) / XF - BUILDING EXTRA FEATURES(B) | | | | | | | | | | |
|--|----------------|-----|-------|------------|--------|----------|------|-------|------------|-------------|
| Code | Description | L/B | Units | Unit Price | Yr Blt | Cond. Cd | % Gd | Grade | Grade Adj. | Appr. Value |
| FPLG | Gas Fireplace- | B | 1 | 2500.00 | 2012 | | 92 | | 0.00 | 2,300 |
| BFA1 | Bsmnt Fin-Goo | B | 3,432 | 32.56 | 2012 | | 92 | | 0.00 | 102,800 |
| WDC | Wood Decking | L | 352 | 20.00 | 2010 | | 82 | | 0.00 | 5,700 |
| PAT2 | Patio-Good | L | 784 | 9.94 | 2010 | | 91 | | 0.00 | 6,600 |
| SPL3 | Pool Gunite | L | 920 | 75.00 | 2009 | | 70 | 00 | 1.00 | 47,100 |
| GAR | Attached Gara | B | 552 | 40.00 | 2012 | | 92 | | 0.00 | 18,300 |
| BMT | Basement-Unfi | B | 3,509 | 26.01 | 2012 | | 92 | | 0.00 | 66,500 |
| SPH3 | Pool Heater 80 | L | 1 | 4116.00 | 2009 | | 80 | | 0.00 | 3,300 |
| FOPC | Open Prch-roo | B | 228 | 55.00 | 2012 | | 92 | | 0.00 | 8,200 |
| PAT1 | Patio- Average | L | 1,580 | 5.89 | 2009 | | 90 | | 0.00 | 7,100 |

| BUILDING SUB-AREA SUMMARY SECTION | | | | | | |
|-----------------------------------|-------------------------|-------------|------------|----------|-----------|----------------|
| Code | Description | Living Area | Floor Area | Eff Area | Unit Cost | Undeprec Value |
| BAS | First Floor | 3,509 | 3,509 | 3,509 | 319.13 | 1,119,810 |
| BMT | Basement Area | 0 | 3,509 | 0 | 0.00 | 0 |
| FPC | Open Porch Conc. Floor | 0 | 228 | 0 | 0.00 | 0 |
| FUS | Upper Story | 1,334 | 1,334 | 1,334 | 319.13 | 425,713 |
| GAR | Attached Garage | 0 | 552 | 0 | 0.00 | 0 |
| PTO | Patio | 0 | 784 | 0 | 0.00 | 0 |
| UUS | Upper Story, Unfinished | 0 | 1,404 | 1,193 | 271.17 | 380,716 |
| WDK | Wood Deck | 0 | 352 | 0 | 0.00 | 0 |
| Ttl Gross Liv / Lease Area | | 4,843 | 11,672 | 6,036 | | 1,926,239 |

